

---

# GROUP 52A

# INTERIOR

## CONTENTS

|   |              |                         |               |
|---|--------------|-------------------------|---------------|
| <b>GENERAL INFORMATION</b> .....                    | <b>52A-2</b> | <b>SEAT BELT</b> .....  | <b>52A-6</b>  |
| <b>INSTRUMENT PANEL AND<br/>FLOOR CONSOLE</b> ..... | <b>52A-3</b> | <b>TRIMS</b> .....      | <b>52A-8</b>  |
| <b>SEAT</b> .....                                   | <b>52A-4</b> | INTERIOR TRIMS .....    | 52A-8         |
| FRONT SEAT .....                                    | 52A-4        | DOOR TRIM .....         | 52A-9         |
| REAR SEAT .....                                     | 52A-5        | <b>HEADLINING</b> ..... | <b>52A-10</b> |

---

**GENERAL INFORMATION**

M2520000101217

Functionality, interior comfort, and safety have been emphasized, giving interior design for elegance and relaxation space. Various measures have been taken to protect the environment and recycle resources.

**FEATURES****Quality improvement**

1. Spartan, black monotone interior
2. Full interior trim

**Usability improvement**

1. Armrest (floor console, rear seat, front door trim <MR>, rear door trim <MR>)
2. Cup holder (floor console, rear seat armrest)
3. Bottle holder (front door trim)

**Convenient storage**

1. Glove box
2. Card holder (glove box)
3. Tissue paper holder (floor console)
4. Floor console box
5. Door pocket (front door trim, rear door trim)

**Safety improvement**

1. Front and rear collision protection seat mechanism (front seat)
2. ISO-FIX lower anchor (rear seat outside)
3. Upper tether anchor (rear shelf)
4. ELR 3-point seat belt (driver's seat)
5. ELR/ALR 3-point seat belt (front passenger, rear)
6. Seat belt retractor with a driver's side pretensioner and force limiter
7. Seat belt retractor with a passenger's side pretensioner and force limiter
8. Headliner energy absorption rib <Vehicles without curtain air bag>

**Consideration for the optimum driving position**

1. Seat slide adjustment (front)
2. Reclining adjustment (front)

**Measures for resource recycling**

1. Aggressively use PP materials that are easy to recycle and easy to stamp material symbols on the plastic (resin) parts.
2. Reduction of chemical material (formaldehyde\*, organic solvent)

*NOTE: \*: Clear and colourless, toxic, irritating odour*

# INSTRUMENT PANEL AND FLOOR CONSOLE

M2520001000964

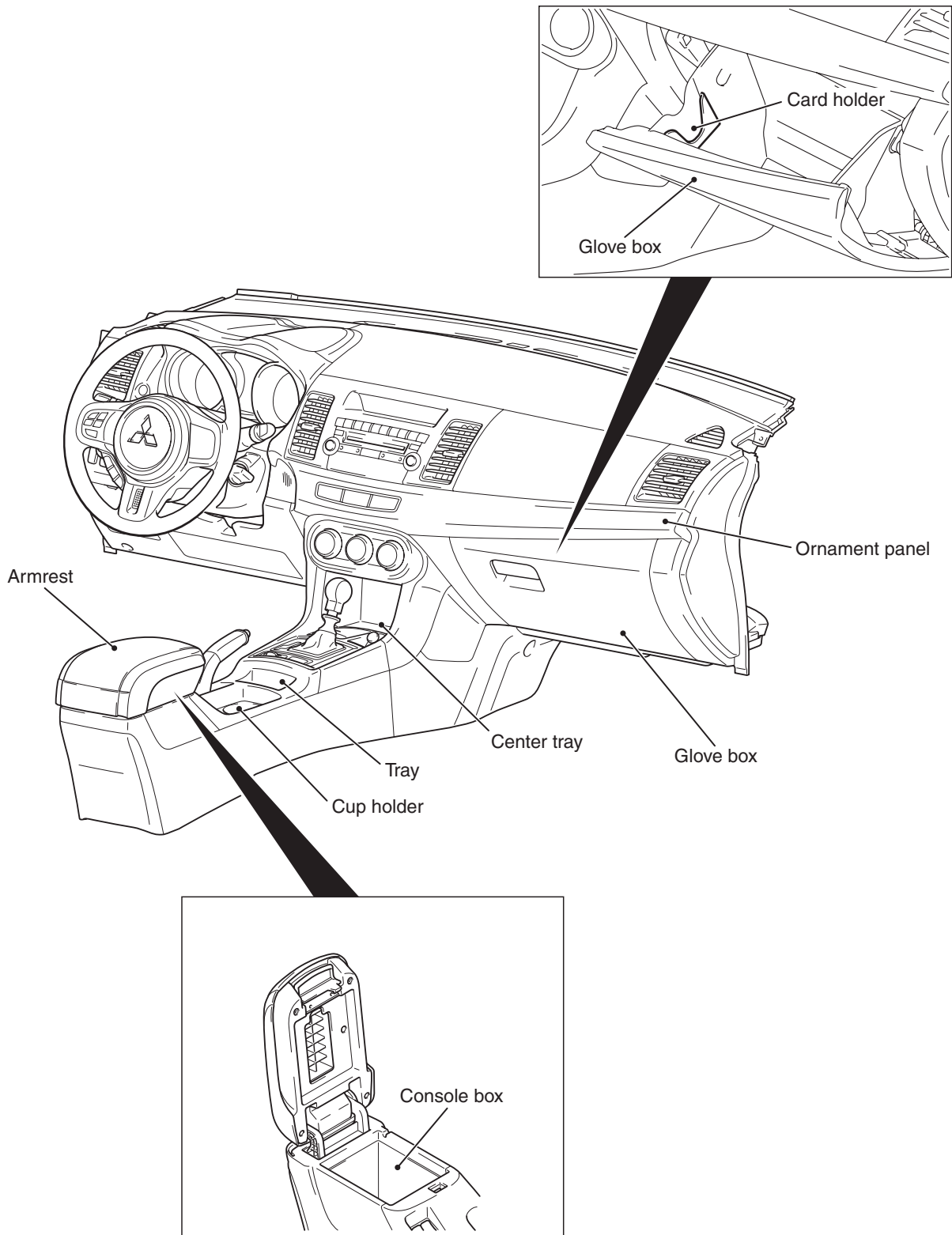

AC708443AB

The instrument panel and the floor console have the following features.

- The instrument panel is two-toned.
- The division unit of each part has been enlarged, also the gap and level difference between the instrument panel has been minimized to achieve the delicate quality.

- The decorated panel creating uniformity from the instrument panel to the door trim has been adopted.
- The holder in which two cards can be stored has been installed in the glove box.
- The glove box with damper function has been installed.
- The center tray for storing small items has been installed in front of the selector or shift lever center panel.
- The cup holder which can hold two 20-oz bottles has been equipped. The cup holder can store two CDs in the upright position and pen-size long items horizontally.
- Under the arm rest a large box that can store 10 CDs has been equipped.
- A tray that can store cigarettes and lighters has been equipped. <Vehicles without console switch>
- The synthetic cloth is used for the arm rest lid to enhance luxury and soft feelings.

## SEAT

## FRONT SEAT

M2520004001171

&lt;Heated seat&gt;

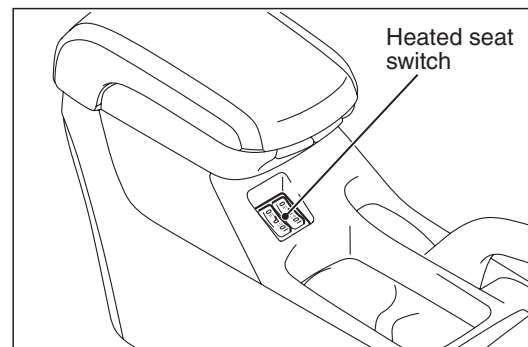
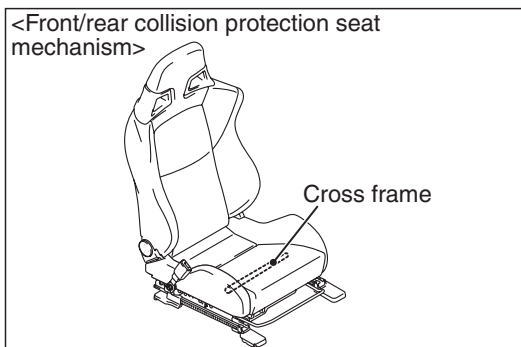
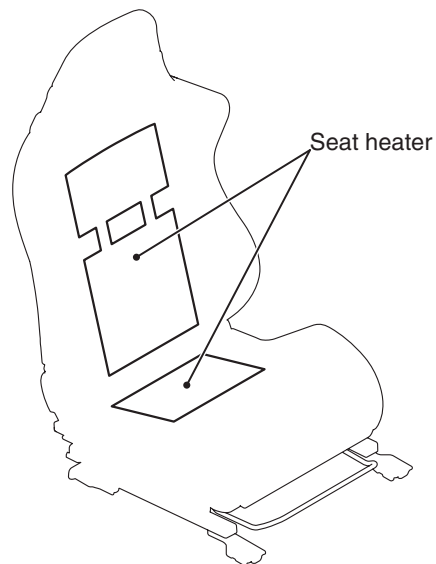
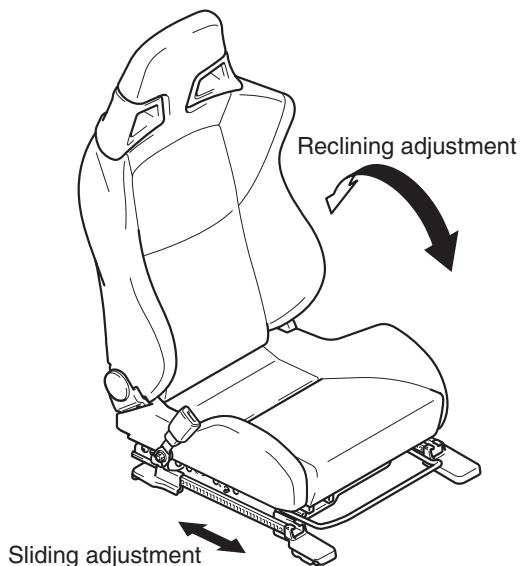

AC708449AB

The front seats offer the following advantages.

- The seats are designed to be adjustable in the reclining and sliding directions.
- The cross frame is established to the seat cushion with frontal and rear-end collision protection seat structure in order to restrain the forward movement of passengers and minimize the severity of an injury.

- Heated seats are adopted to the driver's and front passenger's seats.<Vehicles with heated seat>
- Genuine leather and artificial leather seats are provided. With the genuine leather and artificial leather seat, the genuine leather is used to the side section and the artificial leather is used to the main section to enhance the texture, and the double stitching is added to improve luxurious feel. A separate material is added to the shoulder and thigh sections to receive the lateral G during cornering, ensuring the support function and improving the functionality.<MR>
- Pads of seating surface, side section, and upper back are separated to support the body with the whole seatback, securing an excellent support performance and further enhancing the balance with usefulness.

**SPECIFICATIONS FOR HEATED SEAT**

| Item                 |          | Specification |
|----------------------|----------|---------------|
| ENERGY CONSUMPTION W | HIGH     | 61 ± 6.1      |
|                      | LOW      | 16 ± 1.6      |
| THERMOSTAT °C        | ON → OFF | 40 ± 4        |
|                      | OFF → ON | 30 ± 5        |

**REAR SEAT**

M2520007000746

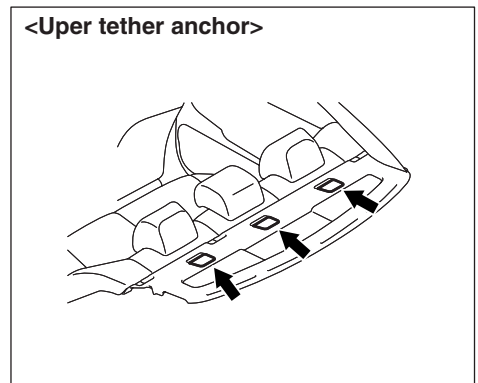
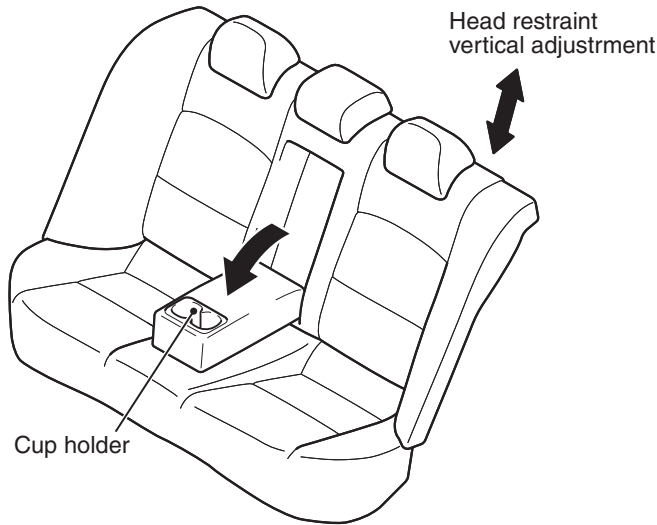

AC708455AB

A low-back bench seat is used for rear seat. The rear seat offer the following advantages:

- Soft leather and artificial leather are adopted for enhanced luxurious feel.<MR>
- The center armrest has a cup holder.
- An upper tether anchor has been installed on the rear shelf trim, and an ISO-FIX lower anchor has been installed on the body side.

## SEAT BELT

M2520010000898

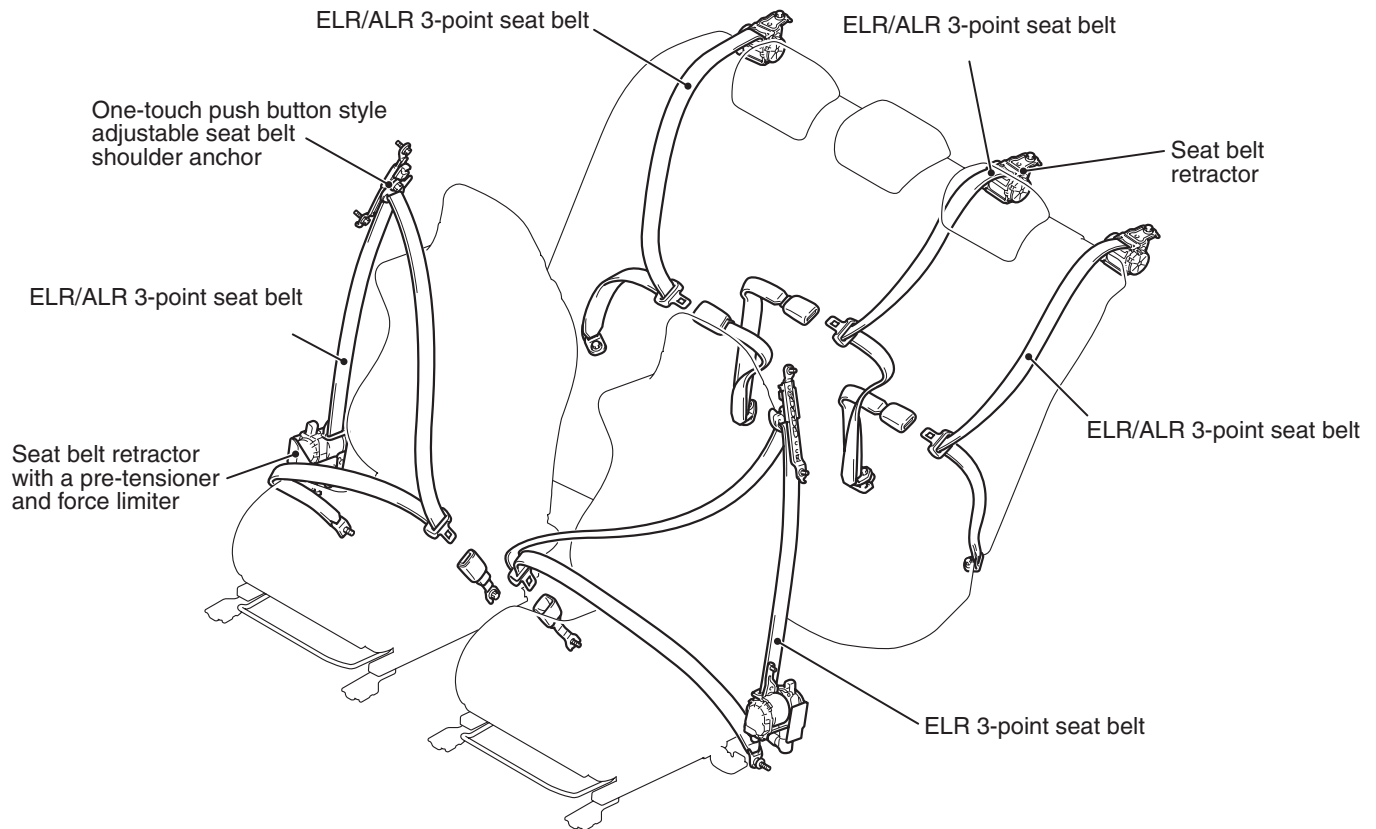
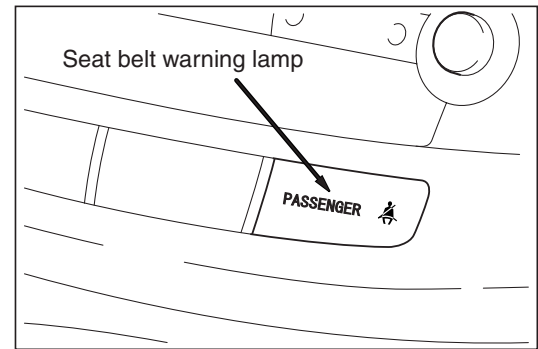
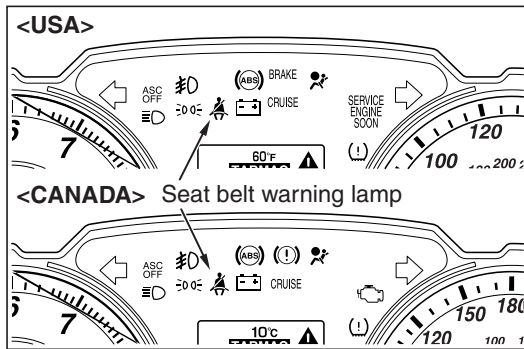

AC708461AB

**FRONT SEAT BELT**

- An ELR 3-point seat belt (driver's side) and 3-point seat belt with ELR/ALR changeover mechanism (passenger's side) is used.
- One-touch push button style adjustable seat belt anchor and retractable buckle provide the most suitable belt fitting.

- The seat belt retractor with the force limiter for the driver's seat and the front passenger's seat increase safety.
- A seat belt warning light is installed to the driver's and passenger's seat.

**REAR SEAT BELT**

- 3-point seat belt with ALR/ELR changeover mechanism (LH/RH/Center) is used for the rear seat.

## SEAT BELT RETRACTOR WITH FORCE LIMITER

The driver's/front passenger's seat belt retractor has been equipped with a force limiter. The force limiter is a device which operates when a predetermined force is applied, and limits the force.

### OPERATION

1. If a collision energy is transmitted to the seat belt, the ELR mechanism will operate to lock the seat belt.
2. If the energy increases to a predetermined value, the torsion bar will be distorted. As the spindle rotates together with the torsion bar, the seat belt webbing is pulled out, reducing the impact to the occupants.

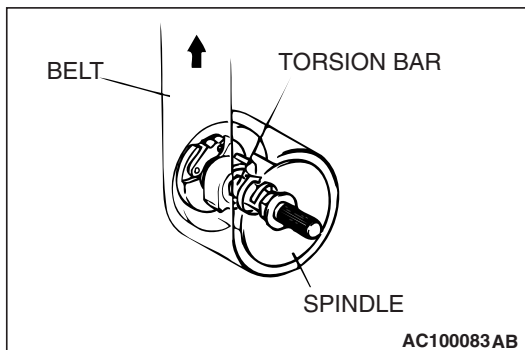

## TRIMS

## INTERIOR TRIMS

M2520012000720

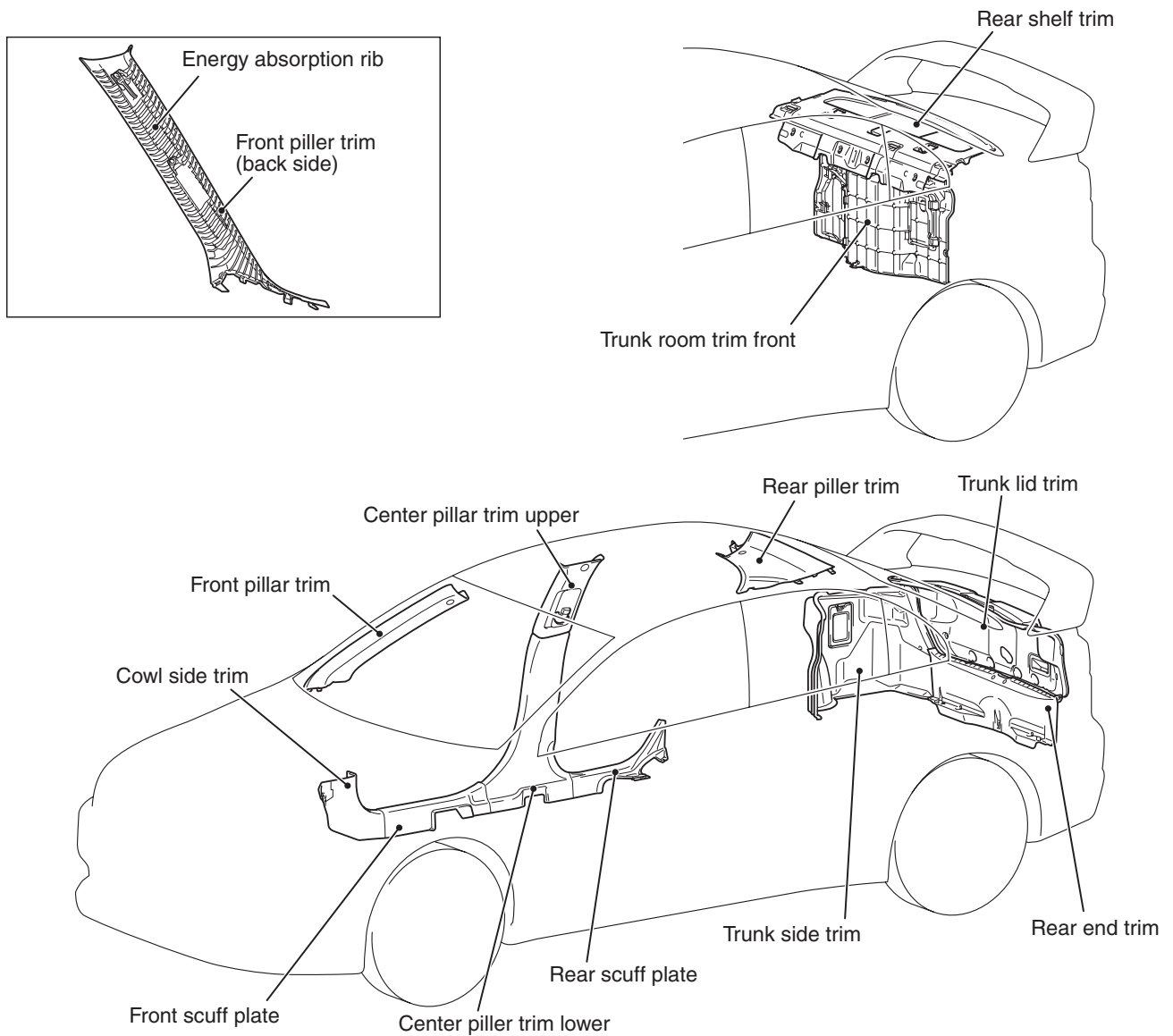

AC708640AB

- The interiors are fully covered by trims.
- The energy absorption rib molding located in the back side of the front pillar trim and the rear pillar trim protect head from side impacts and the resin materials for the trims are unbreakable materials.
- Use of nonflammable materials for the trims has increased safety as outstanding interiors. Also, material codes are indicated to deal with recycling easily.



DOOR TRIM

M2520012300709

<Rear door trim>

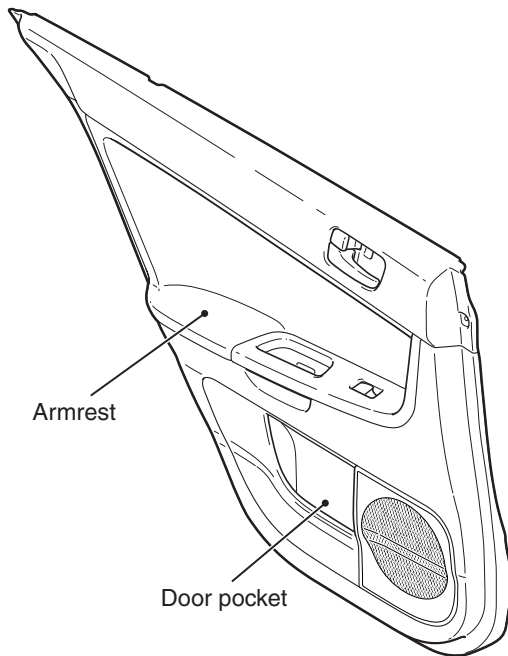

<Front door trim>

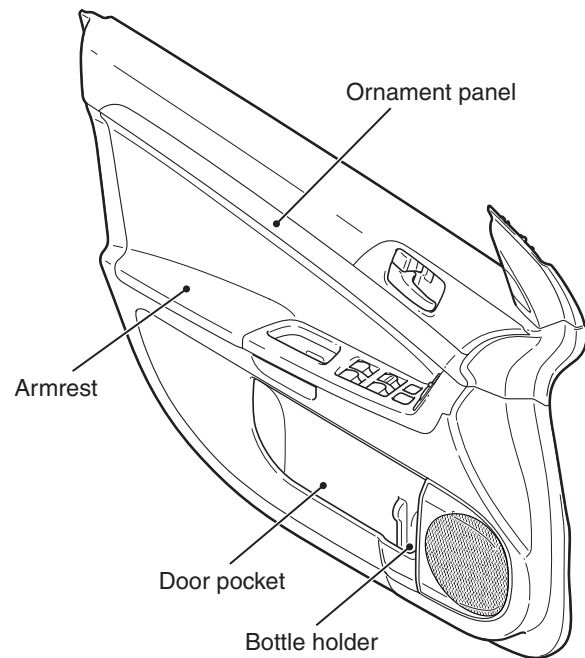

AC608432AB

- The decorated panel has been adopted for the front door trim.
- The bottle holder for bottles with shapes that are difficult to keep upright has been adopted for the front door pocket.
- The front door pocket with a large capacity has been adopted for items such as A4-size map. Also, the rear door pocket has been added.
- The shock absorbing arm rest has been adopted which reduces the mid section injuries to passengers by collapsing upon side impact.
- The arm rest which is formed with cloth has been adopted to create a continuous flow with the ornament section.<GSR>
- Separate artificial leather upholstery armrests with stitching are adopted to emphasize high quality.<MR>

# HEADLINING

M2520014000425

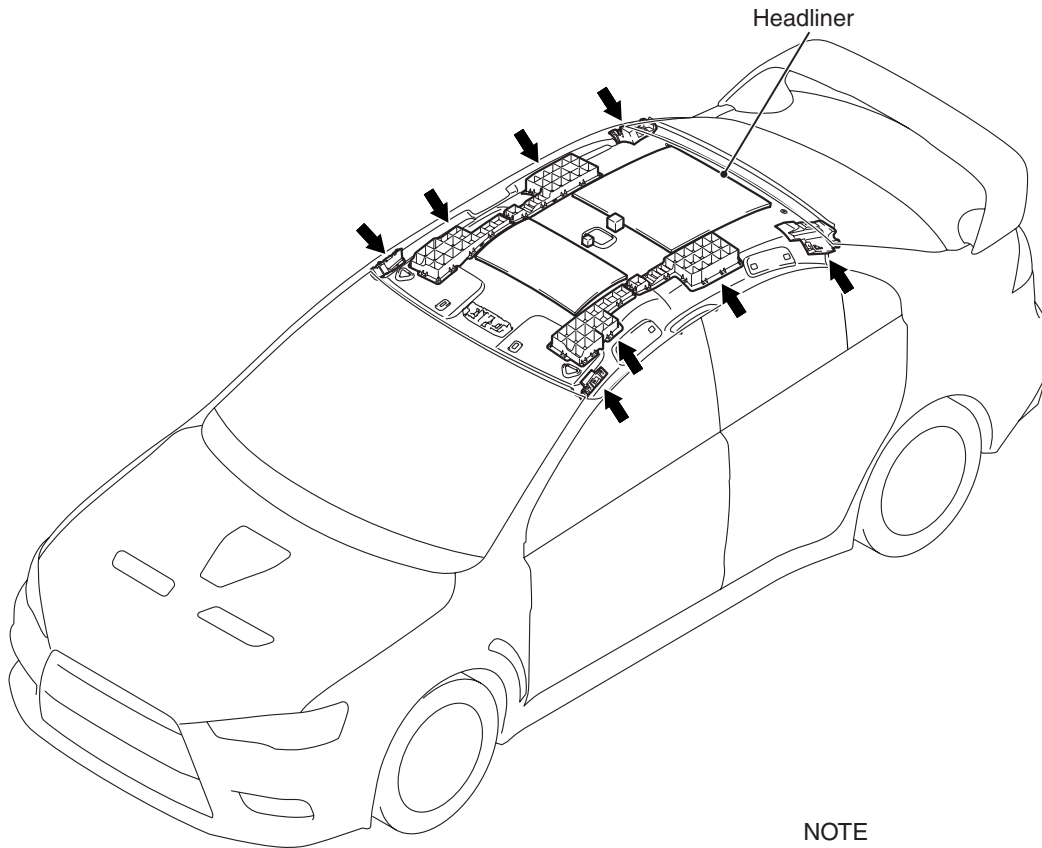
**NOTE**

◀ : Energy absorption box positions

AC708644AB

Interior design with safe material has been adopted, achieving more safe and comfortable interior.

- Energy absorption pad and rib have been adopted to the inside of headliner. This reduces head injuries upon the secondary impact against the cabin during a collision, and improves safety.