

## GROUP 80A

# CONFIGURATION DIAGRAMS

## CONTENTS

OVERALL CONFIGURATION DIAGRAM.....	80A-2	DASH PANEL.....	80A-10
HOW TO READ CONFIGURATION DIAGRAMS .....	80A-3	FLOOR AND ROOF .....	80A-16
ENGINE COMPARTMENT.....	80A-4	DOOR .....	80A-18
ENGINE AND TRANSAXLE .....	80A-6	LUGGAGE COMPARTMENT.....	80A-20

## OVERALL CONFIGURATION DIAGRAM

M1801000102189

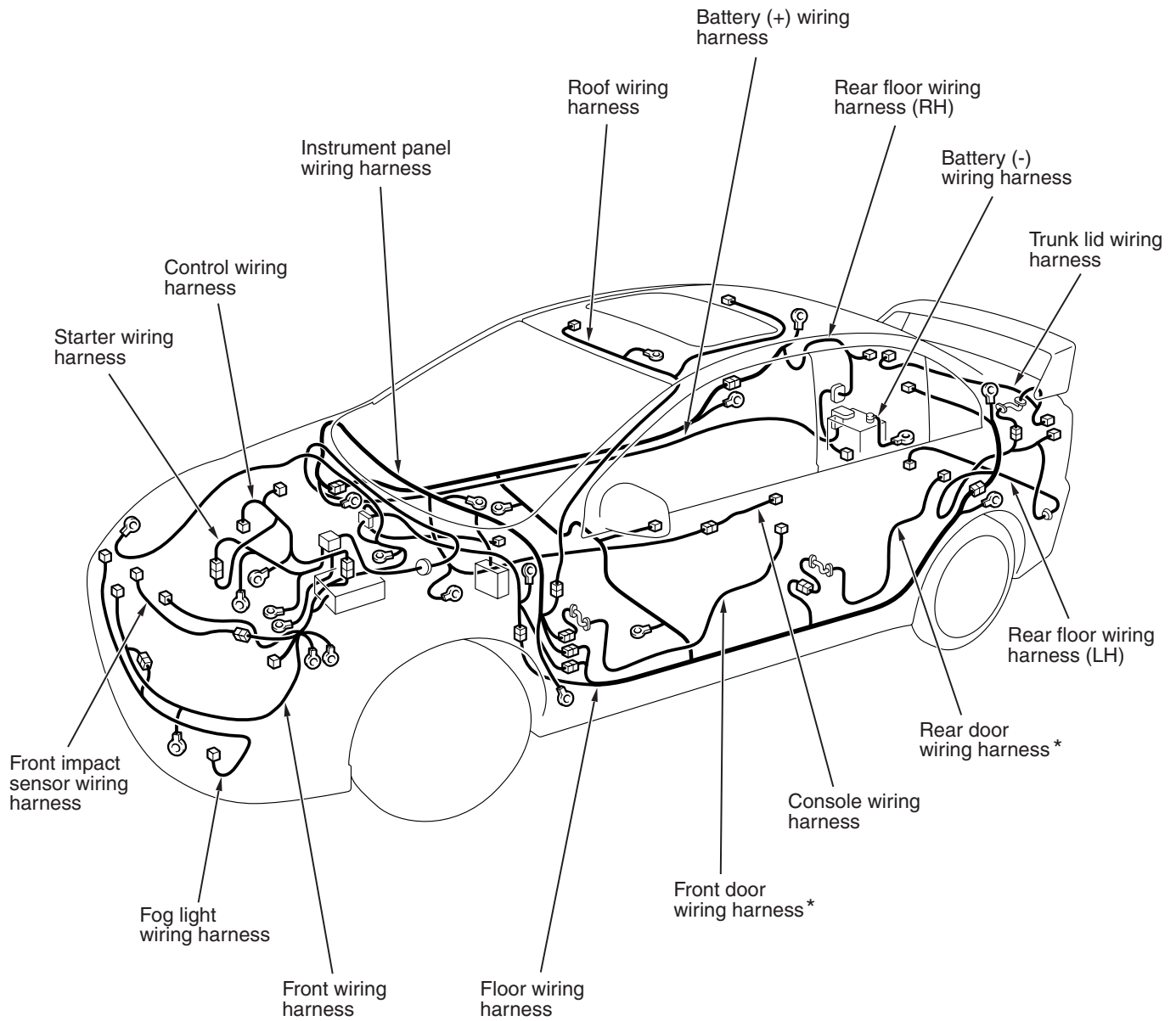

AC708222AB

**NOTE:**

1. This illustration shows only major wiring harnesses.
2. \*: also equipped at the right side.

# HOW TO READ CONFIGURATION DIAGRAMS

M1801000200555

The wiring harness diagrams clearly show the connector locations and harness configurations on actual vehicles. Some variations are included in one configuration diagram. Accordingly, some diagrams may not be applicable for individual vehicles.

Denotes connector No.  
The same connector No. is used throughout the circuit diagrams to facilitate connector location searches.  
The first alphabetical symbol indicates the location site of the connector and a number that follows is the unique number.  
Numbers are usually assigned to parts in clockwise order on the diagram.

Example: A-19

- Number specific to connector (serial number)
- Connector location site symbol

A: ENGINE COMPARTMENT	D: FLOOR AND ROOF
B: ENGINE AND TRANSAXLE	E: DOOR
C: DASH PANEL	F: LUGGAGE COMPARTMENT

Denotes ground point.  
Same ground number is used throughout circuit diagrams to facilitate search of ground point.  
Refer to GROUP 70 COMPONENT LOCATIONS -GROUND MOUNTING LOCATIONS for details of ground points.

Denotes harness name.

Denotes a section covered by a corrugated tube.

The mark ★ shows the standard mounting position of wiring harness.

Denotes the color of the tube (If not specified, it is black).  
R: Red  
Y: Yellow

The number of connector pins and the connector color (except milk white)\* are shown for ease of retrieval.

Example: (2-B)

- Connector color (milk white if no color is indicated)
- Number of connector pins

\*: Typical connector colors

B: Black	BR: Brown
Y: Yellow	V: Violet
L: Blue	O: Orange
G: Green	GR: Gray
R: Red	NONE: Milk white

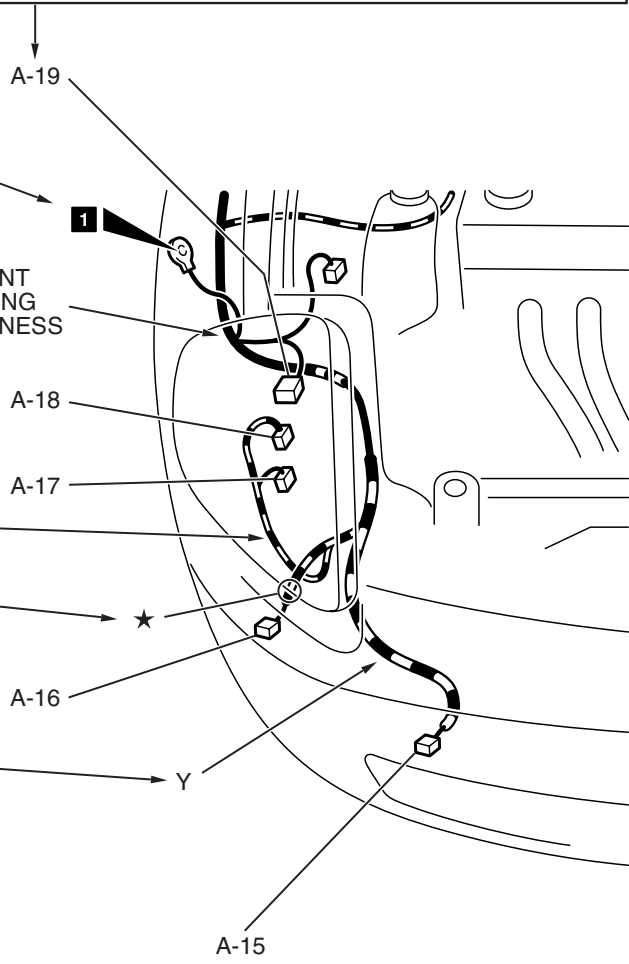

- A-15 (2) FOG LIGHT (RH)
- A-16 (2-GR) HORN (LOW)
- A-17 (2-B) HEADLIGHT (RH)
- A-18 (2-B) WINDSHIELD WASHER MOTOR
- A-19 (2-GR) DUAL PRESSURE SWITCH

Indicates the device to which the connector is connected.

# ENGINE COMPARTMENT

M1801000304242

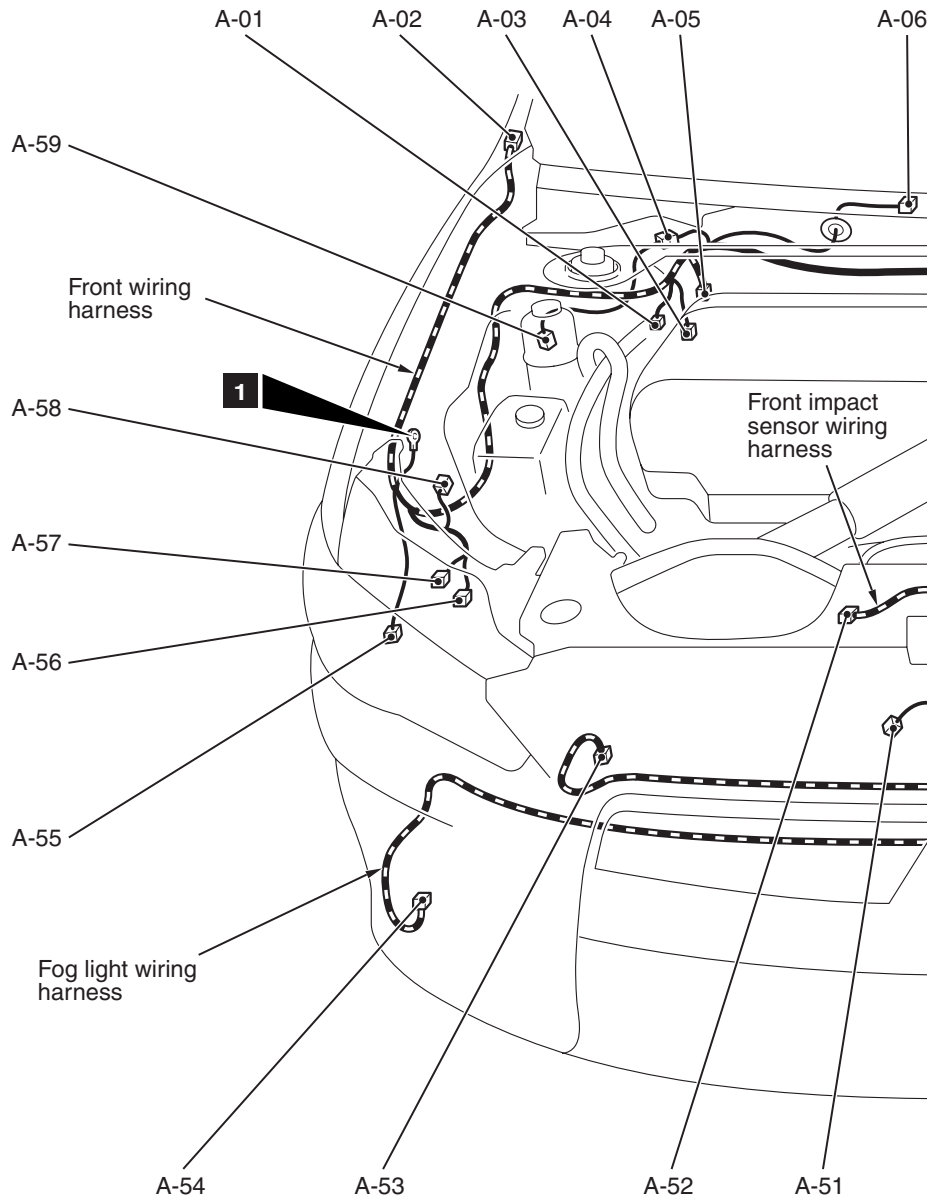
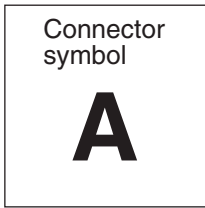

- Connector color code
- B: Black
  - BR: Brown
  - G: Green
  - GR: Gray
  - L: Blue
  - NONE: Milk white
  - O: Orange
  - R: Red
  - V: Violet
  - Y: Yellow

AC708209AB

A-01	(3-GR)	No connection	A-14	(24)	Joint connector (CAN4) <TC-SST>
A-02	(2-B)	Side-turn signal light (RH)	A-15X	(4)	Fog light relay
A-03	(2-B)	Front wheel speed sensor (RH)	A-16X	(4)	Horn relay
A-04	(1-B)	Front wiring harness and theft-alarm horn sub wiring harness combination	A-17X	(4)	A/C compressor clutch relay
A-05	(47-B)	ASC-ECU	A-18X	(4)	Theft-alarm horn relay
A-06	(5-GR)	Windshield wiper motor	A-20X	(4)	No connection
A-07	(4-GR)	Mass airflow sensor	A-21X	(4)	Headlight relay (High)
A-08	(2-B)	Turbocharger wastegate solenoid 2	A-22X	(4)	Throttle actuator control motor relay
A-09	(2)	Brake fluid level switch	A-24X	(4)	Daytime running light relay
A-10	(2-BR)	Turbocharger wastegate solenoid 1	A-25X	(4)	Injector relay
A-11	(2-B)	Front wheel speed sensor (LH)	A-26X	(4)	Electric pump relay
A-12	(2-B)	Side-turn signal light (LH)	A-27X	(4)	Fuel pump relay 1
A-13	(22)	Front wiring harness and control wiring harness combination	A-28X	(4)	Starter relay

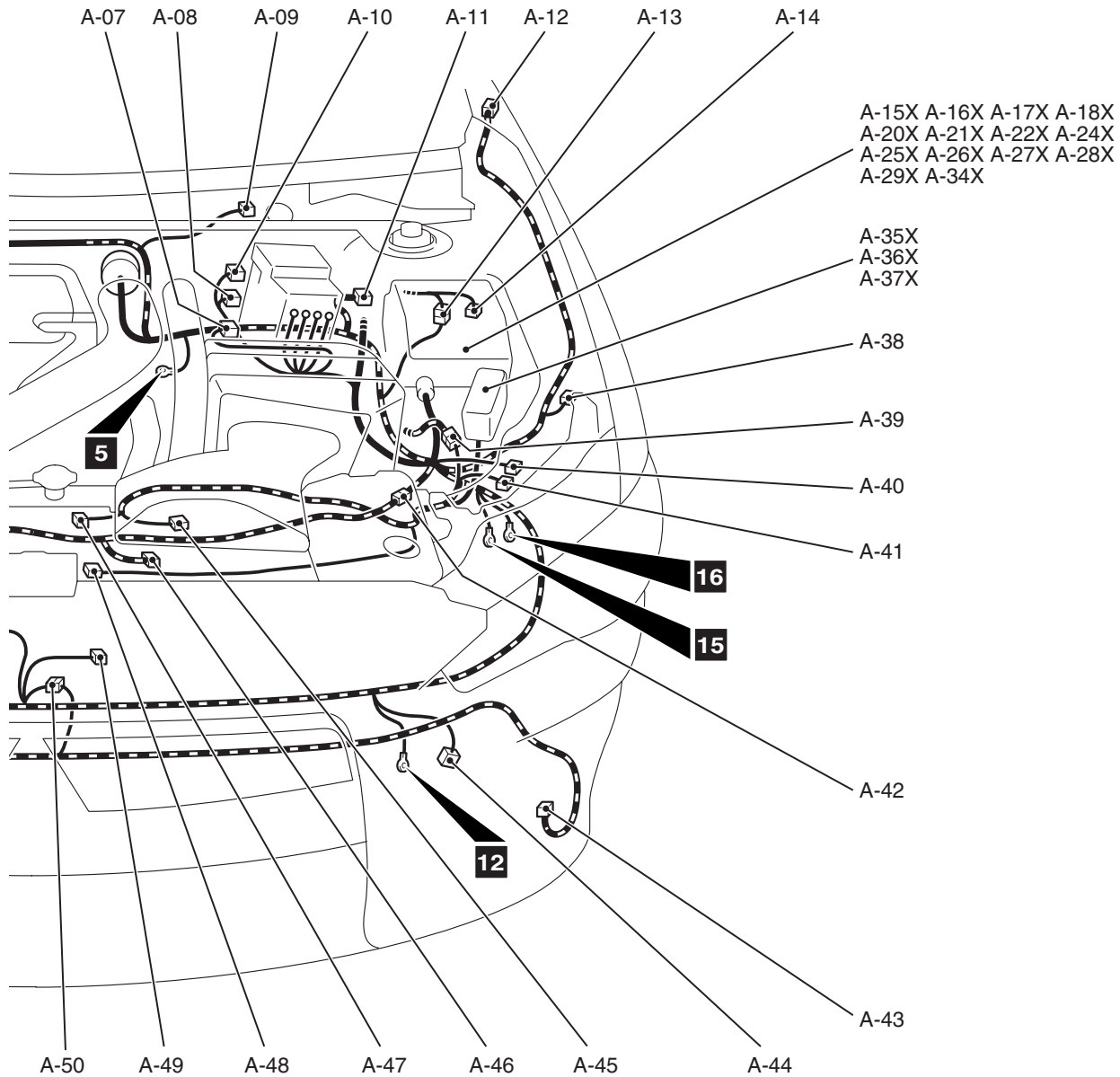

AC708210AB

A-29X (4)	Headlight relay (Low)	A-46 (2-Y)	Front impact sensor (LH)
A-34X (4)	MFI relay	A-47 (2-B)	Condenser fan motor
A-35X (4)	Radiator fan relay	A-48 (2-B)	Hood switch
A-36X (4)	Condenser fan relay	A-49 (2-B)	Ambient air temperature sensor
A-37X (5)	Fan control relay	A-50 (2-B)	Front wiring harness and fog light wiring harness combination
A-38 (4-B)	Spare connector	A-51 (1-B)	Horn (Low)
A-39 (6-B)	Front wiring harness and control wiring harness combination	A-52 (2-Y)	Front impact sensor (RH)
A-40 (12-B)	Headlight assembly (LH)	A-53 (3-B)	A/C pressure sensor
A-41 (6-B)	Headlight assembly (LH)	A-54 (2-B)	Fog light (RH)
A-42 (4-B)	Front wiring harness and front impact sensor wiring harness combination	A-55 (2-B)	No connection
A-43 (2-B)	Fog light (LH)	A-56 (6-B)	Headlight assembly (RH)
A-44 (1-B)	Horn (High)	A-57 (12-B)	Headlight assembly (RH)
A-45 (2-B)	Radiator fan motor	A-58 (2-B)	Fuel pump circuit resistor
		A-59 (1-B)	Theft-alarm horn

ENGINE AND TRANSAXLE

M1801000403075

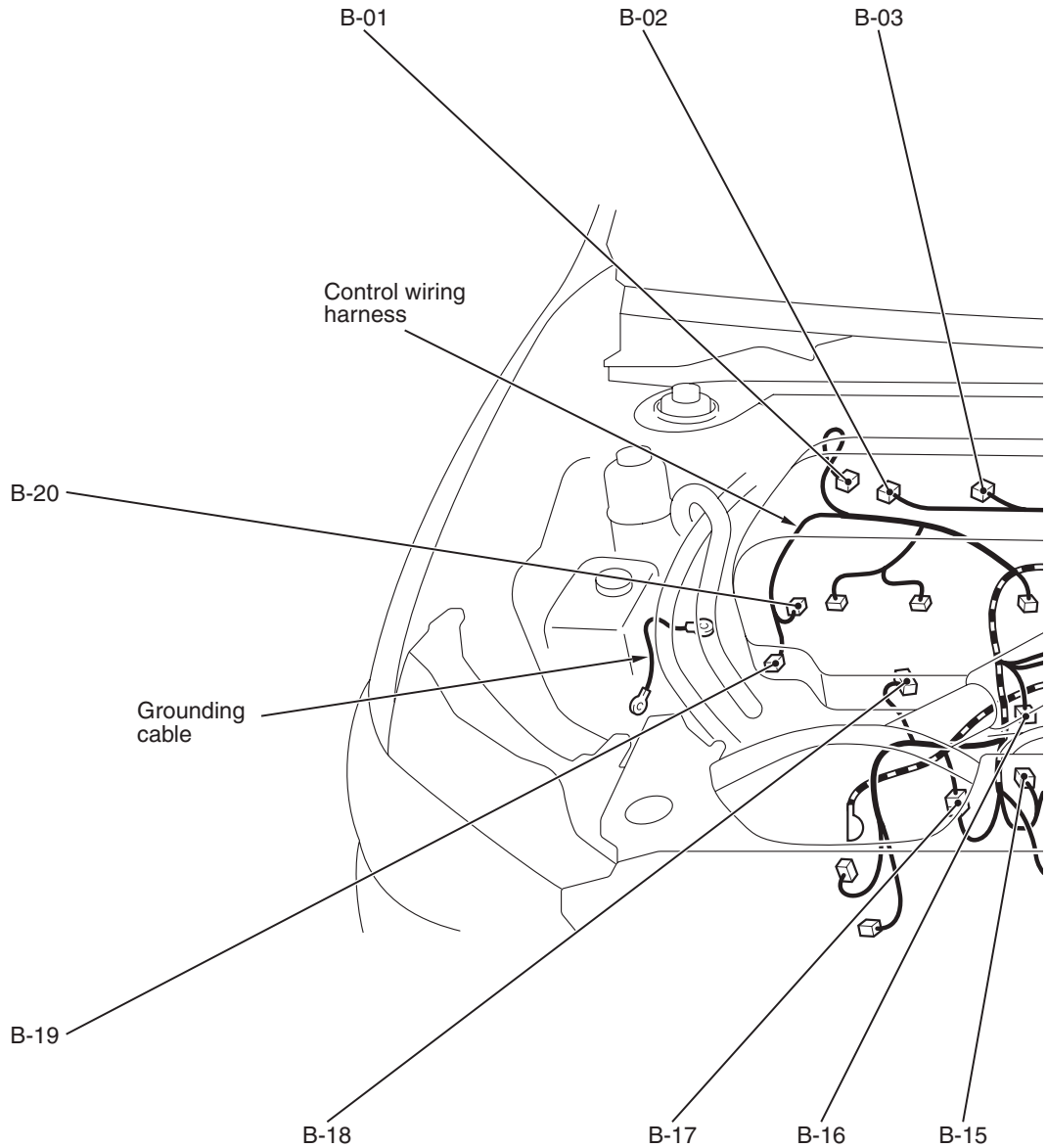
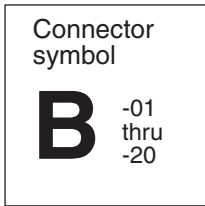

Connector color code  
 B: Black  
 BR: Brown  
 G: Green  
 GR: Gray  
 L: Blue  
 NONE: Milk white  
 O: Orange  
 R: Red  
 V: Violet  
 Y: Yellow

AC708212AB

- B-01 (2) Exhaust oil feeder control valve
- B-02 (4-GR) Ignition coil 1
- B-03 (4-GR) Ignition coil 2
- B-04 (4-GR) Ignition coil 3
- B-05 (3-GR) Exhaust camshaft position sensor

- B-06 (4-GR) Ignition coil 4
- B-07 (3-GR) Intake camshaft position sensor
- B-08 (2-B) Engine coolant temperature sensor
- B-09 (64-GR) Engine control module
- B-10 (48-GR) Engine control module

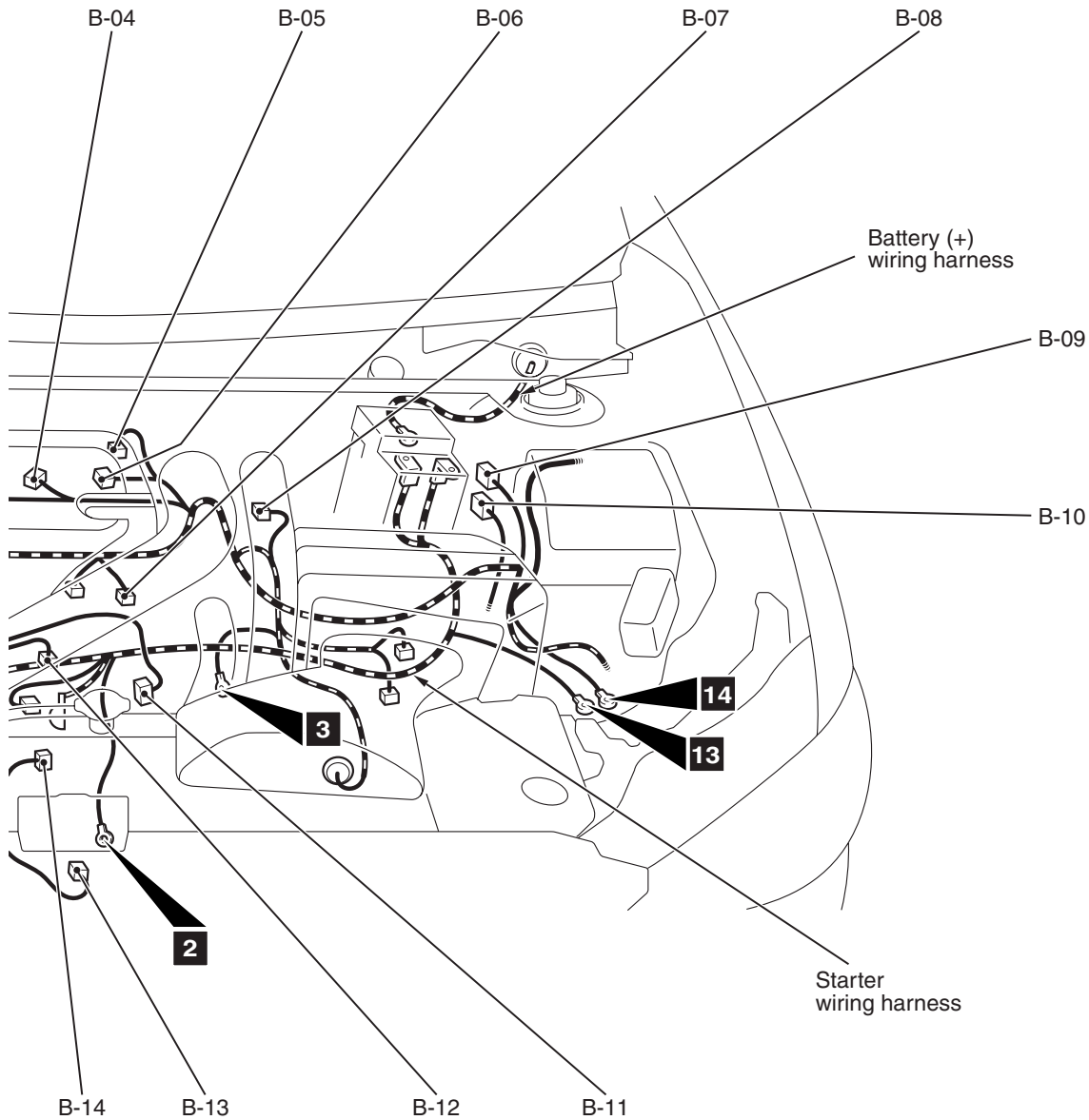

AC708213AB

- B-11 (6-B) Throttle body assembly
- B-12 (2-B) Evaporative emission purge solenoid
- B-13 (3-GR) Crankshaft position sensor
- B-14 (2-B) Knock sensor
- B-15 (1) Engine oil pressure switch
- B-16 (2-B) Intake air temperature sensor 2

- B-17 (1-B) Control wiring harness and starter wiring harness combination
- B-18 (3-B) Manifold absolute pressure sensor
- B-19 (1) Power steering pressure switch
- B-20 (2) Intake engine oil feeder control valve

ENGINE AND TRANSAXLE (CONTINUED)

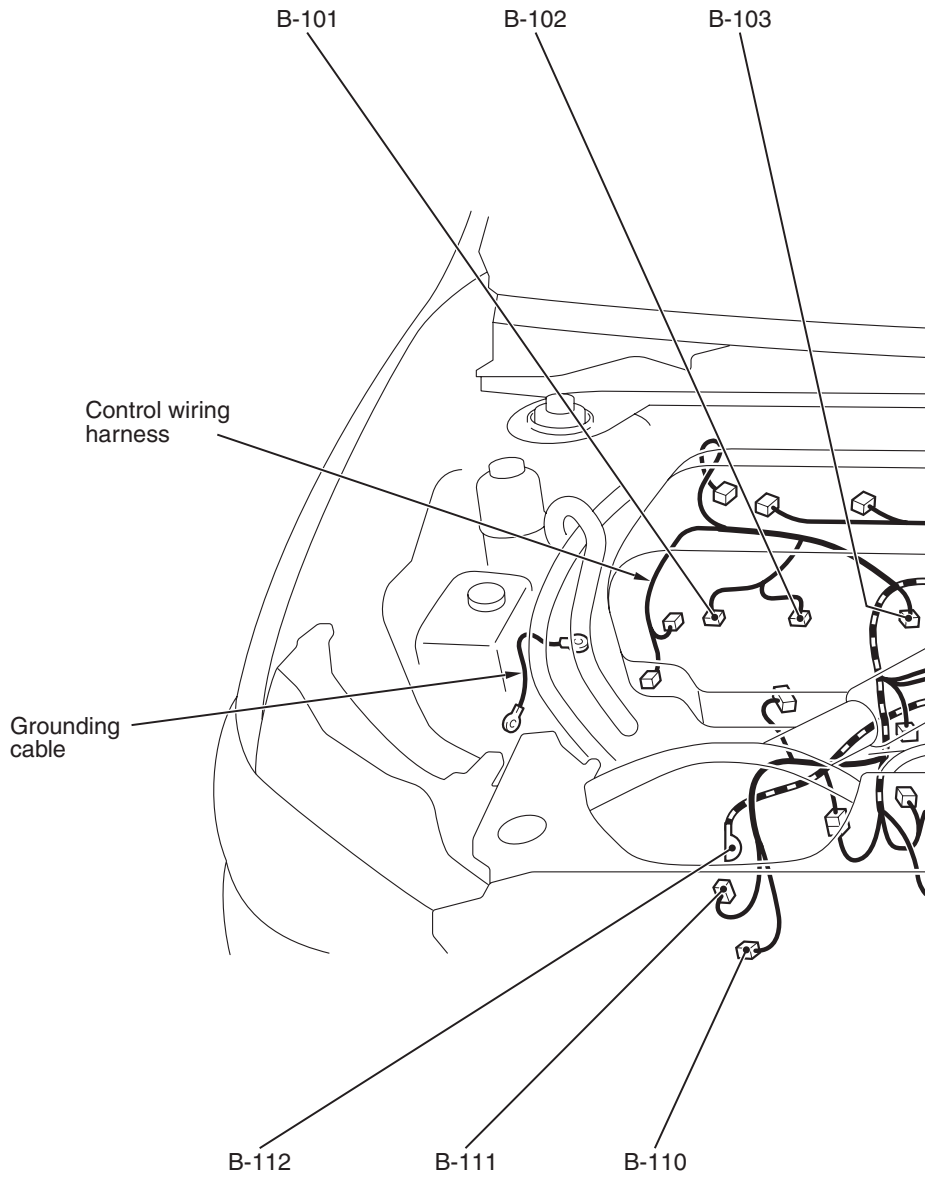
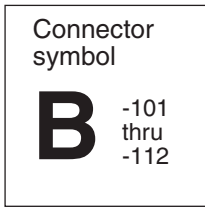

Connector color code

B: Black  
BR: Brown  
G: Green  
GR: Gray  
L: Blue  
NONE: Milk white  
O: Orange  
R: Red  
V: Violet  
Y: Yellow

B-101 (2-GR) Injector 1  
B-102 (2-GR) Injector 2  
B-103 (2-GR) Injector 3

B-104 (2-GR) Injector 4  
B-105 (2-B) Backup light switch <M/T>  
B-106 (2-GR) 1st & 2nd rail switch <M/T>

AC708212AC



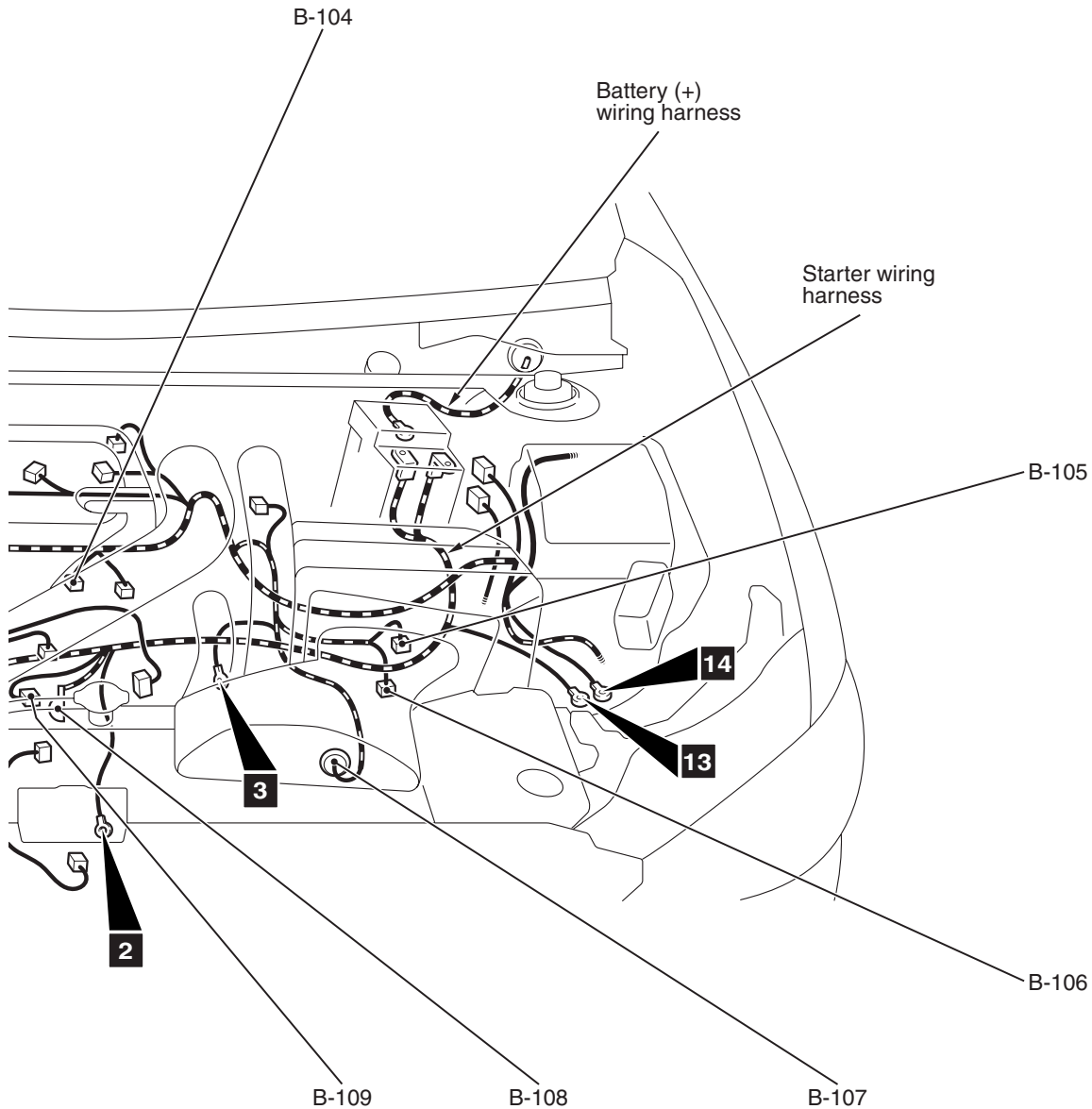

AC708213AC

B-107 (20-B) Transaxle assembly <TC-SST>  
 B-108 (1) Starter  
 B-109 (1-B) Starter

B-110 (4-GR) A/C compressor clutch assembly  
 B-111 (4-GR) Generator  
 B-112 (1) Generator

DASH PANEL

M1801000602645

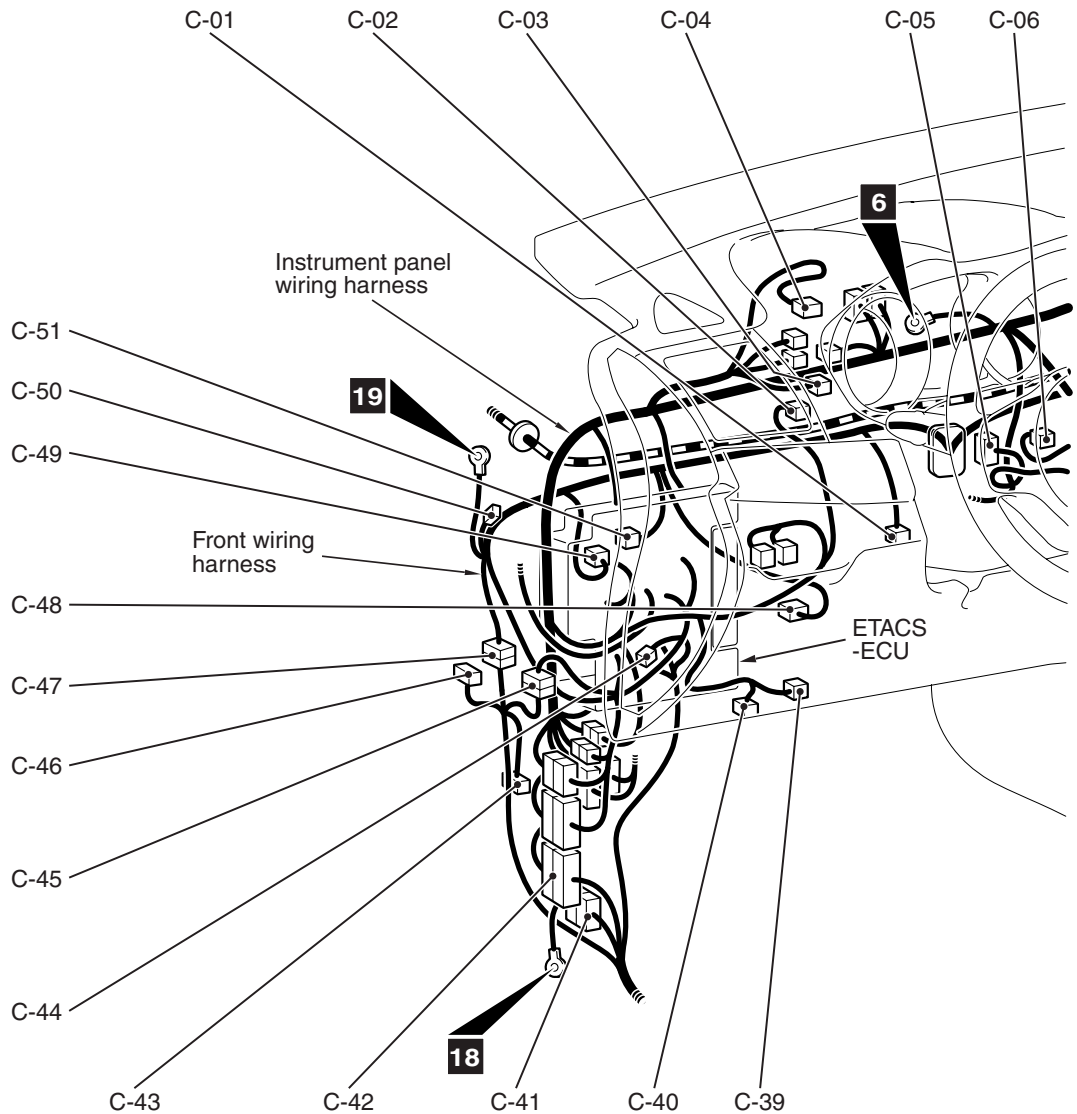
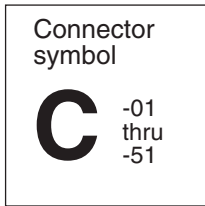

- Connector color code
- B: Black
  - BR: Brown
  - G: Green
  - GR: Gray
  - L: Blue
  - NONE: Milk white
  - O: Orange
  - R: Red
  - V: Violet
  - Y: Yellow

AC708215AB

C-01	(6-B)	Accelerator pedal position sensor	C-13	(17-GR)	Multivision display <Vehicles with MMCS>
C-02	(4)	Meter information switch	C-14	(4-Y)	Passenger's (Front) air bag module (squib)
C-03	(6)	No connection	C-15	(10)	CAN box unit
C-04	(24)	Combination meter	C-16	(24-B)	Joint connector (6)
C-05	(40)	KOS-ECU	C-17	(10)	No connection
C-06	(2)	Interior temperature sensor	C-18	(14)	Satellite radio tuner
C-07	(12)	Wireless control module <Vehicles without KOS>	C-19	(24)	No connection
C-08	(12)	Receiver antenna module <Vehicles with KOS>	C-20	(16-B)	A/C-ECU
C-09	(7)	Multivision display <Vehicles with MMCS>	C-21	(1-GR)	Front wiring harness and floor wiring harness combination
C-10	(32-GR)	Multivision display <Vehicles with MMCS>	C-22	(20-B)	A/C-ECU
C-11	(24)	Hands free module	C-23	(20)	Instrument panel wiring harness and floor wiring harness combination
C-12	(5-GR)	Multivision display <Vehicles with MMCS>	C-24	(24)	Instrument panel wiring harness and floor wiring harness combination
			C-25	(2)	Accessory socket

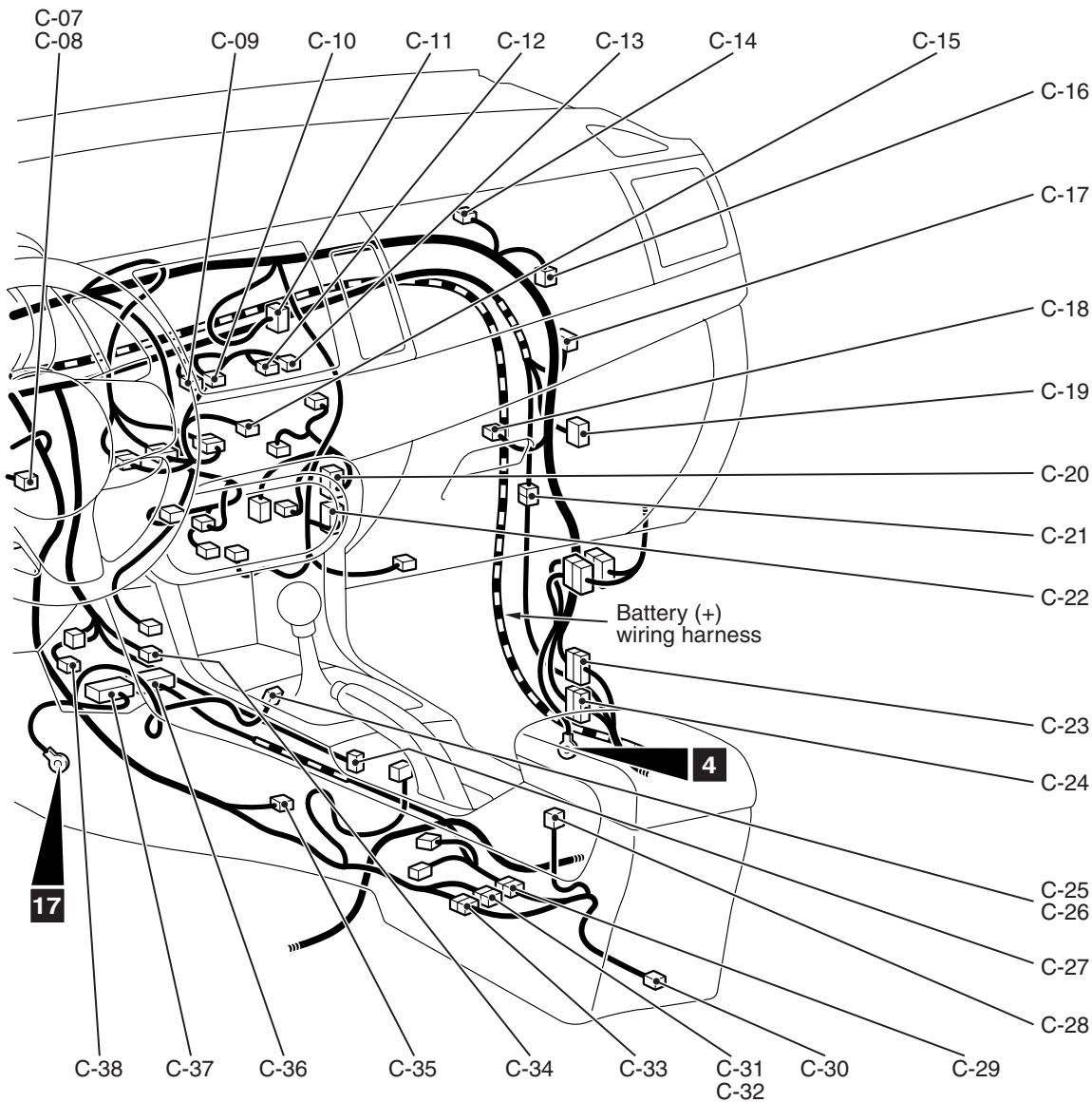

AC708216AB

C-26	(2)	Cigarette lighter	C-38	(6-B)	G and yaw rate sensor
C-27	(16)	Shift lever <TC-SST>	C-39	(2-B)	Knee air bag module (squib)
C-28	(9)	Heated seat switch	C-40	(16-B)	Data link connector
C-29	(4)	Floor wiring harness and console wiring harness combination	C-41	(24)	Instrument panel wiring harness and floor wiring harness combination
C-30	(2)	No connection	C-42	(20)	Instrument panel wiring harness and floor wiring harness combination
C-31	(7-B)	Jumper connector <Vehicles without steering wheel audio remote control switch>	C-43	(24-B)	Joint connector (4)
C-32	(7)	Jumper connector <Vehicles with steering wheel audio remote control switch>	C-44	(4)	Spare connector
C-33	(6)	Instrument panel wiring harness and console wiring harness combination	C-45	(6)	Front wiring harness and floor wiring harness combination
C-34	(4-B)	Heated oxygen sensor (Front)	C-46	(26)	S-AWC-ECU
C-35	(10)	Selector lever assembly <TC-SST>	C-47	(22)	Front wiring harness and floor wiring harness combination
C-36	(32-Y)	SRS-ECU	C-48	(4)	Stoplight switch
C-37	(24-Y)	SRS-ECU	C-49	(2)	Clutch pedal position switch <M/T>
			C-50	(24-B)	Joint connector (7)
			C-51	(2)	Clutch interlock switch <M/T>

DASH PANEL (CONTINUED)

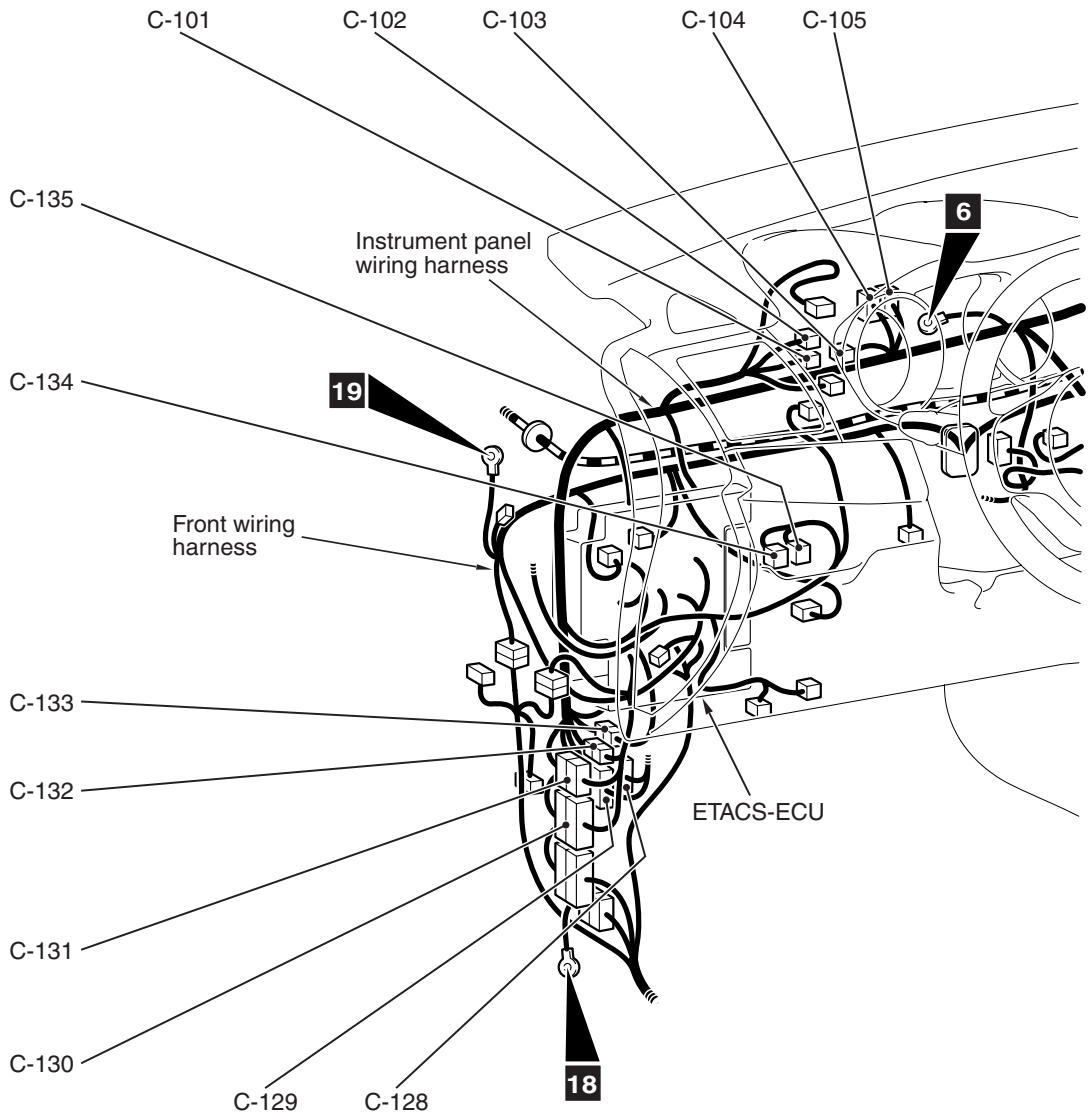
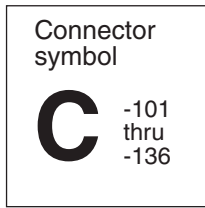

- Connector color code
- B: Black
  - BR: Brown
  - G: Green
  - GR: Gray
  - L: Blue
  - NONE: Milk white
  - O: Orange
  - R: Red
  - V: Violet
  - Y: Yellow

AC708215AC

C-101 (24-B)	Joint connector (1)	C-111 (5)	Outside/inside air selection damper control motor
C-102 (12-B)	Joint connector (2)	C-112 (5)	Mode selection damper control motor
C-103 (24-B)	Joint connector (3)	C-113 (2)	Fin thermo sensor
C-104 (24)	Joint connector (CAN2)	C-114 (5)	Air mixing damper control motor
C-105 (24)	Joint connector (CAN1)	C-115 (2)	Blower motor
C-106 (24)	Instrument panel wiring harness and multivision display wiring harness combination <Vehicles with MMCS>	C-116 (12)	Instrument panel wiring harness and front door wiring harness (RH) combination
C-107 (20)	Radio and CD player <Vehicles without MMCS>	C-117 (24-BR)	Instrument panel wiring harness and front door wiring harness (RH) combination
C-108 (20)	Instrument panel wiring harness and multivision display wiring harness combination <Vehicles with MMCS>	C-118 (2)	Radio antenna
C-109 (18)	Radio and CD player <Vehicles without MMCS>		
C-110 (18)	Instrument panel wiring harness and multivision display wiring harness combination <Vehicles with MMCS>		

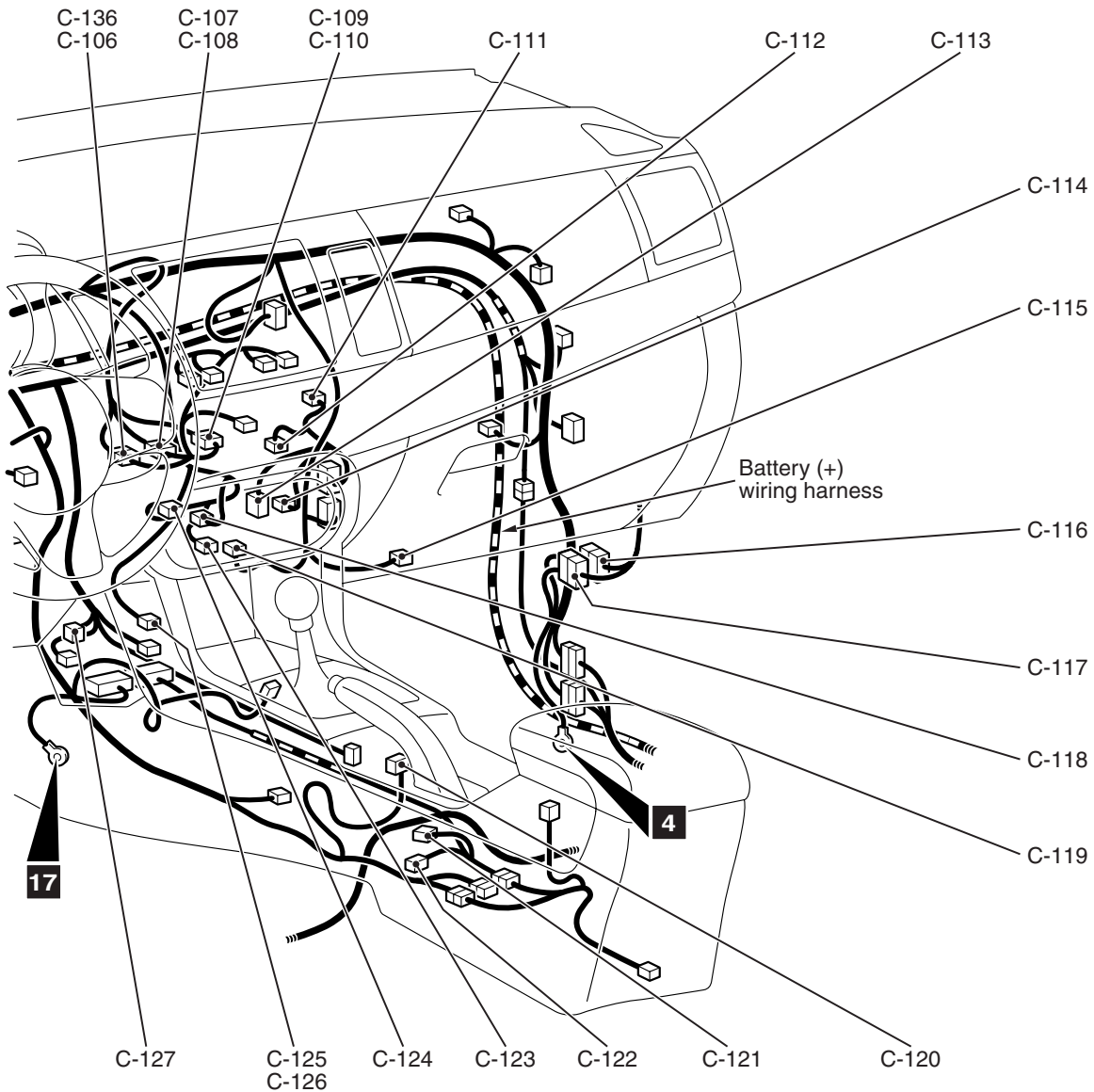

AC708216AC

C-119 (4)	Power transistor	C-129 (24-BR)	Instrument panel wiring harness and front door wiring harness (LH) combination
C-120 (6)	AWC switch <Vehicles with steering wheel audio remote control switch>	C-130 (16-BR)	Instrument panel wiring harness and front wiring harness combination
C-121 (3)	Inside transmission antenna assembly (Front) <Vehicles with KOS>	C-131 (22)	Instrument panel wiring harness and front wiring harness combination
C-122 (1-B)	Parking brake switch	C-132 (2)	Instrument panel wiring harness and front wiring harness combination
C-123 (12)	A/C control panel	C-133 (12)	Instrument panel wiring harness and roof wiring harness combination
C-124 (16)	Center panel unit	C-134 (6-GR)	Headlight leveling switch
C-125 (6-B)	Audio adapter <Vehicles without MMCS>	C-135 (6)	ASC off switch
C-126 (6-B)	Audio and video adapter <Vehicles with MMCS>	C-136 (24)	Spare connector (for navigation unit)
C-127 (24)	Joint connector (CAN3)		
C-128 (12)	Instrument panel wiring harness and front door wiring harness (LH) combination		

DASH PANEL (CONTINUED)

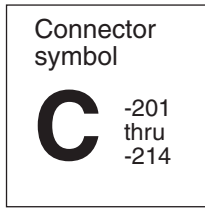

Steering column

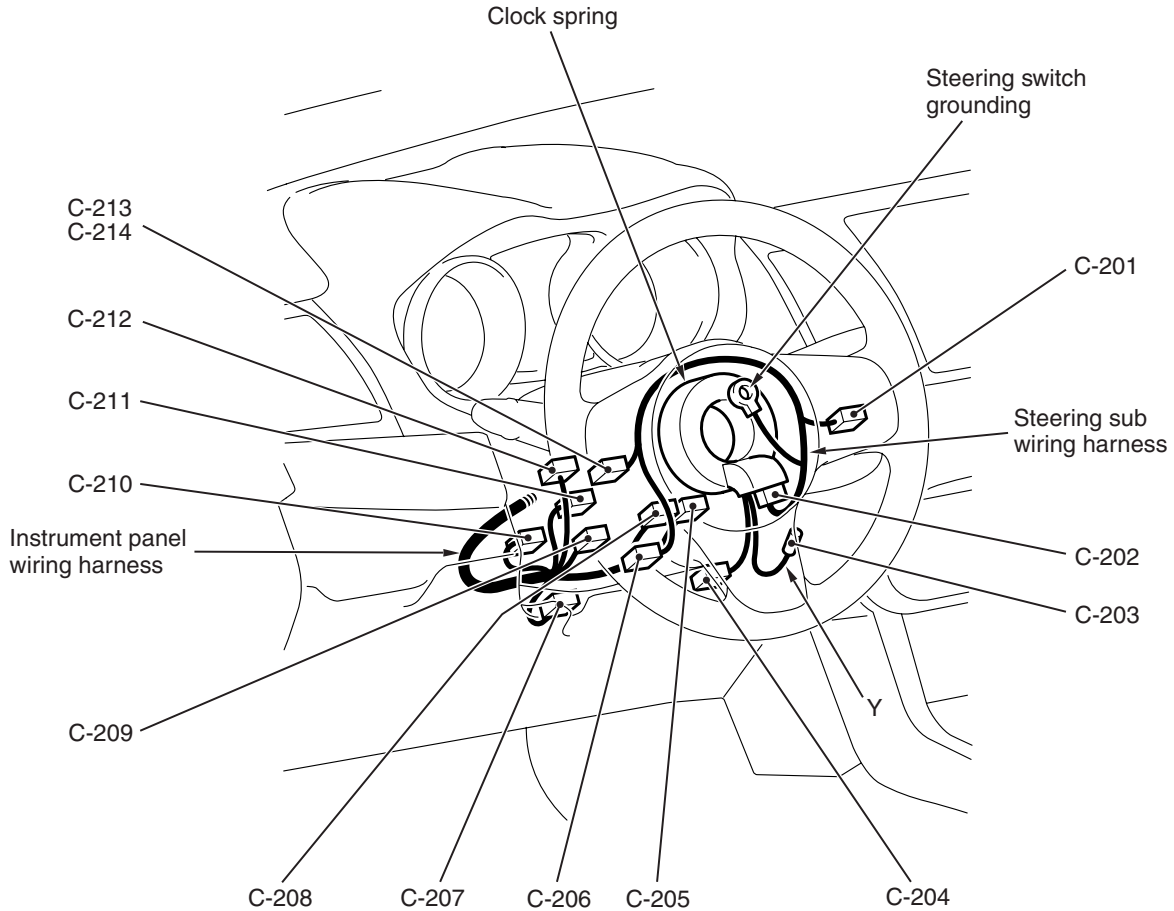

AC708217AB

- |             |  |             |  |
|-------------|--|-------------|--|
| C-201 (4-L) | Auto-cruise control switch   | C-208 (4-Y) | Clock spring   |
| C-202 (5)   | Clock spring and steering sub wiring harness combination                                       | C-209 (5)   | Steering wheel sensor  |
| C-203 (1)   | Horn switch  | C-210 (6)   | Ignition switch  |
| C-204 (4-Y) | Driver's air bag module (squib)  | C-211 (12)  | Key reminder switch  |
| C-205 (6)   | Clock spring   | C-212 (10)  | Column switch  |
| C-206 (4-Y) | Steering wheel voice control switch <Vehicles with steering wheel audio remote control switch> | C-213 (5-R) | Steering wheel audio remote control switch                               |
| C-207 (3)   | Paddle shift switch <TC-SST>   | C-214 (5-R) | AWC switch <Vehicles without steering wheel audio remote control switch> |

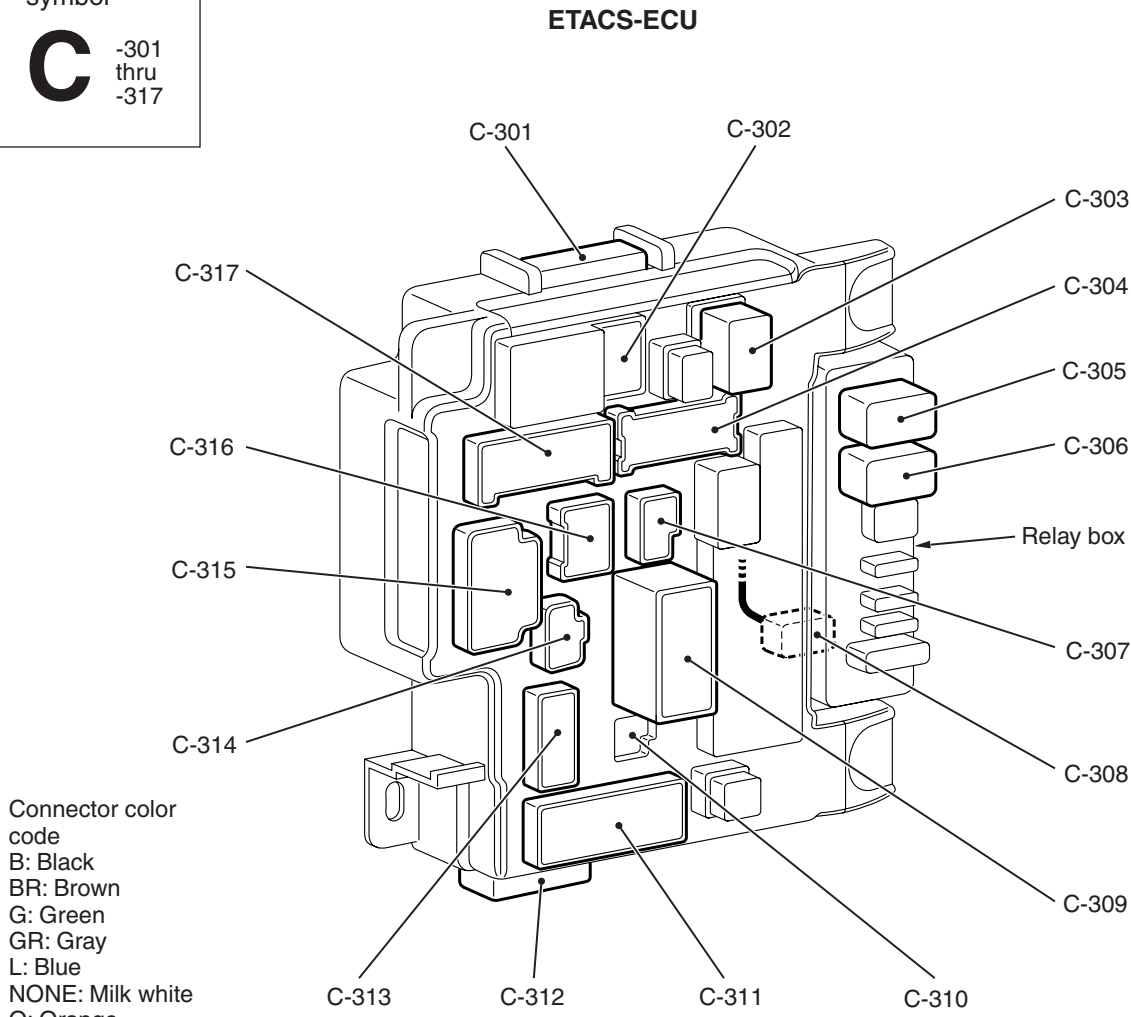
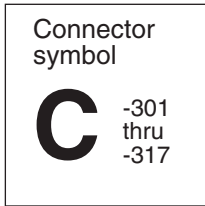

Connector color code  
B: Black  
BR: Brown  
G: Green  
GR: Gray  
L: Blue  
NONE: Milk white  
O: Orange  
R: Red  
V: Violet  
Y: Yellow

AC607744AD

C-301 (24)	Instrument panel wiring harness and ETACS-ECU combination	C-311 (20)	Floor wiring harness and ETACS-ECU combination
C-302 (4)	No connection	C-312 (16)	Front wiring harness and ETACS-ECU combination
C-303 (4)	Blower relay	C-313 (16-BR)	Floor wiring harness and ETACS-ECU combination
C-304 (16)	Front wiring harness and ETACS-ECU combination	C-314 (2)	Floor wiring harness and ETACS-ECU combination
C-305 (4)	Heated seat relay	C-315 (19)	Instrument panel wiring harness and ETACS-ECU combination
C-306 (4)	Rear window defogger relay	C-316 (6)	Roof wiring harness and ETACS-ECU combination
C-307 (2-B)	Front wiring harness and ETACS-ECU combination	C-317 (15)	Instrument panel wiring harness and ETACS-ECU combination
C-308 (1-GR)	Instrument panel wiring harness and relay box combination		
C-309 (2-B)	Front wiring harness and ETACS-ECU combination		
C-310 (4)	No connection		

FLOOR AND ROOF

M1801000902947

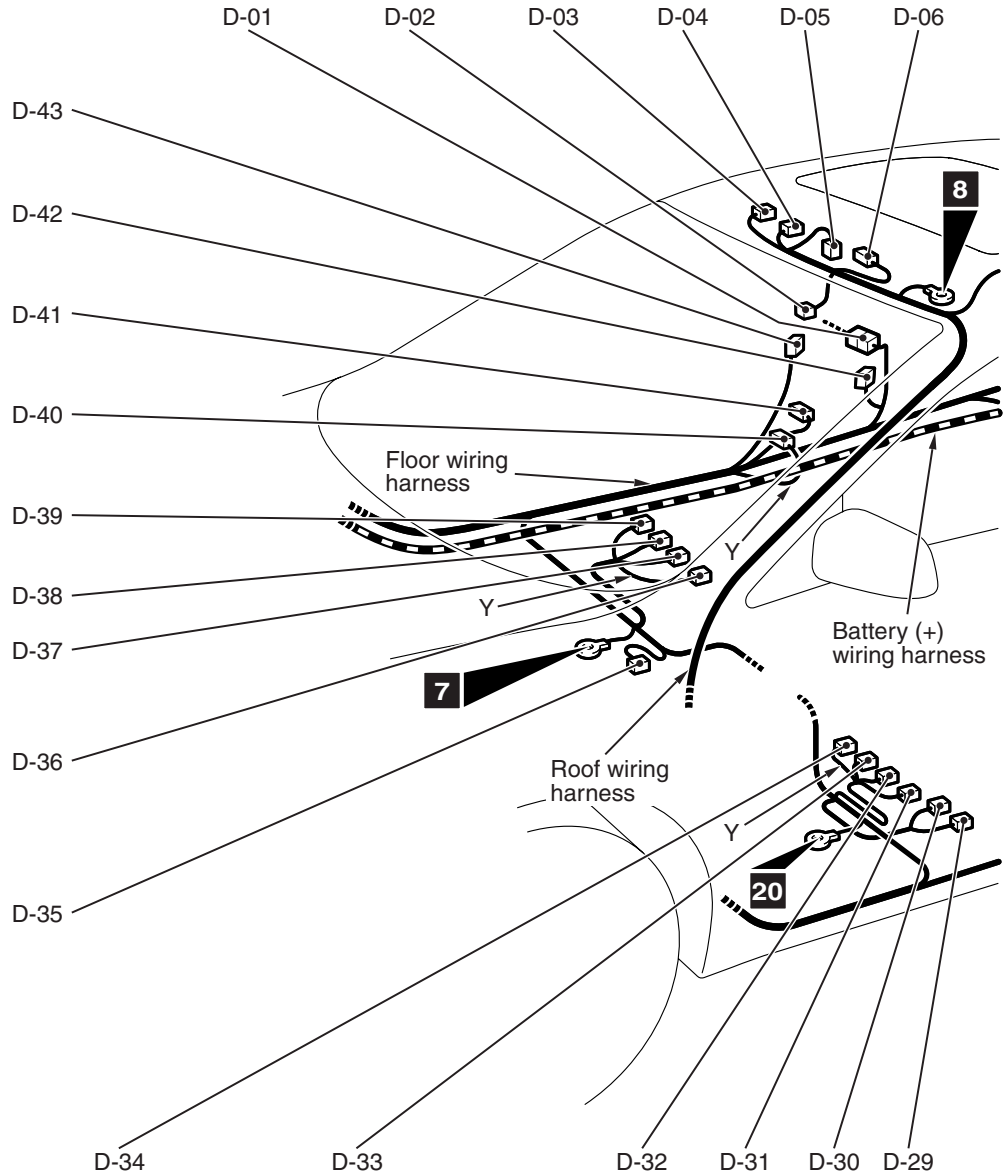
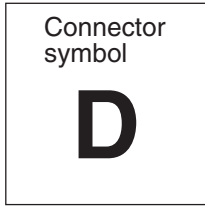

- Connector color code
- B : Black
  - BR : Brown
  - G : Green
  - GR : Gray
  - L : Blue
  - None : Milk white
  - O : Orange
  - R : Red
  - V : Violet
  - Y : Yellow

- D-01 (10) Floor wiring harness and rear door wiring harness (RH) combination
- D-02 (4) Lighting control sensor <Vehicles with automatic light>
- D-03 (3) Front dome light
- D-04 (3) Microphone unit
- D-05 (6-B) Sunroof switch
- D-06 (10-GR) Sunroof motor assembly
- D-07 (2-GR) Rear dome light
- D-08 (3) Rear door switch (RH)
- D-09 (2-B) Rear wheel speed sensor (RH)
- D-10 (2-Y) Floor wiring harness and rear floor wiring harness (RH) combination
- D-11 (22) Floor wiring harness and rear floor wiring harness (RH) combination

- D-12 (1-GR) Floor wiring harness and rear floor wiring harness (RH) combination
- D-13 (2) Fuel level sensor (sub)
- D-14 (12) Receiver antenna assembly
- D-15 (2-Y) Floor wiring harness and rear floor wiring harness (LH) combination
- D-16 (18) Floor wiring harness and rear floor wiring harness (LH) combination
- D-17 (24-BR) Floor wiring harness and rear floor wiring harness (LH) combination
- D-18 (2-B) Rear wheel speed sensor (LH)
- D-19 (3) Rear door switch (LH)
- D-20 (2-B) Washer motor
- D-21 (3-B) Fuel tank differential pressure sensor

AC708219AB



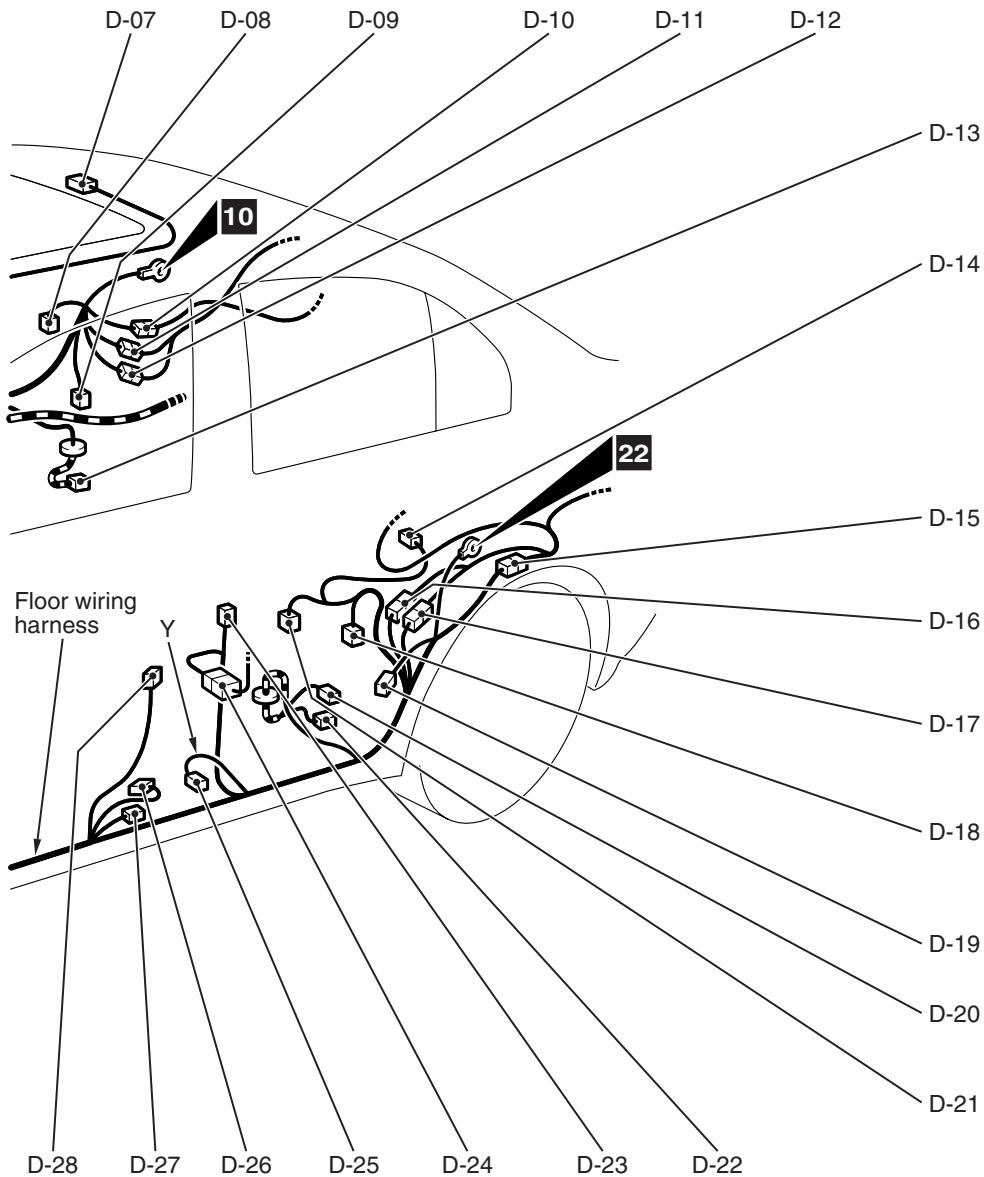

AC708220AB

D-22	(5-GR)	Fuel pump module	D-33	(4-B)	Seat belt switch (Driver's side)
D-23	(3)	Outside transmission antenna assembly (Driver's side)	D-34	(2-Y)	Side-airbag module (squib) (LH)
D-24	(10)	Floor wiring harness and rear door wiring harness (LH) combination	D-35	(4-B)	Heated oxygen sensor (Rear)
D-25	(2-B)	Seat belt pre-tensioner (LH)	D-36	(2-Y)	Side-airbag module (squib) (RH)
D-26	(2-Y)	Side impact sensor (LH)	D-37	(2-B)	Seat belt switch (Passenger's side)
D-27	(12-B)	Joint connector (5)	D-38	(4-B)	Heated seat assembly (RH)
D-28	(3)	Front door switch (LH)	D-39	(6)	Front seat assembly (RH)
D-29	(18)	Audio amplifier	D-40	(2-B)	Seat belt pre-tensioner (RH)
D-30	(14)	Audio amplifier	D-41	(2-Y)	Side impact sensor (RH)
D-31	(4-B)	Heated seat assembly (LH)	D-42	(3)	Outside transmission antenna assembly (Passenger's side)
D-32	(2-GR)	Seat slide sensor	D-43	(3)	Front door switch (RH)

DOOR

M1801001402310

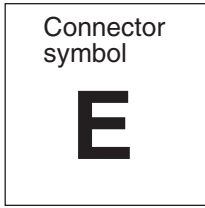

FRONT DOOR

(Driver's side)

(Passenger's side)

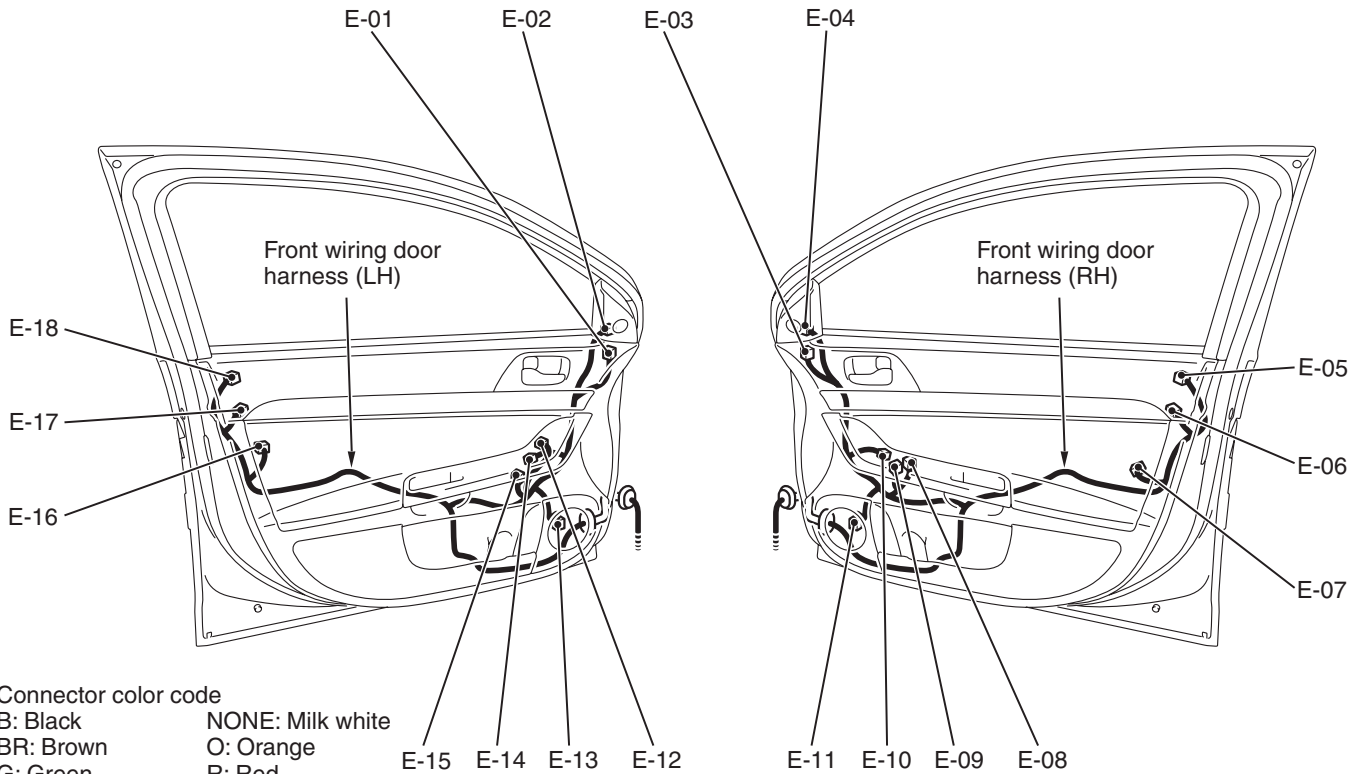

AC605712AC

- |      |        |  |      |        |                                 |
|------|--------|--|------|--------|---------------------------------|
| E-01 | (10)   | Door mirror assembly (LH)              | E-08 | (4)    | Front power window sub switch   |
| E-02 | (2-B)  | Tweeter (LH)                           | E-09 | (8)    | Front power window sub switch   |
| E-03 | (10)   | Door mirror assembly (RH)              | E-10 | (6-GR) | Front power window motor (RH)   |
| E-04 | (2-B)  | Tweeter (RH)                           | E-11 | (2)    | Front door speaker (RH)         |
| E-05 | (6)    | Unlock sensor (RH) <Vehicles with KOS> | E-12 | (11-L) | Remote controlled mirror switch |
| E-06 | (2-GR) | Lock switch (RH) <Vehicles with KOS>   | E-13 | (2)    | Front door speaker (LH)         |
| E-07 | (6-B)  | Front door lock actuator (RH)          | E-14 | (6-GR) | Front power window motor (LH)   |
|      |        |  | E-15 | (19)   | Power window main switch        |

REAR DOOR

(LH)

(RH)

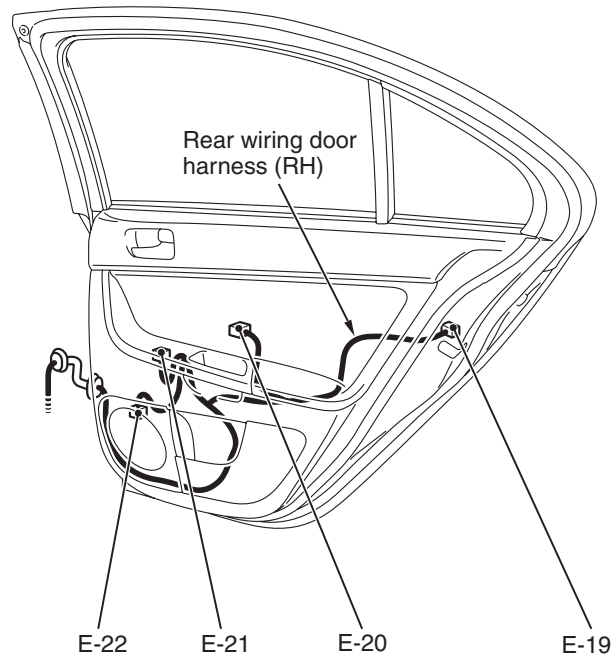
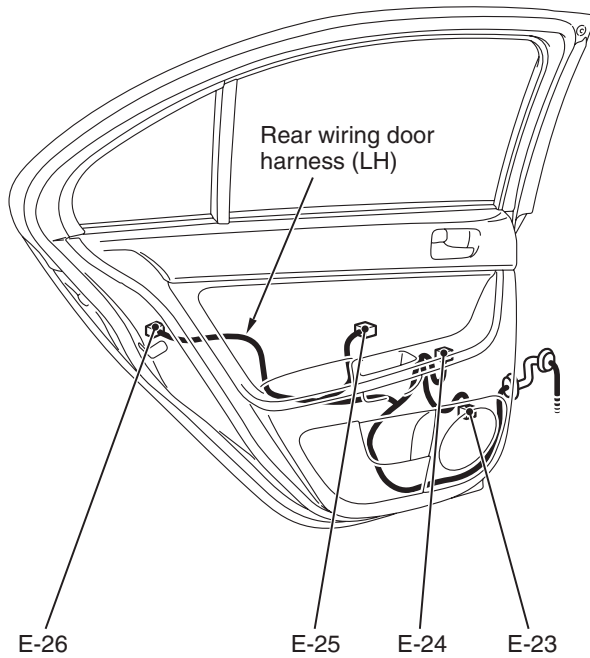

AC605713AE

- E-16 (6-B) Front door lock actuator (LH)
- E-17 (2-GR) Lock switch (LH) <Vehicles with KOS>
- E-18 (6) Unlock sensor (LH) <Vehicles with KOS>
- E-19 (6-B) Rear door lock actuator (RH)
- E-20 (6-GR) Rear power window motor (RH)

- E-21 (8) Rear power window sub switch (RH)
- E-22 (2) Rear door speaker (RH)
- E-23 (2) Rear door speaker (LH)
- E-24 (8) Rear power window sub switch (LH)
- E-25 (6-GR) Rear power window motor (LH)
- E-26 (6-B) Rear door lock actuator (LH)

## LUGGAGE COMPARTMENT

M1801001500902

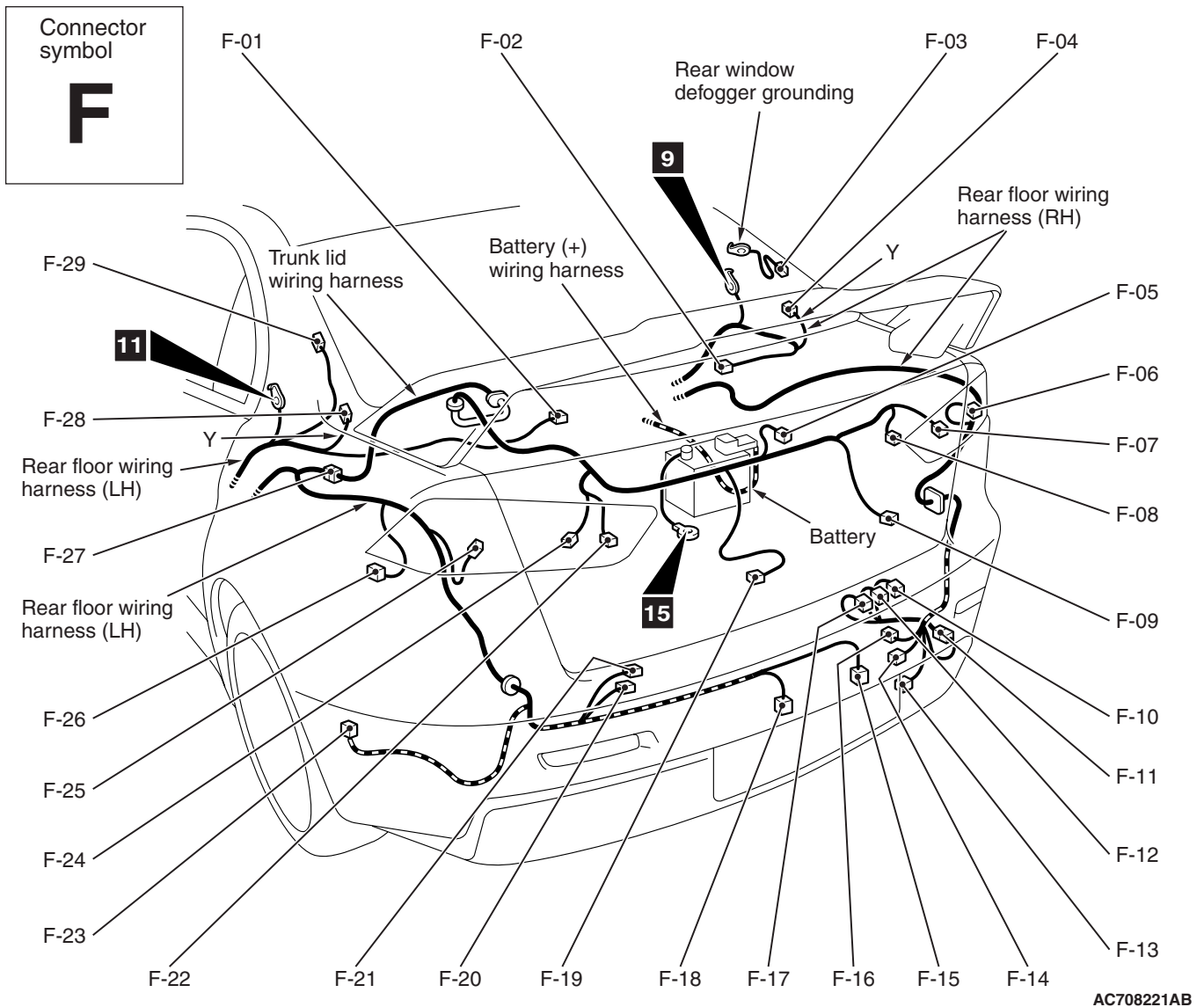

F-01	(2)	Luggage compartment light	F-17	(3-B)	Proportioning valve (for AYC control)
F-02	(3)	Inside transmission antenna assembly (Rear) <Vehicles with KOS>	F-18	(2-GR)	License plate light (LH)
F-03	(1-B)	Rear window defogger (-)	F-19	(3)	Trunk lid latch
F-04	(2-B)	Curtain air bag module (squib) (RH)	F-20	(3-GR)	Outside transmission antenna assembly (Trunk lid) <Vehicles with KOS>
F-05	(2-GR)	High-mounted stoplight	F-21	(2-GR)	Outer buzzer <Vehicles with KOS>
F-06	(4)	Rear combination light (RH)	F-22	(3-GR)	Backup light (LH)
F-07	(2-GR)	Taillight (RH)	F-23	(2-GR)	Evaporative emission ventilation solenoid
F-08	(3-GR)	Backup light (RH)	F-24	(2-GR)	Taillight (LH)
F-09	(2)	Trunk lid opener switch <Vehicles with KOS>	F-25	(4)	Rear combination light (LH)
F-10	(2-B)	Direction valve (LH)	F-26	(4-B)	Sub woofer <Vehicles with audio amplifier>
F-11	(4)	Rear floor wiring harness (RH) and AYC sub wiring harness combination	F-27	(10)	Rear floor wiring harness (LH) and trunk lid wiring harness combination
F-12	(2-B)	Direction valve (RH)	F-28	(2-B)	Curtain air bag module (squib) (LH)
F-13	(3-B)	Pressure sensor	F-29	(1-B)	Rear window defogger (+)
F-14	(2-GR)	Electric pump			
F-15	(2-GR)	License plate light (RH)			
F-16	(3-B)	Proportioning valve (for ACD control)			