



Equipped with AEM DRYFLOW Filter
No Oil Required!

Kit Part Number: 21-678

2008 Mitsubishi Lancer Evolution X

CARB EO #: Pending

AEM Cold Air Intake Systems that are pending an Executive Order number (EO#) relating to exemptions under Section 27156 of the Vehicle Code from the California Air Resource Board (CARB) are for off-road use only in California, which may never be used on public highways.
© 2008, Advanced Engine Management, Inc. AEM is a registered trademark of Advanced Engine Management, Inc. All rights reserved.



Advanced Engine Management Inc.
2205 126th Street, Unit A
Hawthorne, CA 90250
Phone: 310.484.2322
<http://www.aempower.com>

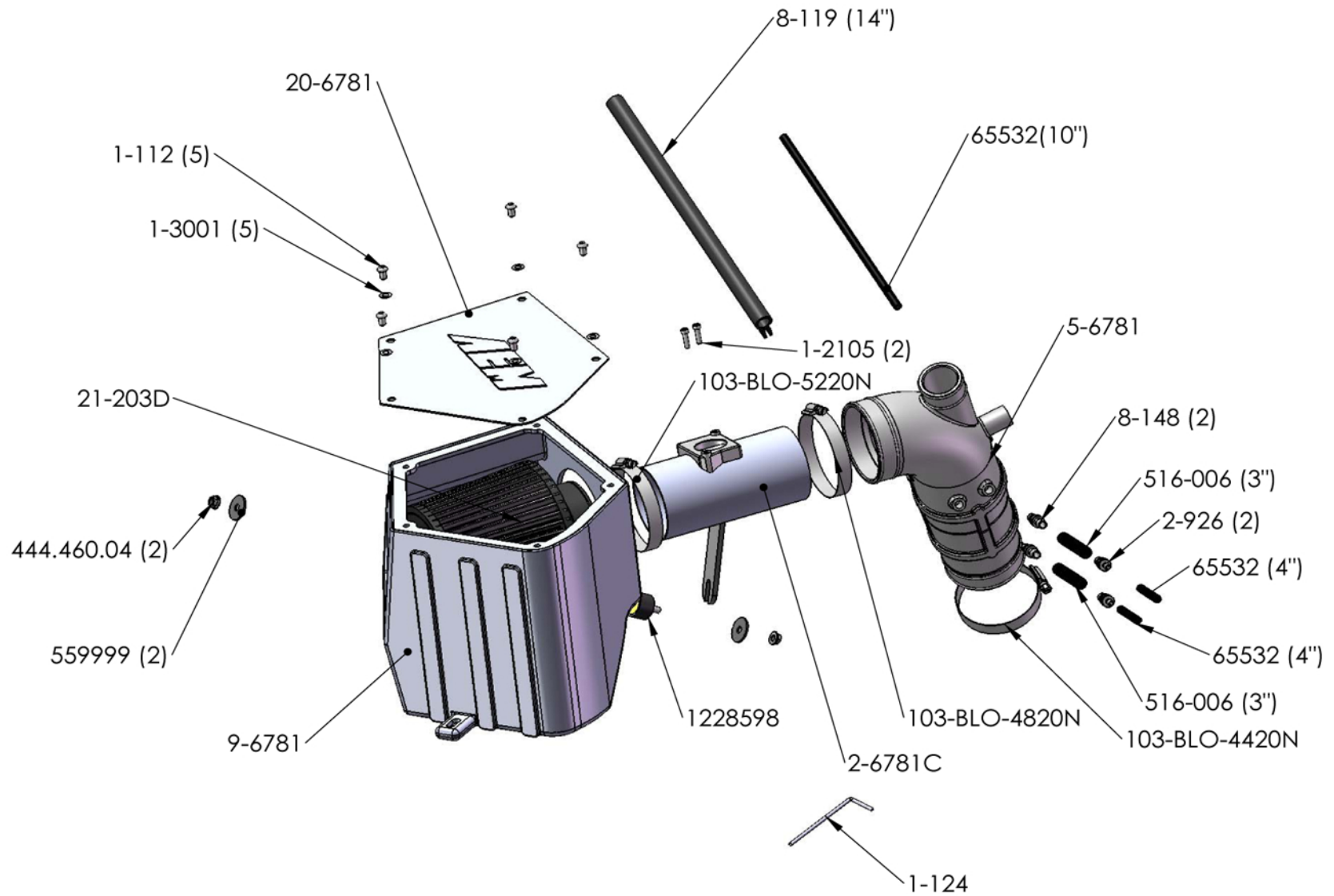

Bill of Materials

Quantity	Part Number	Part Description
1	9-6781	Airbox
1	2-6781C	Aluminum Inlet Pipe
1	20-6781	Airbox Lid
1	5-6781	Rubber Inlet Pipe
1	21-203D	3X5" Dryflow Filter
2	2-926	Connector, Aluminum 5/16"-5/32"
1	103-BLO-4420N	#44 Hose Clamp
1	103-BLO-4820N	#48 Hose Clamp
1	103-BLO-5220N	#52 Hose Clamp
2	8-148	Connector, Plastic 5/16"
14	8-119	Sponge Rubber Gasket
3	516-006	Hose,5/16ID
3	516-006	Hose,5/16ID
5	1-112	Button Head M6-1.0 X 10MM
5	1-3001	Nylon Washer
4	65532	Hose,5/32ID
4	65532	Hose,5/32ID
10	65532	Hose,5/32ID
1	1-124	T20 Tamper Resistant Torx
2	10-922	AEM Decal
1	10-6781	Instructions
2	1-2105	M4X.7 MAF Bolts
2	444.460.04	M6 Serrated Nut
2	559999	6mm Washer
1	1228598	5/8" X 6mm Rubber Mount

1. Preparing Vehicle

- a) Make sure vehicle is parked on a level surface.
- b) Set parking brake.
- c) If engine has run in the past two hours let it cool down.
- d) Disconnect the negative battery terminal.
- e) Do not discard stock components after removal of the factory system.

2. Removal of Stock System



a) Stock intake system.



b) Disconnect the mass air flow (MAF) sensor harness from the MAF sensor.



c) Using a small screwdriver disconnect the tree mount zip ties from the stock housing, there are two.



d) Remove the bolt securing the OE airbox to the vehicle.



e) Loosen the hose clamp securing the epdm inlet tube to the stock airbox assembly.



f) Remove the airbypass valve hose from the OE inlet by pulling it toward the passenger side of the vehicle.



g) Remove the two plastic rivets shown in the pictures.



h) Disconnect the OE inlet tube from the OE airbox and remove the airbox from the engine bay by pulling straight up.



i) Disconnect the airbypass valve hose from the airbypass valve.



j) Use pliers to decompress the hose clamp securing the vacuum line to the airbypass valve and move it away from the airbypass valve.



k) Disconnect the vacuum line from the airbypass valve.



l) Disconnect the PCV hose from the OEM inlet tube.



m) Disconnect the two vacuum lines connected to the wastegate solenoid, it connects to the inlet tube.



n) Loosen the hose clamp securing the inlet tube to the turbo inlet. Remove the inlet tube.



o) Remove the vacuum line from the vehicle that was connected to the airbypass valve.



p) Remove the airbypass valve from the inlet by loosening the hose clamp on the inlet tube.



q) Remove the hose clamp from the inlet tube.



r) Remove the MAF sensor from the airbox housing using the supplied tamper proof torx tool.



s) Unclip the two clips holding the airbox housing together. And disassemble the airbox.



t) Remove the inlet duct from the airbox by squeezing the top two tabs and pushing out.



u) Remove the two grommets on the bottom of the airbox housing to be used later.

3. Installation of Cold Air Intake System.

- a) When installing the intake system , DO NOT completely tighten the hose clamps or mounting tab hardware until instructed to do so.



b) Install the supplied rubber mount. The rubber mount should be located on the outside of the airbox. The washer and supplied nut should secure it from the inside of the airbox.



c) The inlet duct should snap into place in the oval opening, and install the edge trim around the circular hole on the back of the airbox.



d) Install the two OE rubber grommets removed in step 2(u) in the two holes on the bottom of the AEM airbox.



e) Place the AEM airbox in the vehicle aligning the two rubber grommets on the bottom with the two dowels on the airbox mount in the car.

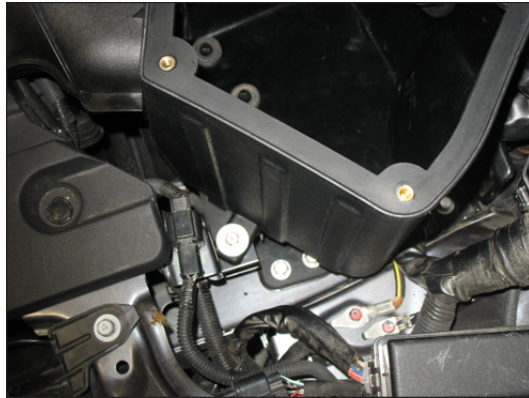

f) Align the tab on the airbox with the mounting location of the OE airbox and use the same bolt removed in step 2(d).



g) Secure the inlet duct using the plastic rivets removed in step 2(g).



h) Insert the two white connectors into the epdm inlet hose. (Note: Using glass cleaner to lubricate the parts will help with installation.)



i) Install the air bypass valve into the epdm inlet hose and secure with the OE hose clamp.



j) Create an assembly with the 5/16" ID hose and the two aluminum transition couplers, then connect the 5/16" ID hose to the two with connectors installed in step 3(h).



k) Install the MAF sensor in the aluminum inlet pipe and secure with the supplied socket bolts.

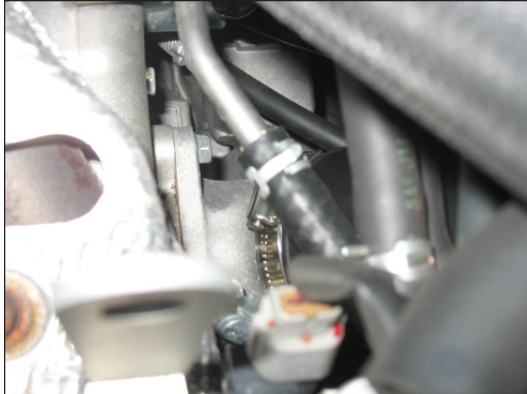

l) Install the epdm inlet into the vehicle with the air bypass valve toward the top of the engine. Loosely secure the inlet to the turbo inlet with the #44 hose clamp supplied.



m) Install the PCV hose into the EPDM inlet hose.



n) Connect the two 5/32" ID hoses to the two nipples on the wastegate actuator exposed in step 2(m). And, then connect the hoses to the two aluminum connectors on the rubber inlet.



o) Install the aluminum inlet pipe into the epdm inlet pipe, secure it with a #48 hose clamp and align the bracket with the rubber mount installed in step 3(b).



p) Reconnect the bypass hose to the bypass valve, and secure it using the OE hose clamp.



q) Install the AEM dryflow air filter onto the end of the aluminum inlet pipe as shown, and secure it with a #52 hose clamp. And, reconnect the MAF sensor harness.

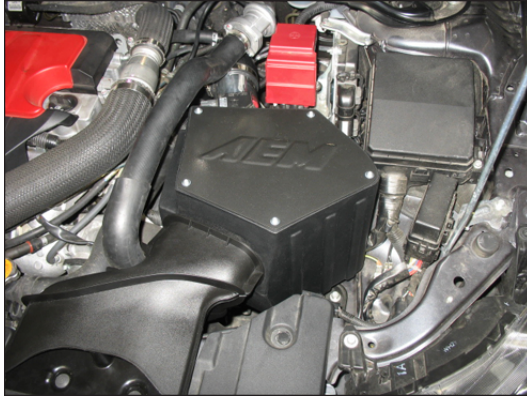

r) Align the holes in the AEM aluminum lid with the threaded holes in the airbox. Use the 5 supplied button head screws and plastic washers to secure the lid to the airbox as shown.

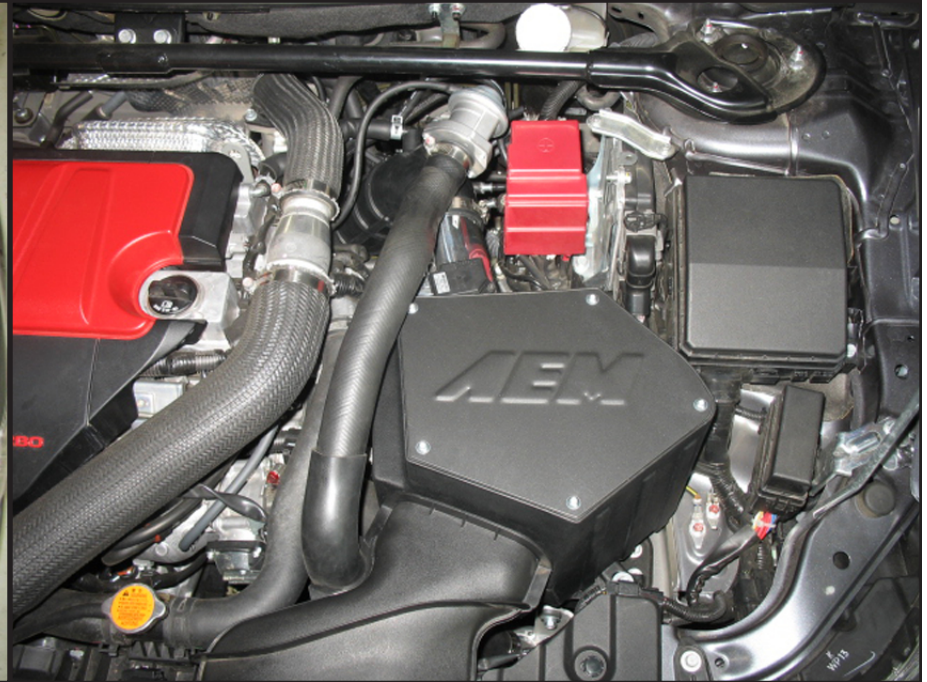

s) Use the supplied 10' of 5/32' ID hose to connect the bypass valve and the vacuum tubing exposed in step 2(o).

**Stock Intake Installed****AEM Cold Air Intake System Installed**

4. Reassemble Vehicle

- a) Position the inlet pipes for best fitment. Be sure that the pipes or any other components do not contact any part of the vehicle. Tighten the rubber mount, all bolts and hose clamps.
- b) Check for proper hood clearance. Readjust pipes if necessary and re-tighten them.
- c) Inspect the engine bay for any loose tools and check that all fasteners that were moved or removed are properly tight.
- d) Reconnect the negative battery cable to the terminal.
- e) Start engine. Let car idle for 3 minutes. Perform a final inspection before driving vehicle.



5. Service and Maintenance

- a) It is recommended that you service you AEM dryflow filter every 20,000 miles for optimum performance. Use AEM Dryflow cleaning kit part #21-110.
 - b) Use aluminum polish to clean your polished AEM Cold Air intake pipe.
 - c) Use window cleaner to clean your powder coated AEM Cold Air intake pipe.
- (NOTE: DO NOT USE ALUMINUM POLISH ON A POWDER COATED AEM COLD AIR INTAKE PIPE)**

**For technical inquiries
e-mail us at
tech@aempower.com
or
call us at
310.484.2322 Option # 3**

AEM Air Intake System Warranty Policy

AEM warrants that its intake systems will last for the life of your vehicle. AEM will not honor this warranty due to mechanical damage (i.e. improper installation or fitment), damage from misuse, accidents or flying debris. AEM will not warrant its powdercoating if the finish has been cleaned with a hydrocarbon-based solvent. The powdercoating should only be cleaned with a mild soap and water solution. Proof of purchase of both the vehicle and AEM intake system is required for redemption of a warranty claim.

This warranty is limited to the repair or replacement of the AEM part. In no event shall this warranty exceed the original purchase price of the AEM part nor shall AEM be responsible for special, incidental or consequential damages or cost incurred due to the failure of this product. Warranty claims to AEM must be transportation prepaid and accompanied with dated proof of purchase. This warranty applies only to the original purchaser of product and is non-transferable. Improper use or installation, use for racing, accident, abuse, unauthorized repairs or alterations voids this warranty. AEM disclaims any liability for consequential damages due to breach of any written or implied warranty on all products manufactured by AEM. Warranty returns will only be accepted by AEM when accompanied by a valid Return Merchandise Authorization (RMA) number. Credit for defective products will be issued pending inspection. Product must be received by AEM within 30 days of the date RMA is issued.

If you have a warranty issue, please call (310) 484-2322, extension 203 and our customer service department will assist you. A proof of purchase is required for all AEM warranty claims.