

## GROUP 80A

# CONFIGURATION DIAGRAMS

## CONTENTS

OVERALL CONFIGURATION DIAGRAM <NON-TURBO> .....	80A-2	ENGINE AND TRANSAXLE <NON-TURBO> .....	80A-10
OVERALL CONFIGURATION DIAGRAM <TURBO>.....	80A-3	ENGINE AND TRANSAXLE <TURBO> .....	80A-14
HOW TO READ CONFIGURATION DIAGRAMS .....	80A-4	DASH PANEL.....	80A-18
ENGINE COMPARTMENT <NON-TURBO> .....	80A-6	FLOOR AND ROOF .....	80A-24
ENGINE COMPARTMENT <TURBO>.....	80A-8	DOOR .....	80A-26
		LIFTGATE.....	80A-28

## OVERALL CONFIGURATION DIAGRAM &lt;NON-TURBO&gt;

M1801000102792

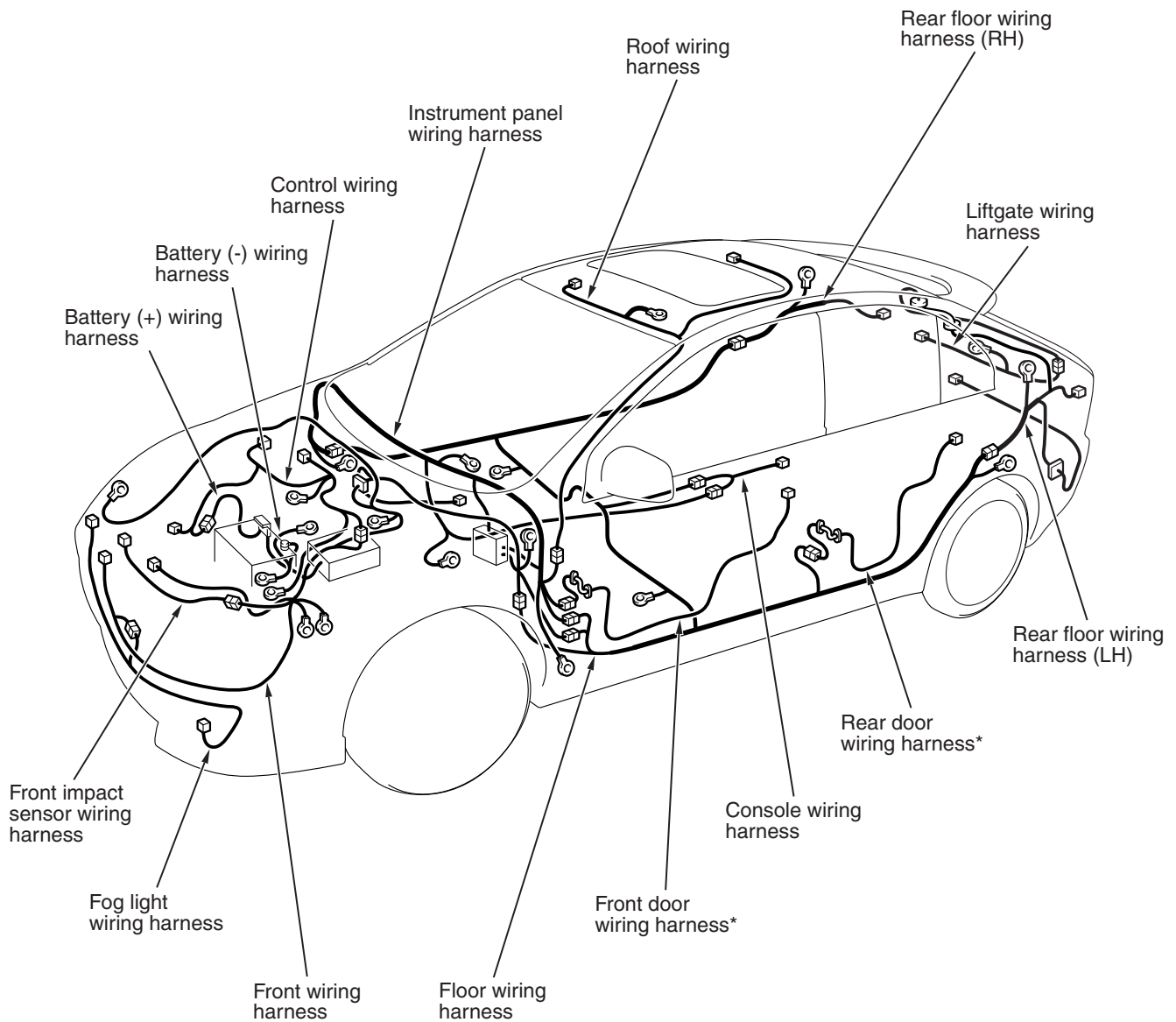

AC807031AB

**NOTE:**

1. This illustration shows only major wiring harnesses.
2. \*: also equipped at the right side.

# OVERALL CONFIGURATION DIAGRAM <TURBO>

M1801000102800

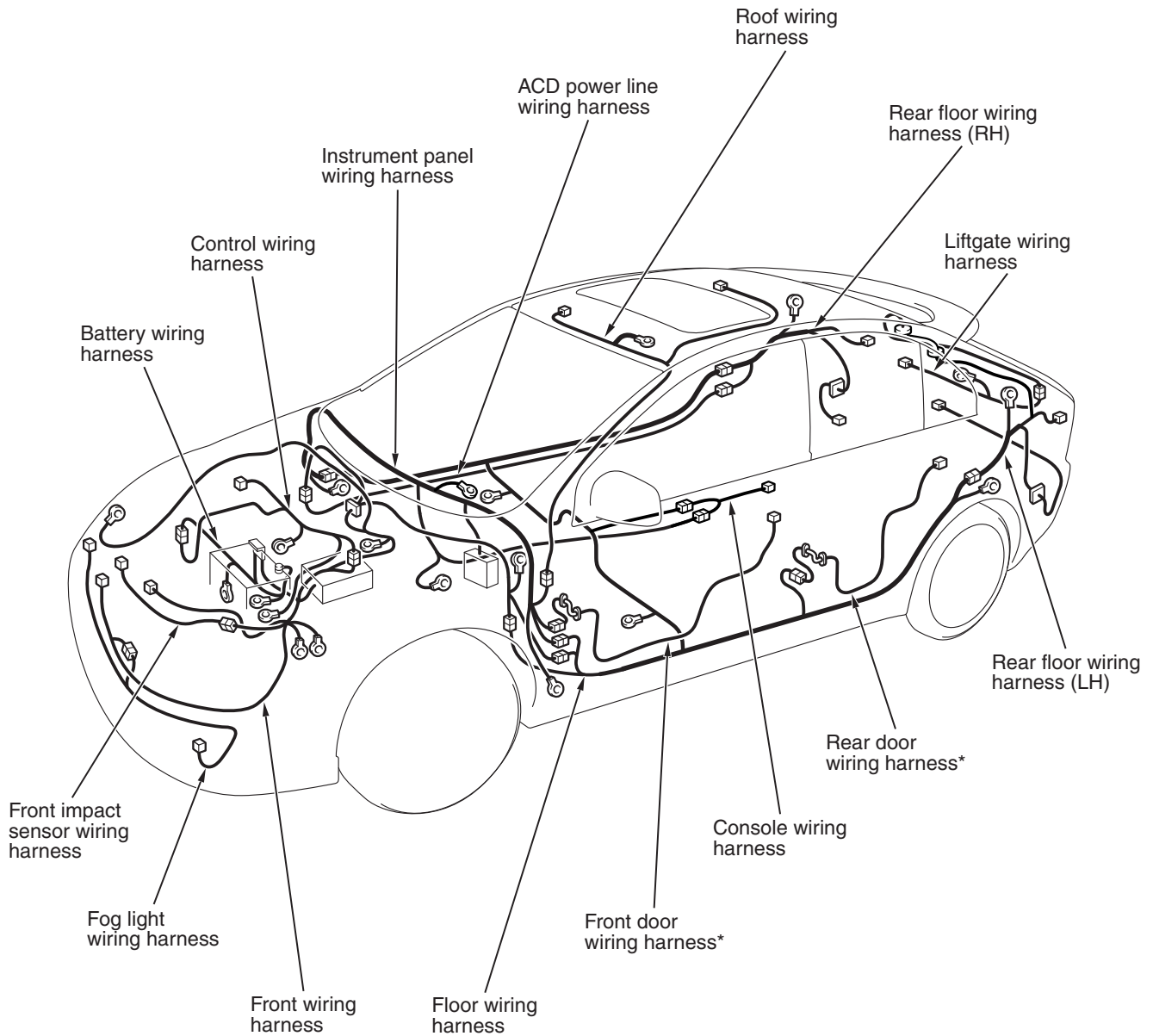

AC807032AB

**NOTE:**

1. This illustration shows only major wiring harnesses.
2. \*: also equipped at the right side.

# HOW TO READ CONFIGURATION DIAGRAMS

The wiring harness diagrams clearly show the connector locations and harness configurations on actual vehicles. Some variations are included in one configuration diagram. Accordingly, some diagrams may not be applicable for individual vehicles.

Denotes connector No.  
The same connector No. is used throughout the circuit diagrams to facilitate connector location searches.  
The first alphabetical symbol indicates the location site of the connector and a number that follows is the unique number.  
Numbers are usually assigned to parts in clockwise order on the diagram.

Example: A-19

- Number specific to connector (serial number)
- Connector location site symbol

A: ENGINE COMPARTMENT	D: FLOOR AND ROOF
B: ENGINE AND TRANSAXLE	E: DOOR
C: DASH PANEL	F: LIFTGATE

Denotes ground point.  
Same ground number is used throughout circuit diagrams to facilitate search of ground point.  
Refer to GROUP 70 COMPONENT LOCATIONS -GROUND MOUNTING LOCATIONS for details of ground points.

Denotes harness name.

Denotes a section covered by a corrugated tube.

The mark ★ shows the standard mounting position of wiring harness.

Denotes the color of the tube (If not specified, it is black).  
R: Red  
Y: Yellow

The number of connector pins and the connector color (except milk white)\* are shown for ease of retrieval.

Example: (2-B)

- Connector color (milk white if no color is indicated)
- Number of connector pins

\*: Typical connector colors

B: Black	BR: Brown
Y: Yellow	V: Violet
L: Blue	O: Orange
G: Green	GR: Gray
R: Red	None: Milk white

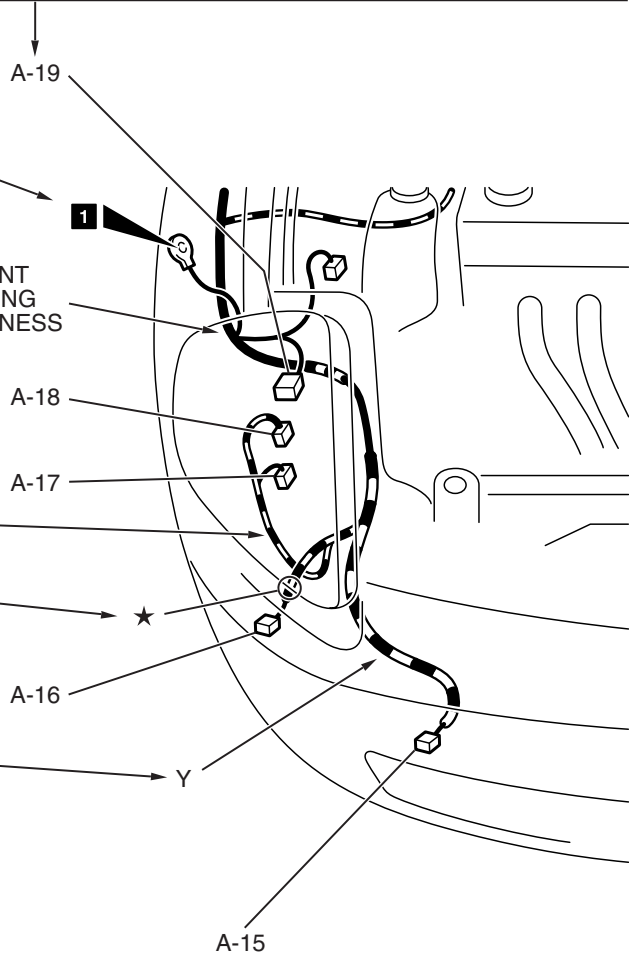

- A-15 (2) FOG LIGHT (RH)
- A-16 (2-GR) HORN (LOW)
- A-17 (2-B) HEADLIGHT (RH)
- A-18 (2-B) WINDSHIELD WASHER MOTOR
- A-19 (2-GR) DUAL PRESSURE SWITCH

Indicates the device to which the connector is connected.

NOTES

ENGINE COMPARTMENT <NON-TURBO>

M1801000306851

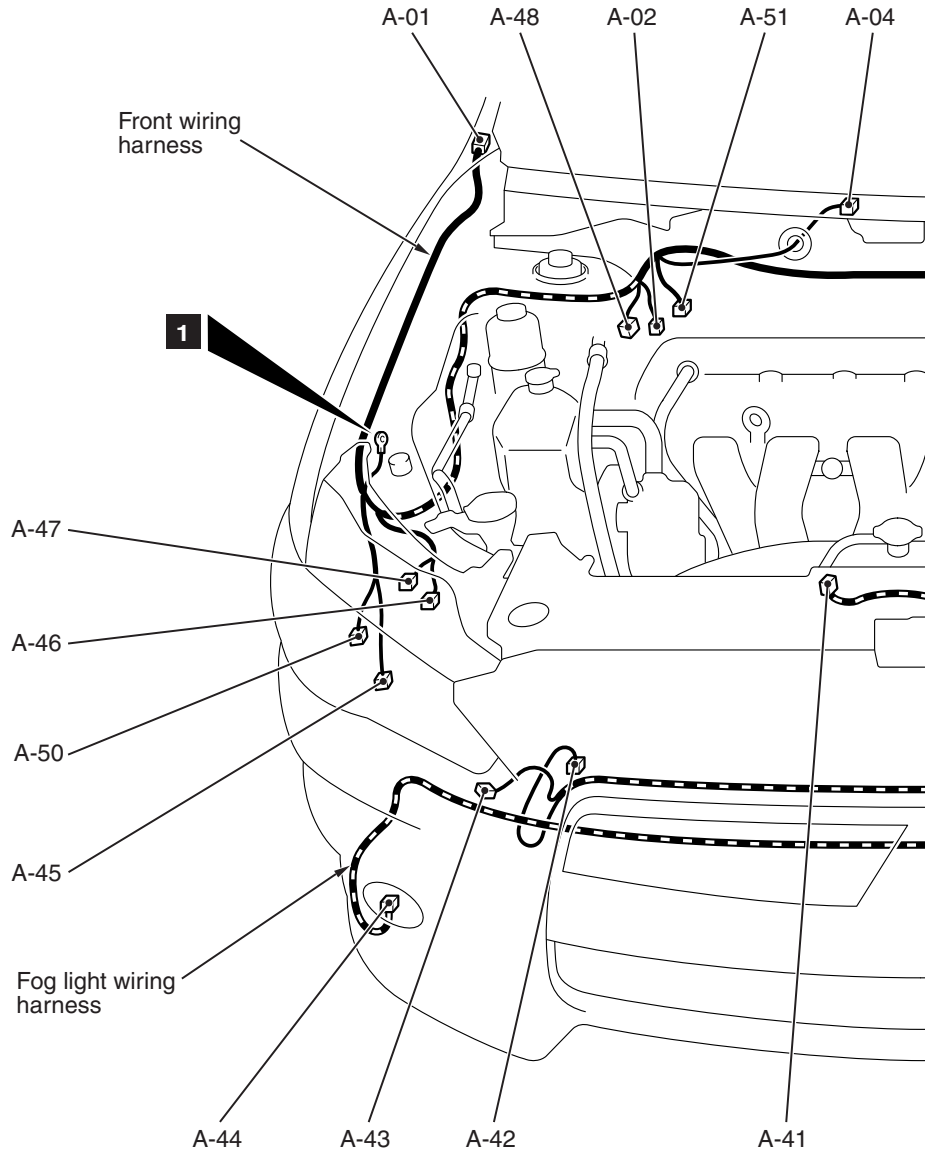
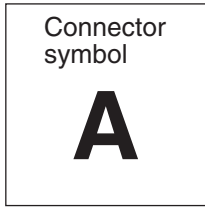

- Connector color code
- B: Black
  - BR: Brown
  - G: Green
  - GR: Gray
  - L: Blue
  - None: Milk white
  - O: Orange
  - R: Red
  - V: Violet
  - Y: Yellow

AC901339AB

A-01	(2-B)	Side turn-signal light (RH)	A-13X	(4)	A/C compressor clutch relay
A-02	(2-B)	Front wheel speed sensor (RH)	A-15X	(4)	CVT control relay
A-04	(5-GR)	Windshield wiper motor	A-16X	(4)	No connection
A-05	(4-GR)	Mass airflow sensor	A-17X	(4)	Headlight relay (High)
A-06	(2-B)	Brake fluid level switch	A-18X	(4)	Throttle actuator control motor relay
A-07	(2-B)	Front wheel speed sensor (LH)	A-20X	(4)	Daytime running light relay <Vehicles with discharge type headlight>
A-08	(2-B)	Side turn-signal light (LH)	A-21X	(4)	Injector relay
A-09	(24)	Front wiring harness and control wiring harness combination <CVT>	A-23X	(4)	Condenser fan relay
A-10	(20)	Front wiring harness and control wiring harness combination	A-24X	(4)	Starter relay
A-11X	(4)	Fog light relay	A-25X	(4)	Headlight relay (Low)
A-12X	(4)	Horn relay	A-26X	(4)	Radiator fan relay



ENGINE COMPARTMENT <TURBO>

M1801000306862

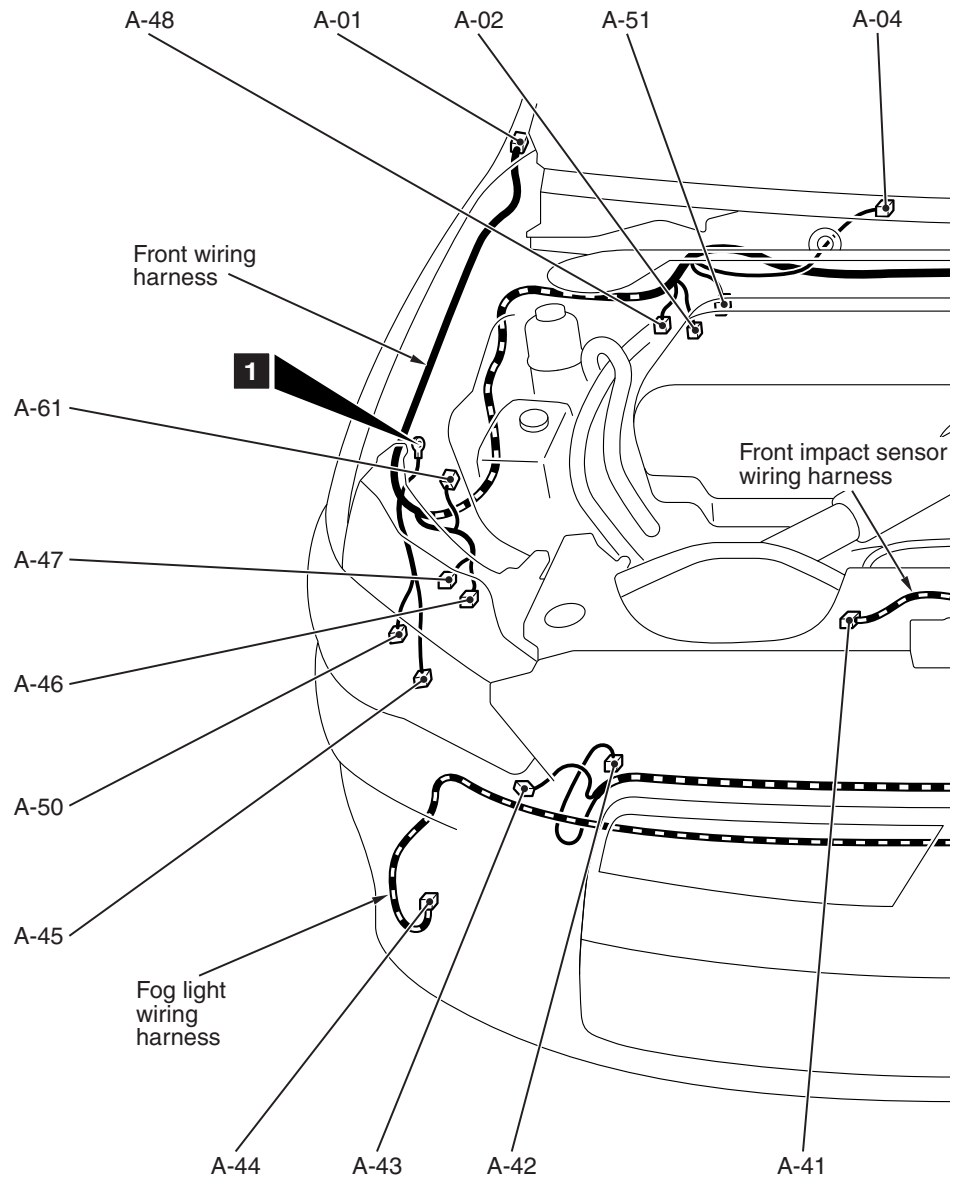
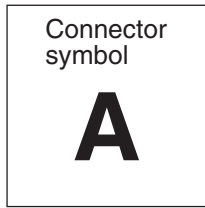

- Connector color code
- B: Black
  - BR: Brown
  - G: Green
  - GR: Gray
  - L: Blue
  - None: Milk white
  - O: Orange
  - R: Red
  - V: Violet
  - Y: Yellow

AC901342AB

A-01	(2-B)	Side turn-signal light (RH)	A-21X	(4)	Injector relay
A-02	(2-B)	Front wheel speed sensor (RH)	A-22X	(4)	Electric pump relay
A-04	(5-GR)	Windshield wiper motor	A-24X	(4)	Starter relay
A-05	(4-GR)	Mass airflow sensor	A-25X	(4)	Headlight relay (Low)
A-06	(2-B)	Brake fluid level switch	A-30X	(4)	MFI relay
A-07	(2-B)	Front wheel speed sensor (LH)	A-31	(12-B)	Headlight assembly (LH)
A-08	(2-B)	Side turn-signal light (LH)	A-32	(6-B)	Headlight assembly (LH)
A-11X	(4)	Fog light relay	A-33	(4-B)	Front wiring harness and front impact sensor wiring harness combination
A-12X	(4)	Horn relay	A-34	(2-B)	Fog light (LH)
A-13X	(4)	A/C compressor clutch relay	A-35	(2-B)	Radiator fan motor
A-16X	(4)	No connection	A-36	(2-B)	Ambient temperature sensor
A-17X	(4)	Headlight relay (High)	A-37	(1-B)	Horn (Low)
A-18X	(4)	Throttle actuator control motor relay			
A-20X	(4)	Daytime running light relay <Vehicles with discharge type headlight>			



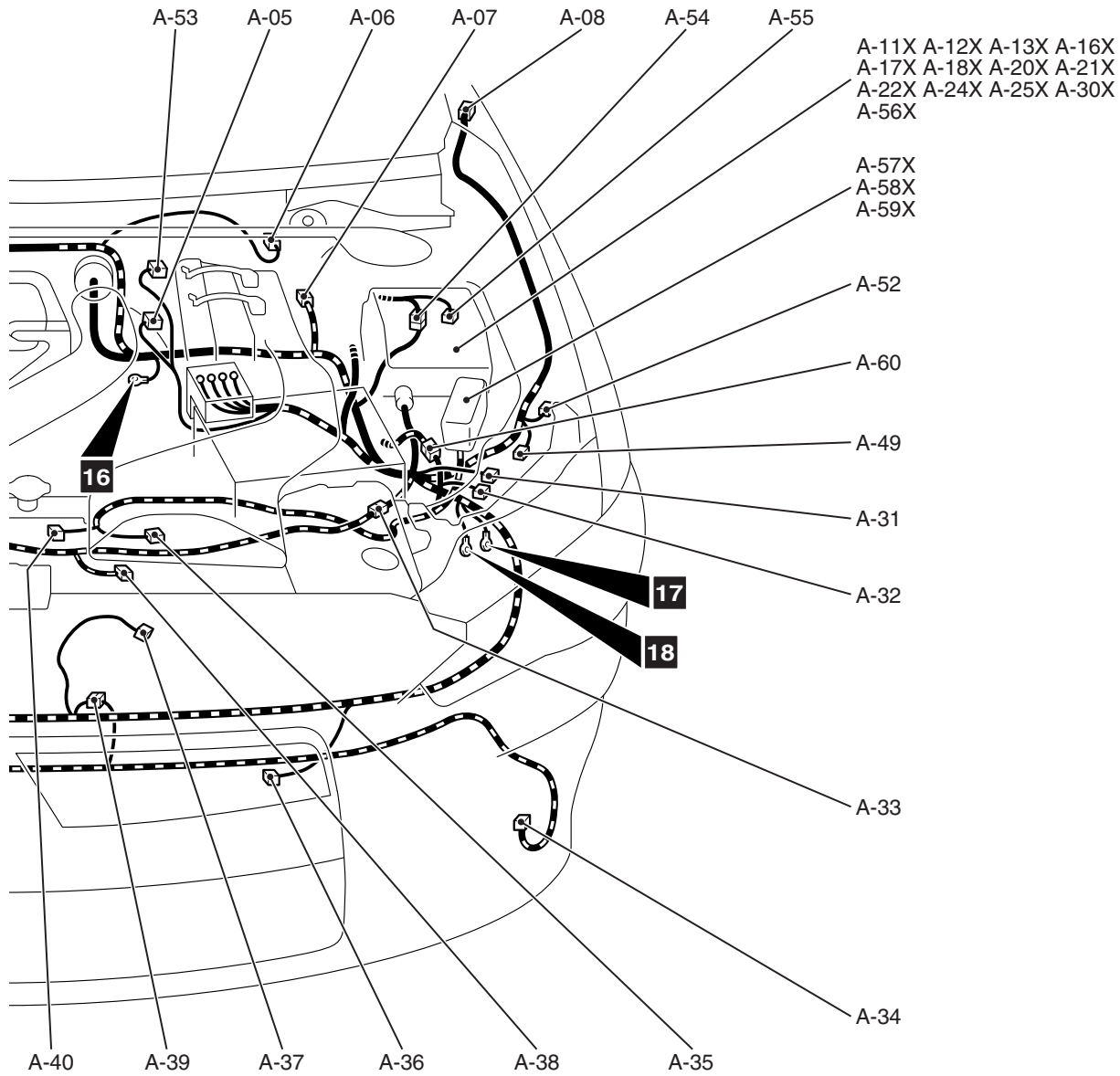

AC901343AB

A-38	(2-Y)	Front impact sensor (LH)	A-51	(47-B)	ASC-ECU
A-39	(2-B)	Front wiring harness and fog light wiring harness combination	A-52	(2-B)	No connection
A-40	(2-B)	Condenser fan motor	A-53	(2-GR)	Turbocharger wastegate solenoid
A-41	(2-Y)	Front impact sensor (RH)	A-54	(22)	Front wiring harness and control wiring harness combination
A-42	(3-B)	A/C pressure sensor	A-55	(24)	Joint connector (CAN4)
A-43	(1-B)	Horn (High)	A-56X	(4)	No.1 fuel pump relay
A-44	(2-B)	Fog light (RH)	A-57X	(4)	Radiator fan relay
A-45	(2-B)	Windshield washer motor	A-58X	(4)	Condenser fan relay
A-46	(6-B)	Headlight assembly (RH)	A-59X	(5)	Fan control relay
A-47	(12-B)	Headlight assembly (RH)	A-60	(6-B)	Front wiring harness and control wiring harness combination
A-48	(3-GR)	No connection	A-61	(2-B)	Fuel pump circuit resistor
A-49	(1-GR)	No connection			
A-50	(2-B)	No connection			

ENGINE AND TRANSAXLE <NON-TURBO>

M1801000403774

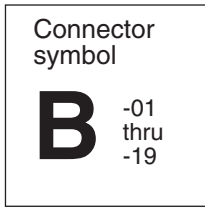

- Connector color code
- B : Black
  - BR : Brown
  - G : Green
  - GR : Gray
  - L : Blue
  - None : Milk white
  - O : Orange
  - R : Red
  - V : Violet
  - Y : Yellow

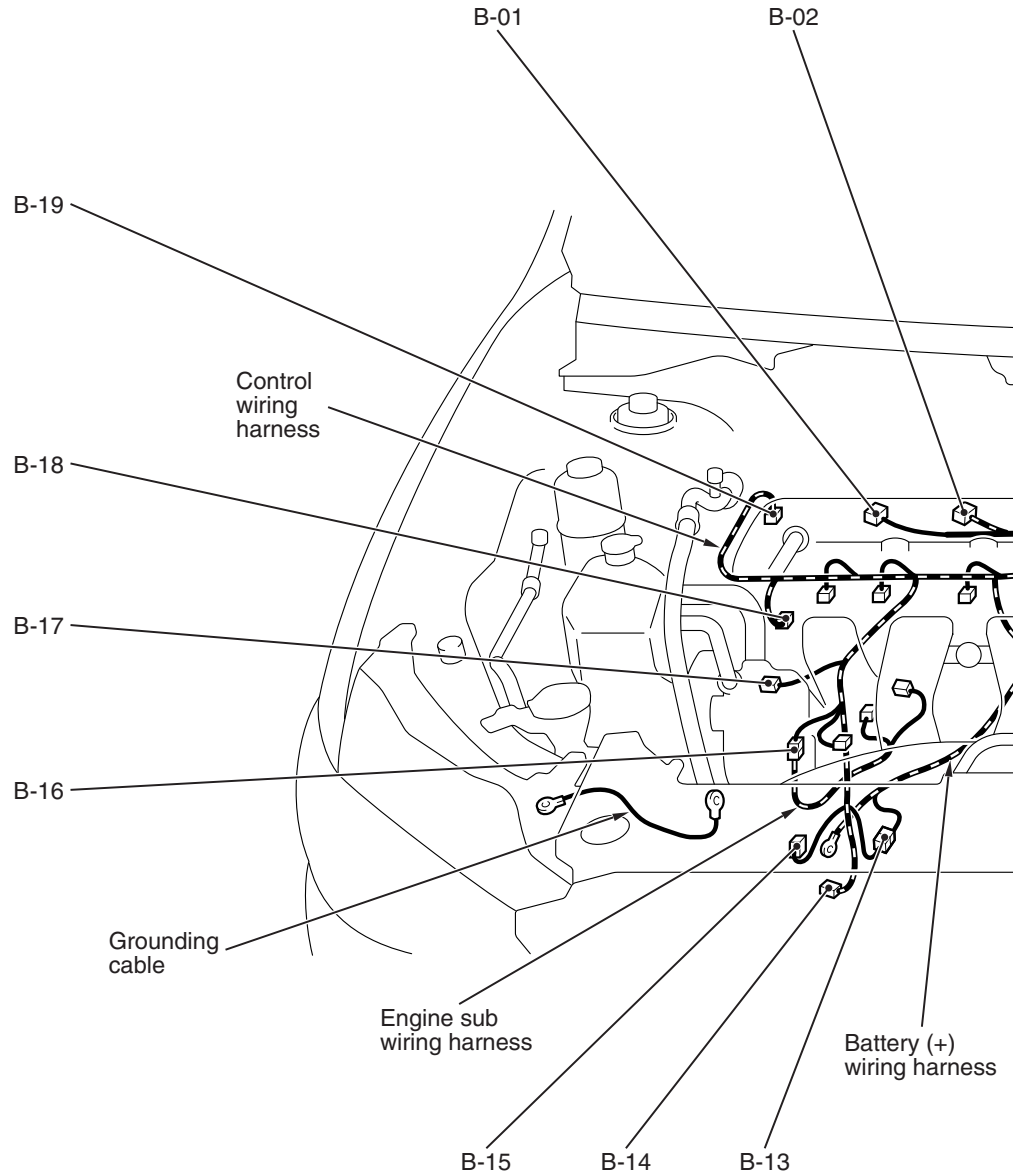

AC807019AB

- B-01 (3-B) No.1 ignition coil
- B-02 (3-B) No.2 ignition coil
- B-03 (3-B) No.3 ignition coil
- B-04 (3-B) No.4 ignition coil
- B-05 (4-B) Heated oxygen sensor (front)  
<Vehicles for California emission regulation>

- B-06 (2-B) Engine coolant temperature sensor
- B-07 (3-B) Primary pulley speed sensor <CVT>
- B-08 (22-B) CVT assembly
- B-09 (10-B) Transmission range switch <CVT>

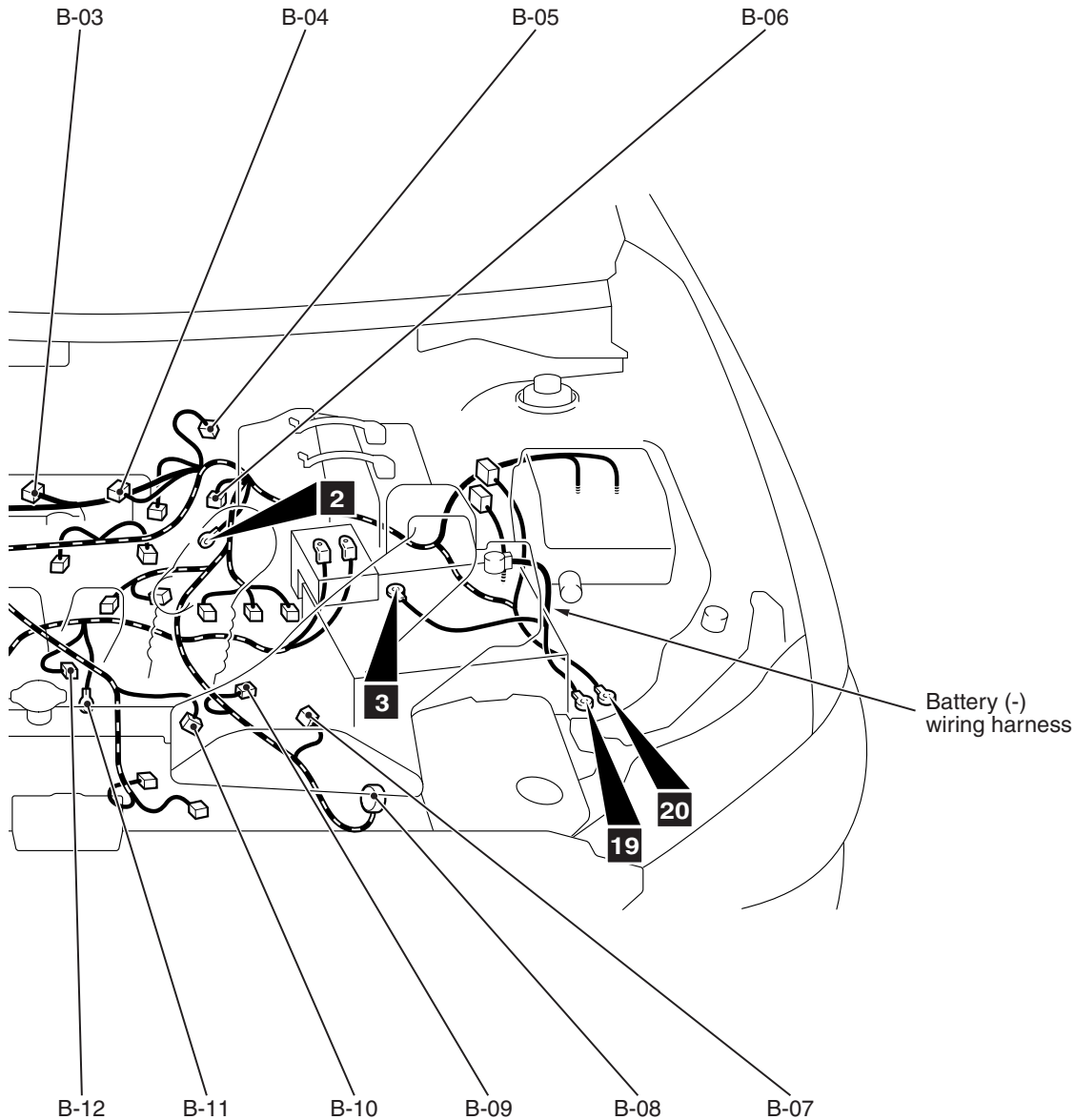

AC807020AB

B-10	(6-B)	Throttle body assembly	B-15	(4-GR)	Generator
B-11	(1)	Starter	B-16	(3-B)	Control wiring harness and engine sub wiring harness combination
B-12	(1-B)	Starter	B-17	(1-B)	Power steering pressure switch
B-13	(1-B)	Control wiring harness and battery (+) wiring harness combination	B-18	(2)	Intake engine oil control valve
B-14	(1-B)	A/C compressor clutch assembly	B-19	(2)	Exhaust engine oil control valve

ENGINE AND TRANSAXLE <NON-TURBO> (CONTINUED)

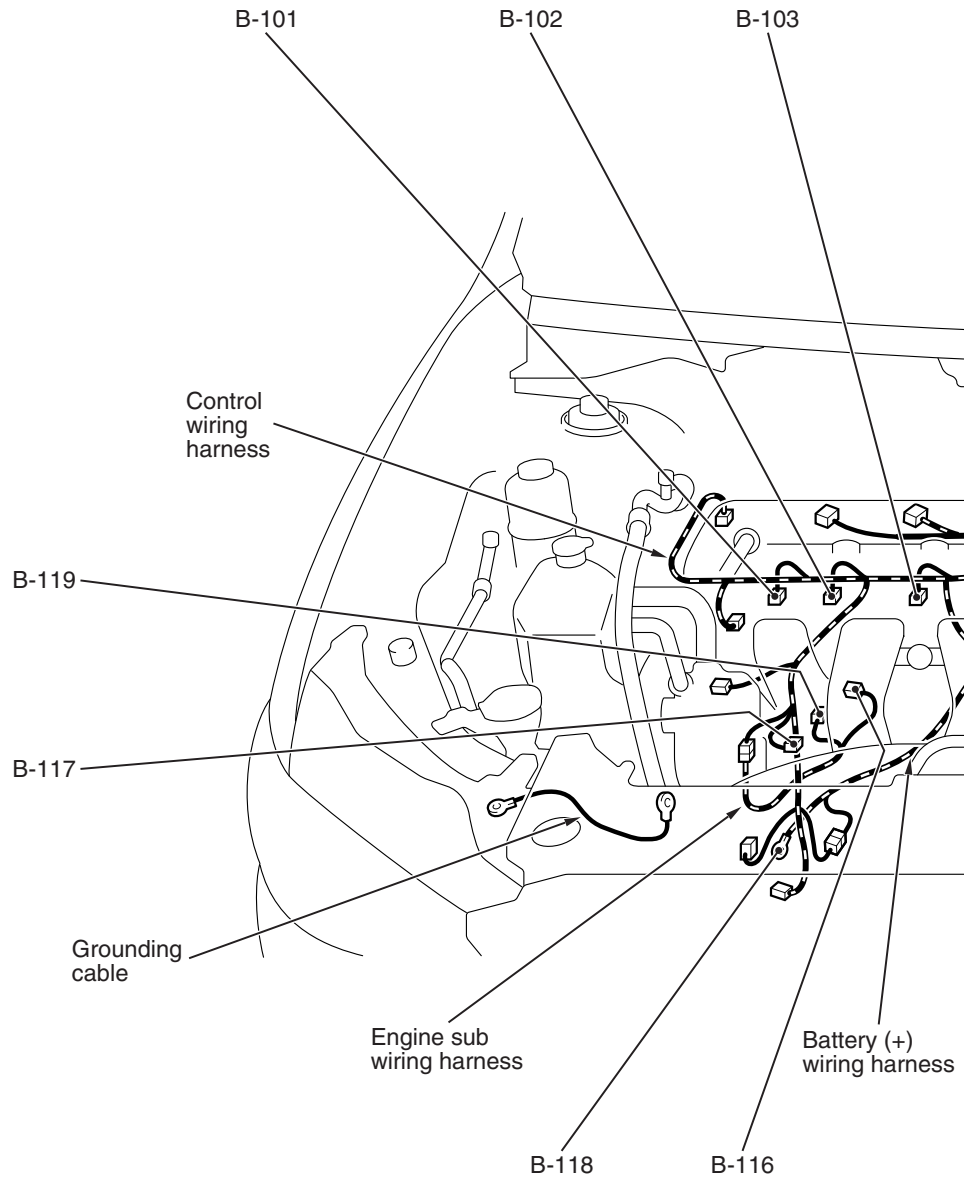
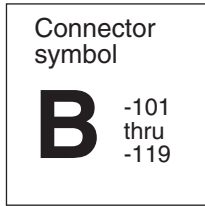

- Connector color code
- B : Black
  - BR : Brown
  - G : Green
  - GR : Gray
  - L : Blue
  - None : Milk white
  - O : Orange
  - R : Red
  - V : Violet
  - Y : Yellow

AC807019AC

- B-101 (2-GR) No.1 injector
- B-102 (2-GR) No.2 injector
- B-103 (2-GR) No.3 injector
- B-104 (2-GR) No.4 injector
- B-105 (3-GR) Crankshaft position sensor

- B-106 (3-GR) Intake camshaft position sensor
- B-107 (3-GR) Exhaust camshaft position sensor
- B-108 (64-GR) Engine control module
- B-109 (48-GR) Engine control module
- B-110 (2-B) Backup light switch <M/T>

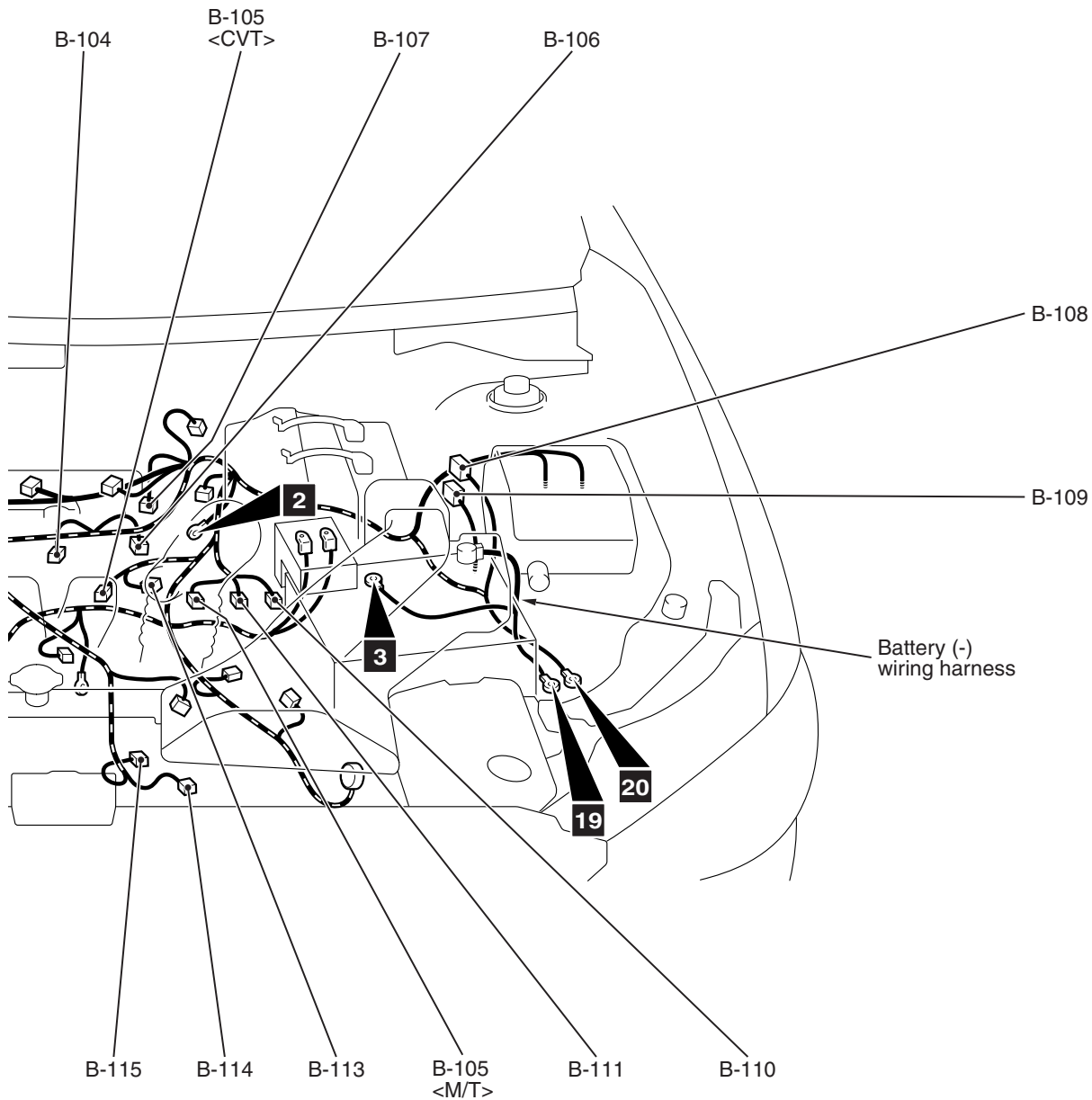

AC807020AC

- B-111 (3-B) Vehicle speed sensor <M/T>
- B-113 (3-B) Secondary pulley speed sensor <CVT>
- B-114 (6-GR) Exhaust gas recirculation valve
- B-115 (2-B) Evaporative emission purge solenoid

- B-116 (2-B) Knock sensor
- B-117 (3-B) Manifold absolute pressure sensor
- B-118 (1) Generator
- B-119 (1) Engine oil pressure switch

ENGINE AND TRANSAXLE <TURBO>

M1801000403785

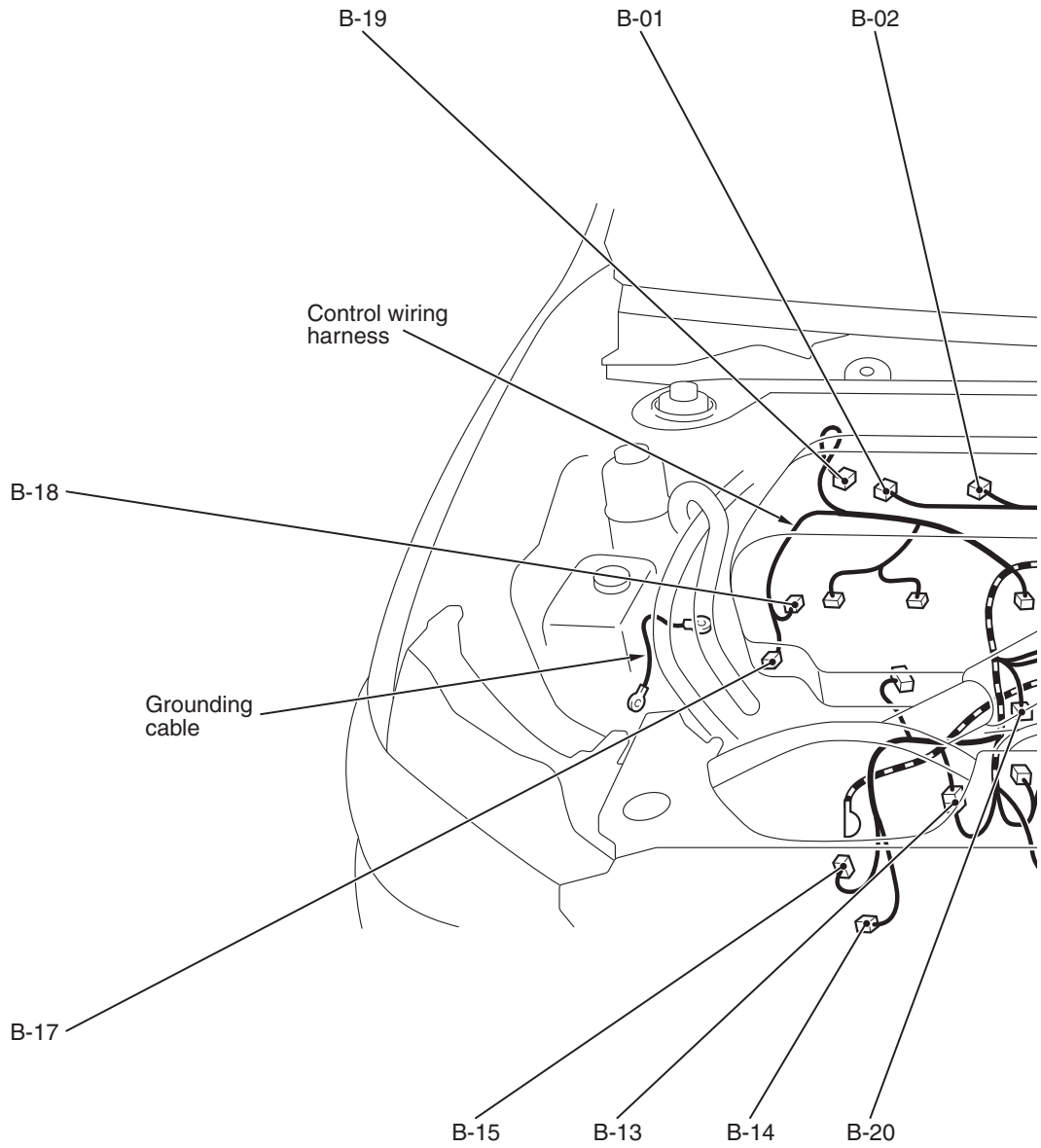
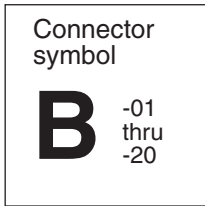

- Connector color code
- B: Black
  - BR: Brown
  - G: Green
  - GR: Gray
  - L: Blue
  - None: Milk white
  - O: Orange
  - R: Red
  - V: Violet
  - Y: Yellow

- B-01 (4-GR) No.1 ignition coil
- B-02 (4-GR) No.2 ignition coil
- B-03 (4-GR) No.3 ignition coil
- B-04 (4-GR) No.4 ignition coil

- B-06 (2-B) Engine coolant temperature sensor
- B-10 (6-B) Throttle body assembly
- B-11 (1) Starter
- B-12 (1-B) Starter

AC712278AD

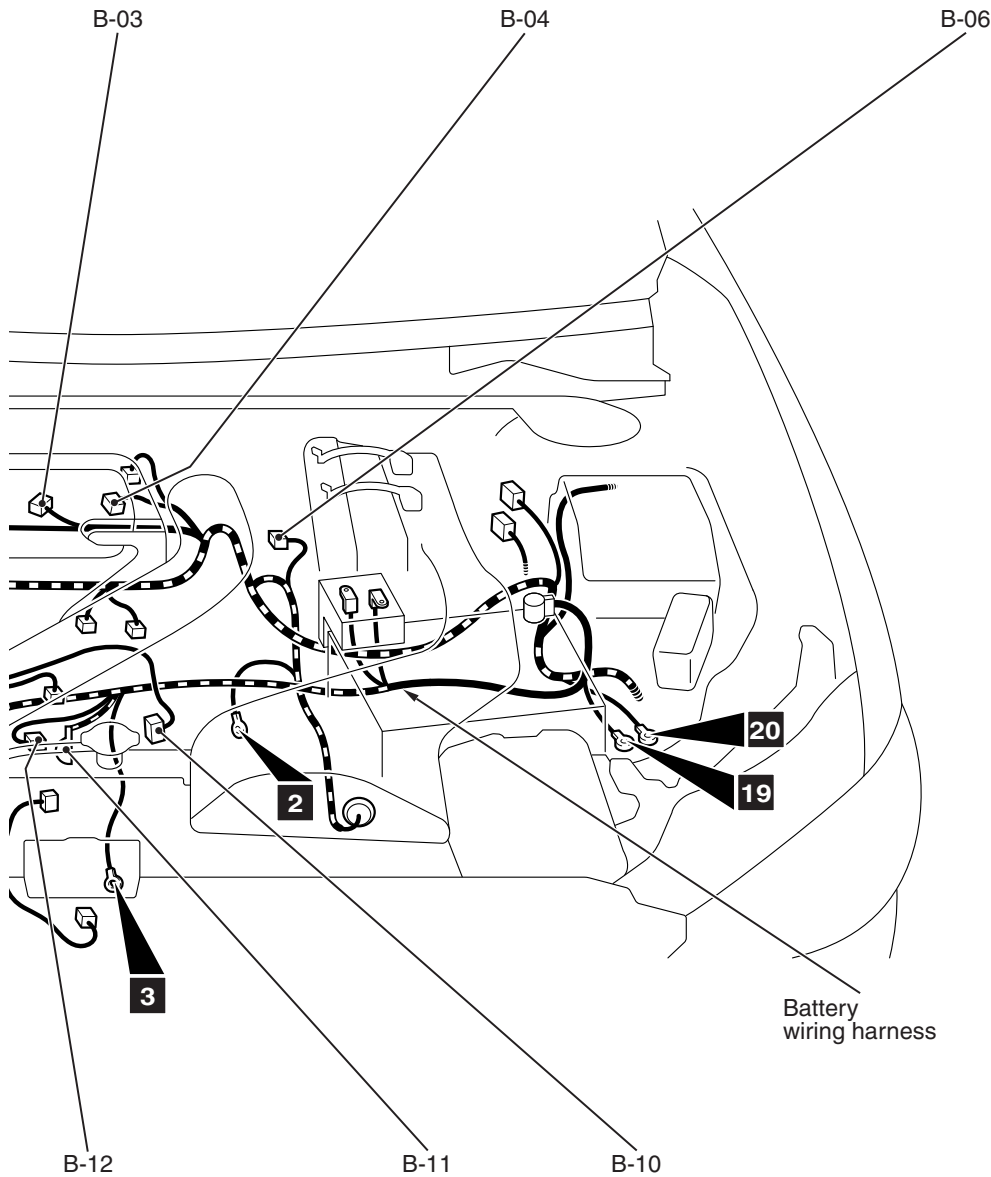

AC712279AD

- B-13 (1-B) Control wiring harness and battery wiring harness combination
- B-14 (1-B) A/C compressor clutch assembly
- B-15 (4-GR) Generator

- B-17 (1) Power steering pressure switch
- B-18 (2) Intake engine oil control valve
- B-19 (2) Exhaust engine oil control valve
- B-20 (2-B) No.2 intake air temperature sensor

ENGINE AND TRANSAXLE <TURBO> (CONTINUED)

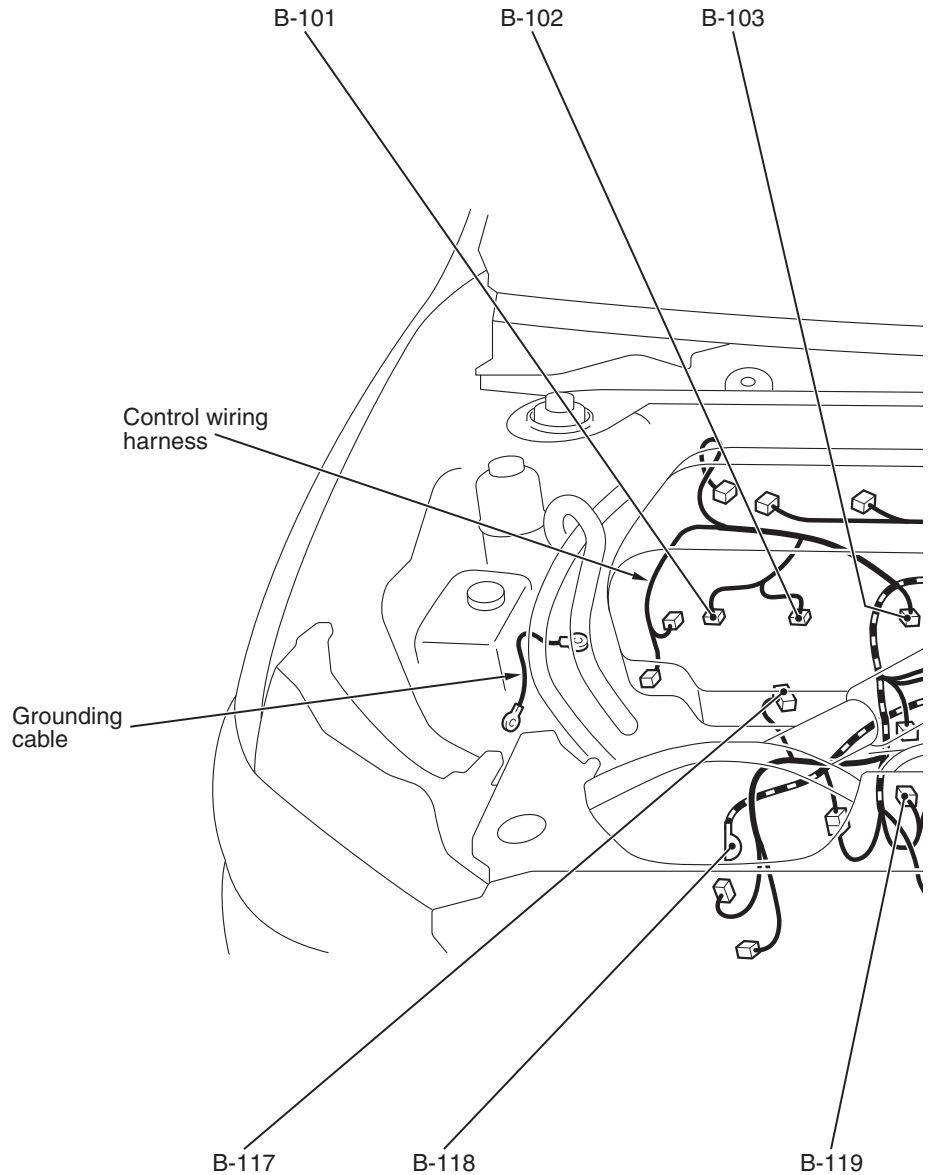
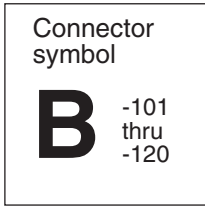

- Connector color code
- B: Black
  - BR: Brown
  - G: Green
  - GR: Gray
  - L: Blue
  - None: Milk white
  - O: Orange
  - R: Red
  - V: Violet
  - Y: Yellow

- B-101 (2-GR) No.1 injector
- B-102 (2-GR) No.2 injector
- B-103 (2-GR) No.3 injector
- B-104 (2-GR) No.4 injector
- B-105 (3-GR) Crankshaft position sensor

- B-106 (3-GR) Intake camshaft position sensor
- B-107 (3-GR) Exhaust camshaft position sensor
- B-108 (64-GR) Engine control module
- B-109 (48-GR) Engine control module

AC712278AE



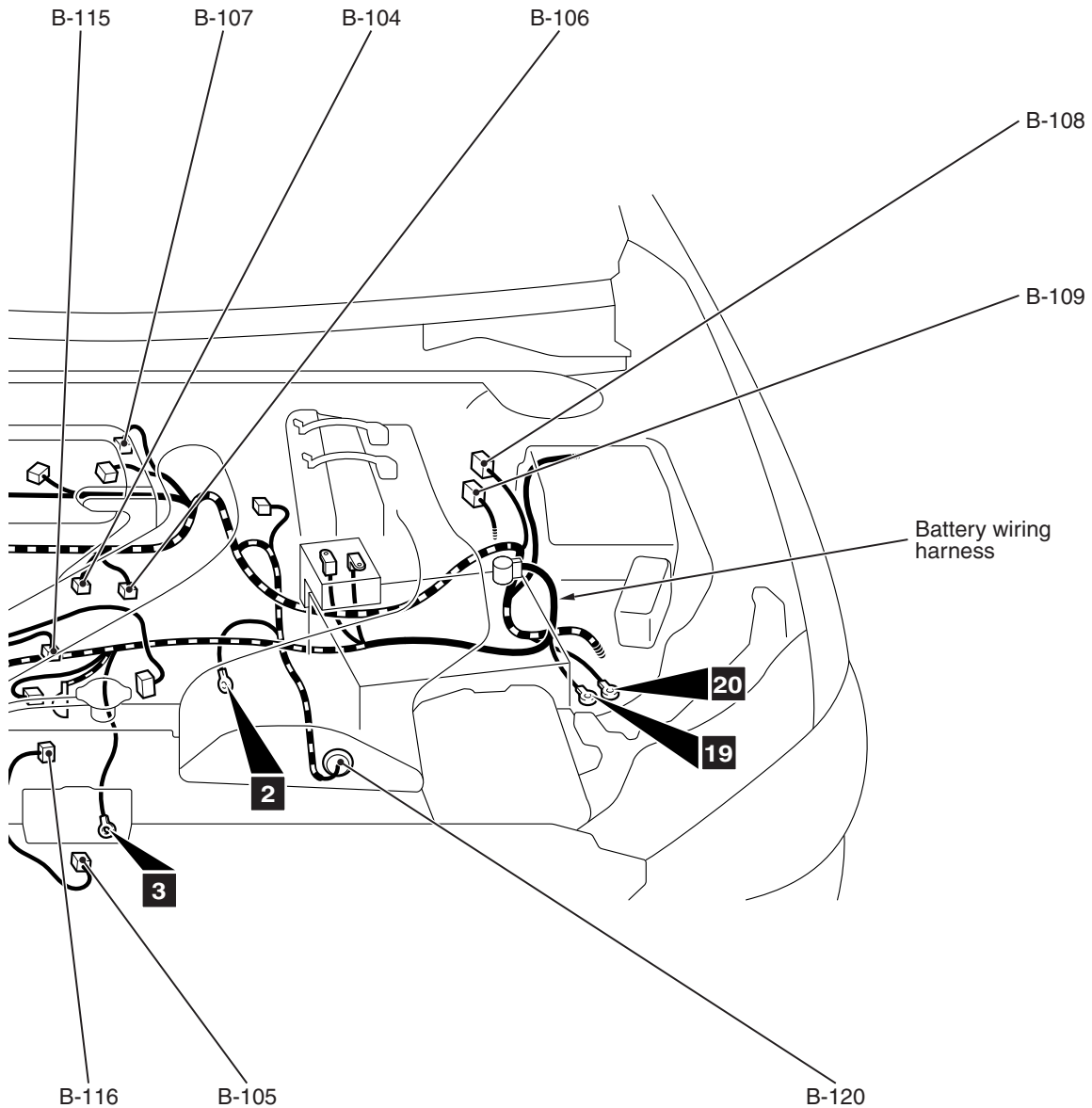

AC712279AE

B-115 (2-B) Evaporative emission purge solenoid  
 B-116 (2-B) Knock sensor  
 B-117 (3-B) Manifold absolute pressure sensor

B-118 (1) Generator  
 B-119 (1) Engine oil pressure switch  
 B-120 (20-B) Transaxle assembly

DASH PANEL

M1801000603938

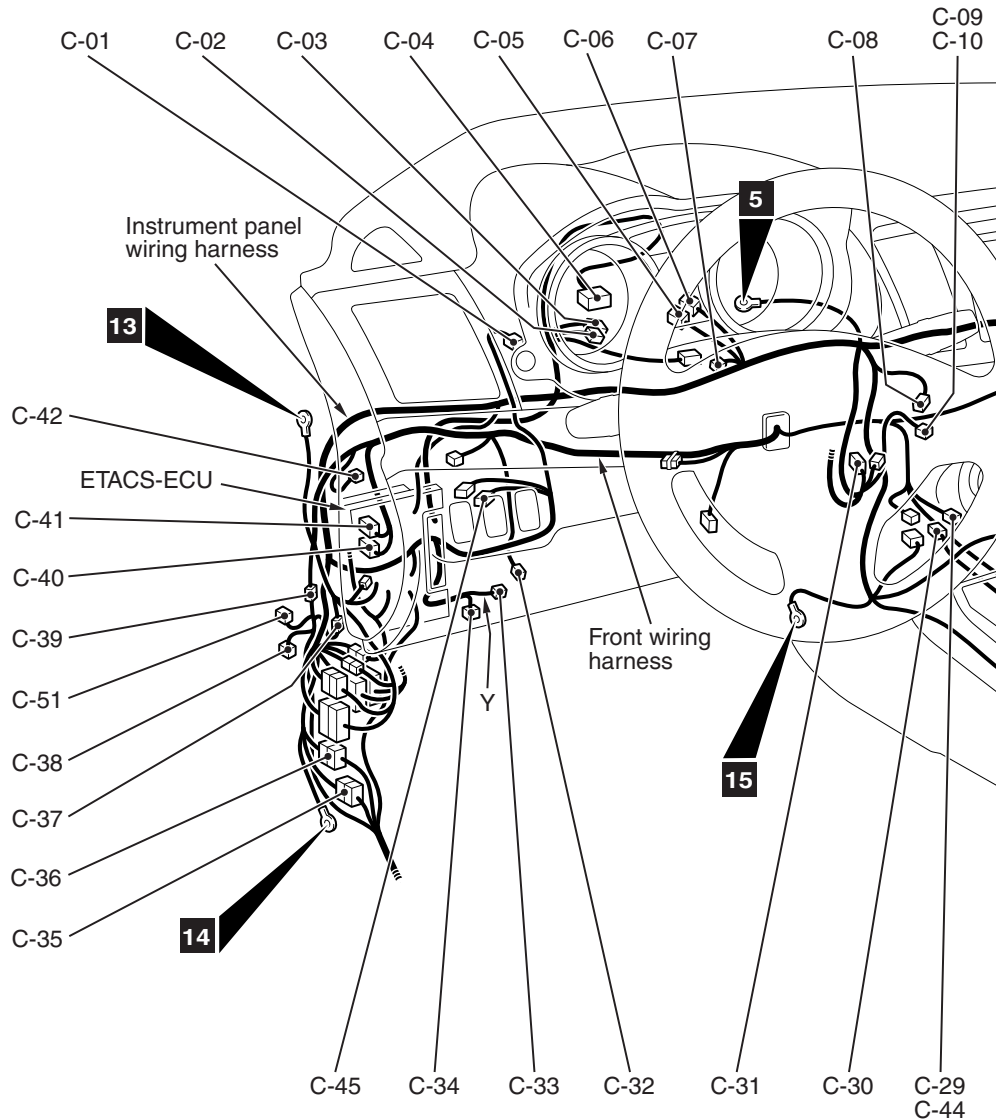
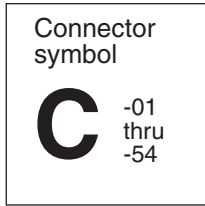

Connector color code  
B: Black  
BR: Brown  
G: Green  
GR: Gray  
L: Blue  
None: Milk white  
O: Orange  
R: Red  
V: Violet  
Y: Yellow

AC807022AB

C-01	(4)	Meter information switch	C-14	(17-GR)	Multivision display <Vehicles with MMCS>
C-02	(12)	Joint connector (2)	C-15	(2)	Radio antenna
C-03	(24)	Joint connector (1)	C-16	(4-Y)	Passenger's (front) air bag module (squib)
C-04	(24)	Combination meter	C-17	(14)	Satellite radio tuner
C-05	(24)	Joint connector (CAN2)	C-18	(16-B)	Center panel unit
C-06	(24)	Joint connector (CAN1)	C-19	(16-B)	A/C-ECU
C-07	(24)	Joint connector (3)	C-20	(20-B)	A/C-ECU
C-08	(2)	Interior temperature sensor	C-21	(20)	Instrument panel wiring harness and floor wiring harness combination
C-09	(12)	Wireless control module <Vehicles with WCM>	C-22	(22)	Instrument panel wiring harness and floor wiring harness combination
C-10	(12)	Receiver antenna module <Vehicles with KOS>	C-23	(9)	Heated seat switch
C-11	(7)	Multivision display <Vehicles with MMCS>	C-24	(2)	Accessory socket (rear floor console)
C-12	(32-GR)	Multivision display <Vehicles with MMCS>	C-25	(4)	Floor wiring harness and console wiring harness combination
C-13	(5-GR)	Multivision display <Vehicles with MMCS>	C-26	(6)	Instrument panel wiring harness and console wiring harness combination

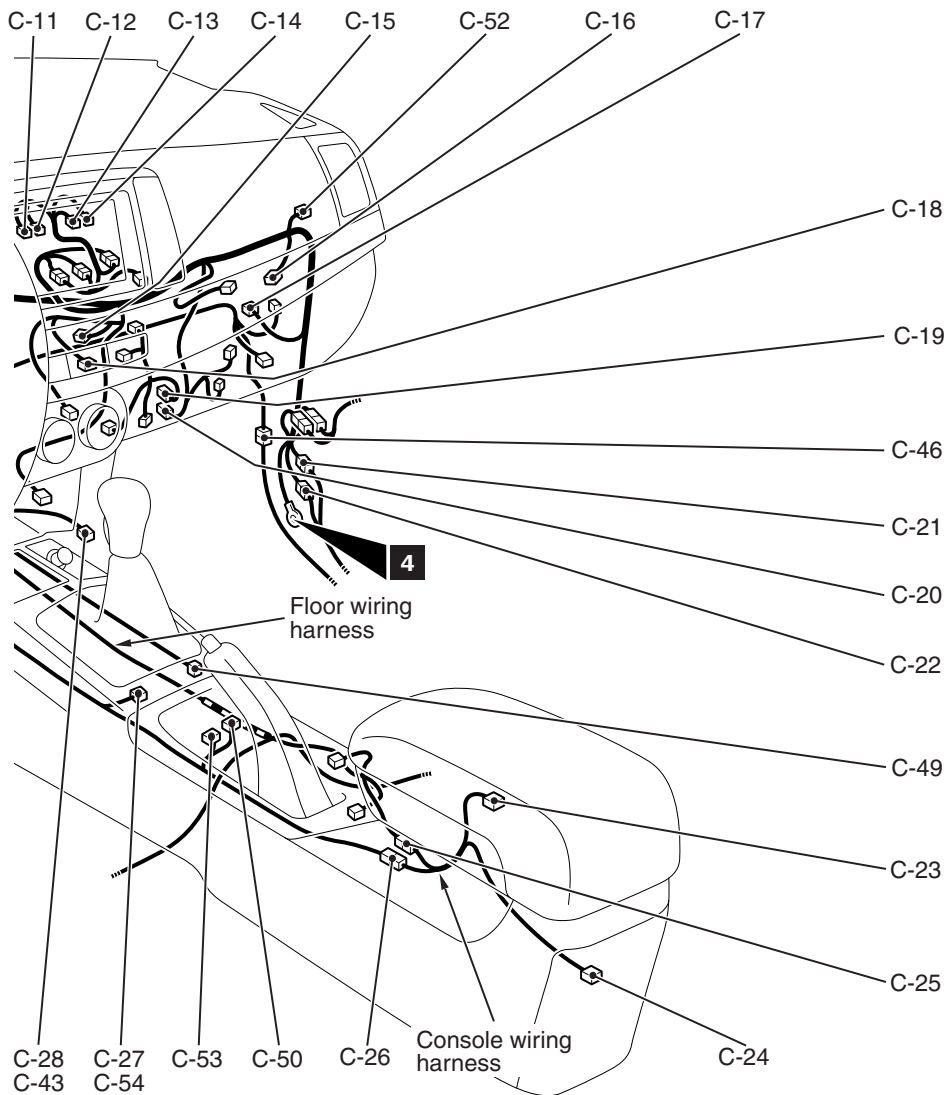

AC807023AB

C-27	(10)	Shift switch assembly <CVT>	C-40	(22)	Transaxle control module <CVT>
C-28	(2)	Accessory socket (front floor console)	C-41	(26)	Transaxle control module <CVT>
C-29	(4-B)	Heated oxygen sensor (rear) <Non-turbo (Vehicles for California emission regulation)>	C-42	(2)	Clutch monitoring switch <M/T>
C-30	(32-Y)	SRS-ECU	C-43	(2)	Cigarette lighter
C-31	(40)	KOS-ECU	C-44	(4-B)	Heated oxygen sensor (front) <Non-turbo (Except vehicles for California emission regulation) and turbo>
C-32	(4)	Stoplight switch	C-45	(6)	ASC off switch
C-33	(2-B)	Knee air bag module (squib)	C-46	(1-GR)	Front wiring harness and ACD power line wiring harness combination
C-34	(16-B)	Data link connector	C-49	(16)	Shift lever <TC-SST>
C-35	(24)	Instrument panel wiring harness and floor wiring harness combination	C-50	(6)	AWC switch <Turbo>
C-36	(20)	Instrument panel wiring harness and floor wiring harness combination	C-51	(26)	AWC-ECU <Turbo>
C-37	(12)	Front wiring harness and floor wiring harness combination	C-52	(24)	Joint connector (6)
C-38	(24)	Joint connector (4)	C-53	(6-L)	No connection
C-39	(22)	Front wiring harness and floor wiring harness combination	C-54	(10)	Shift lever <TC-SST>

DASH PANEL (CONTINUED)

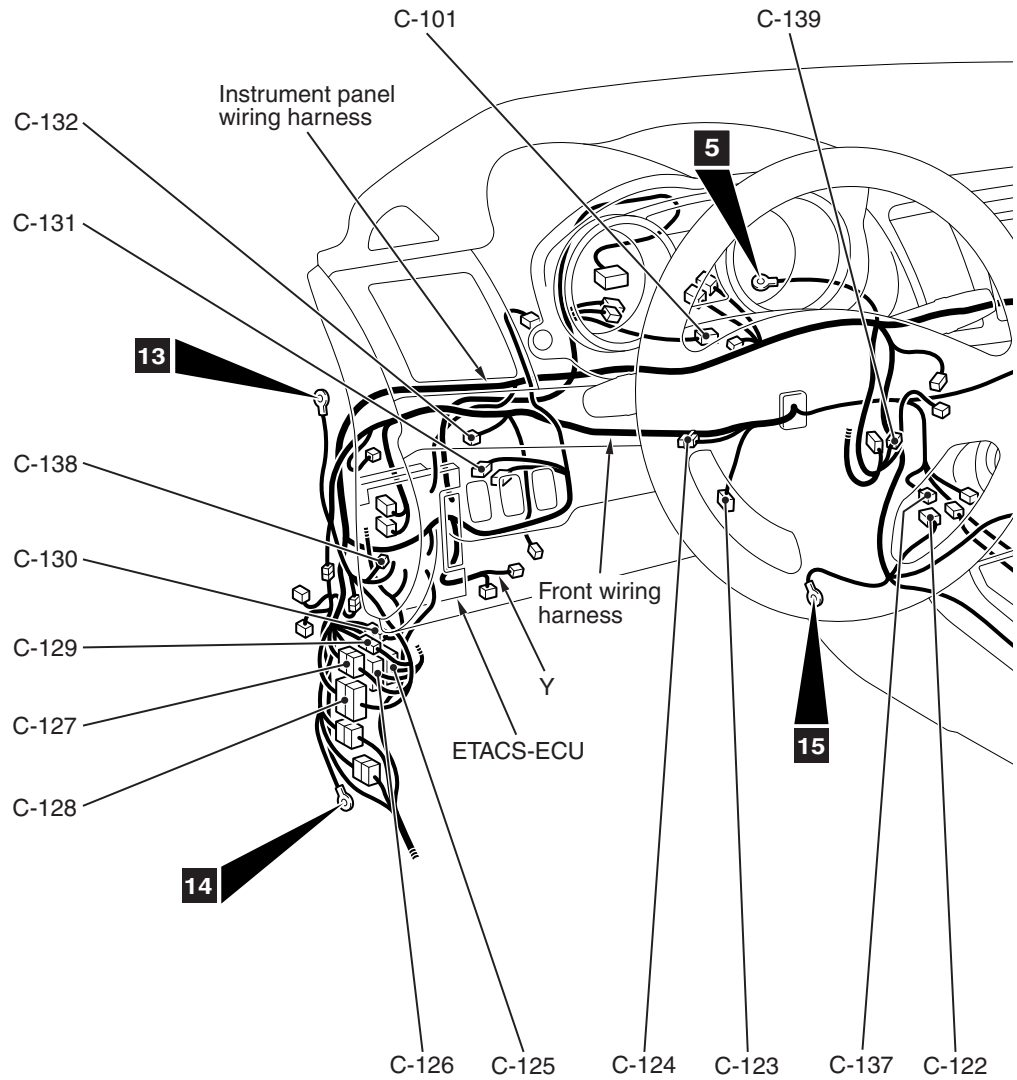
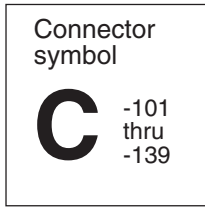

- Connector color code
- B: Black
  - BR: Brown
  - G: Green
  - GR: Gray
  - L: Blue
  - None: Milk white
  - O: Orange
  - R: Red
  - V: Violet
  - Y: Yellow

AC807022AC

C-101 (6)	No connection	C-110 (24)	Hands free module
C-102 (24)	Radio and CD player <Vehicles with audio amplifier>	C-111 (5)	Mode selection damper control motor
C-103 (24)	Instrument panel wiring harness and multivision display wiring harness combination <Vehicles with MMCS>	C-112 (4)	Power transistor
C-104 (20)	Radio and CD player	C-113 (2)	Blower motor
C-105 (20)	Instrument panel wiring harness and multivision display wiring harness combination <Vehicles with MMCS>	C-114 (12)	Instrument panel wiring harness and front door wiring harness (RH) combination
C-106 (18)	Radio and CD player	C-115 (24-BR)	Instrument panel wiring harness and front door wiring harness (RH) combination
C-107 (18)	Instrument panel wiring harness and multivision display wiring harness combination <Vehicles with MMCS>	C-116 (3)	Inside transmission antenna assembly (front)
C-108 (10)	CAN box unit <Vehicles with MMCS>	C-117 (1-B)	Parking brake switch
C-109 (5)	Outside/inside air selection damper control motor	C-118 (5)	Air mixing damper control motor
		C-119 (2)	Fin thermo sensor
		C-120 (12)	A/C control panel

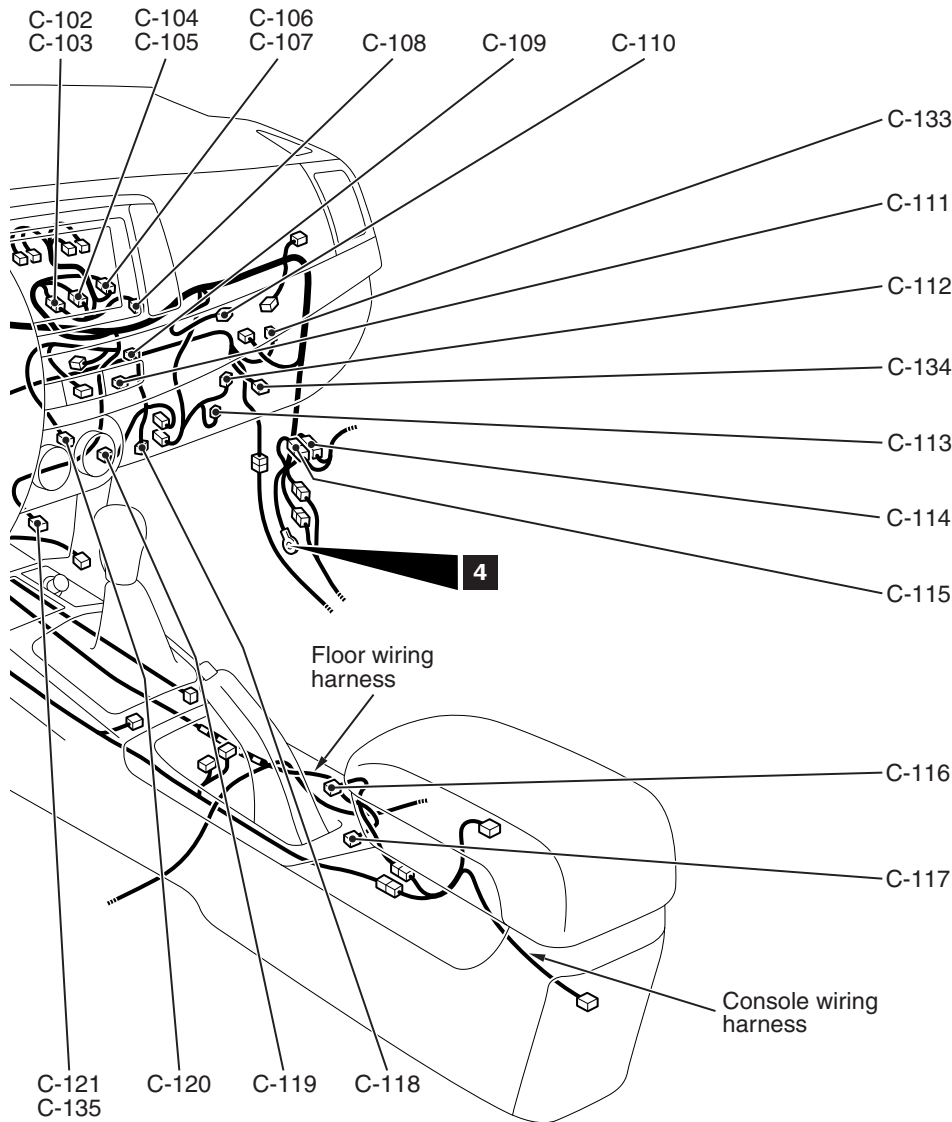

AC807023AC

C-121 (6-B)	Audio and video adapter	C-129 (2)	Instrument panel wiring harness and front wiring harness combination
C-122 (24-Y)	SRS-ECU	C-130 (12)	Instrument panel wiring harness and roof wiring harness combination
C-123 (6-B)	Accelerator pedal position sensor	C-131 (6-GR)	Headlight leveling switch <Vehicles with discharge type headlight>
C-124 (24)	Joint connector (CAN3)	C-132 (2)	Clutch interlock switch <M/T>
C-125 (12)	Instrument panel wiring harness and front door wiring harness (LH) combination	C-133 (10)	No connection
C-126 (24-BR)	Instrument panel wiring harness and front door wiring harness (LH) combination	C-134 (24)	No connection
C-127 (16-BR)	Instrument panel wiring harness and front wiring harness combination	C-135 (6-B)	Audio adapter
C-128 (22)	Instrument panel wiring harness and front wiring harness combination	C-137 (6-B)	G and yaw rate sensor
		C-138 (2)	No connection
		C-139 (20-B)	No connection

DASH PANEL (CONTINUED)

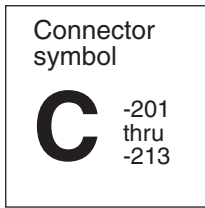

Steering column

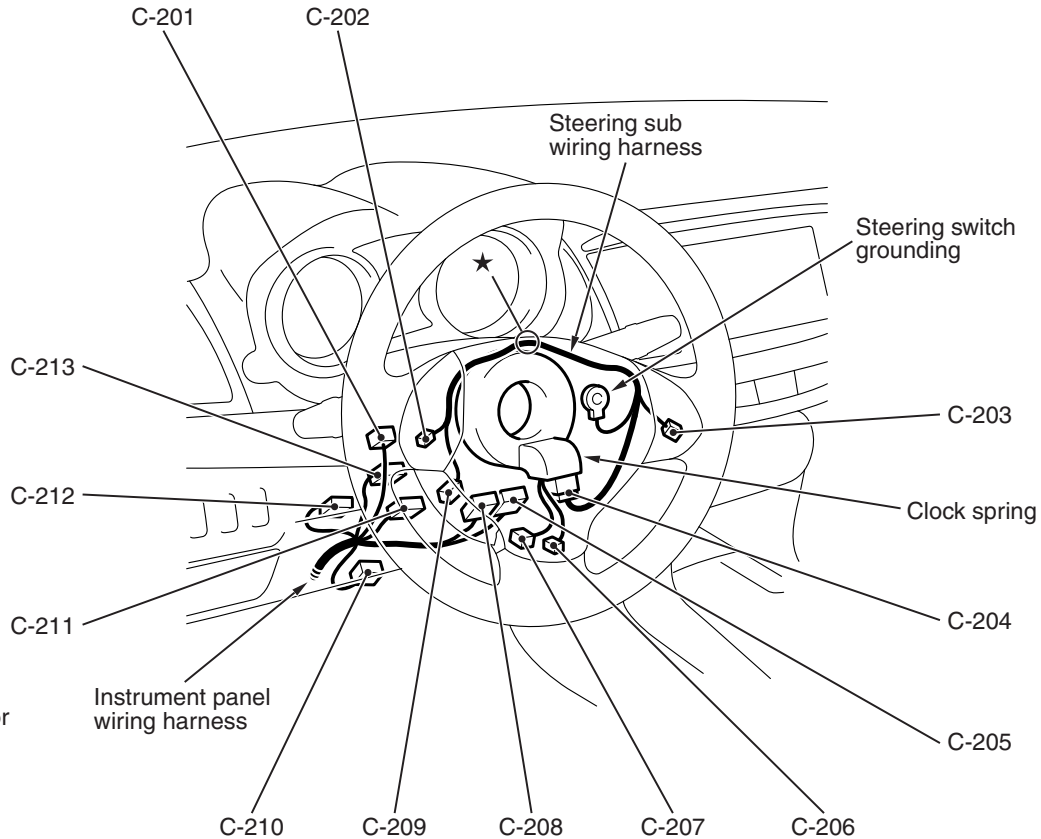

- Connector color code
- B: Black
  - BR: Brown
  - G: Green
  - GR: Gray
  - L: Blue
  - None: Milk white
  - O: Orange
  - R: Red
  - V: Violet
  - Y: Yellow

AC800255AE

C-201 (10)	Column switch	C-207 (4-Y)	Driver's air bag module (squib)
C-202 (5-R)	Steering wheel audio remote control switch	C-208 (4-Y)	Clock spring
C-203 (4-L)	Cruise control switch	C-209 (4-Y)	Steering wheel voice control switch
C-204 (5)	Clock spring and steering sub wiring harness combination	C-210 (3)	Paddle shift switch <Vehicles with sport mode>
C-205 (6)	Clock spring	C-211 (5)	Steering wheel sensor
C-206 (1)	Horn switch	C-212 (6)	Ignition switch
		C-213 (12)	Key reminder switch

DASH PANEL (CONTINUED)

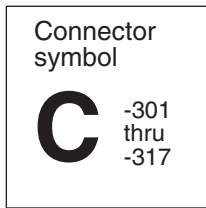

ETACS-ECU

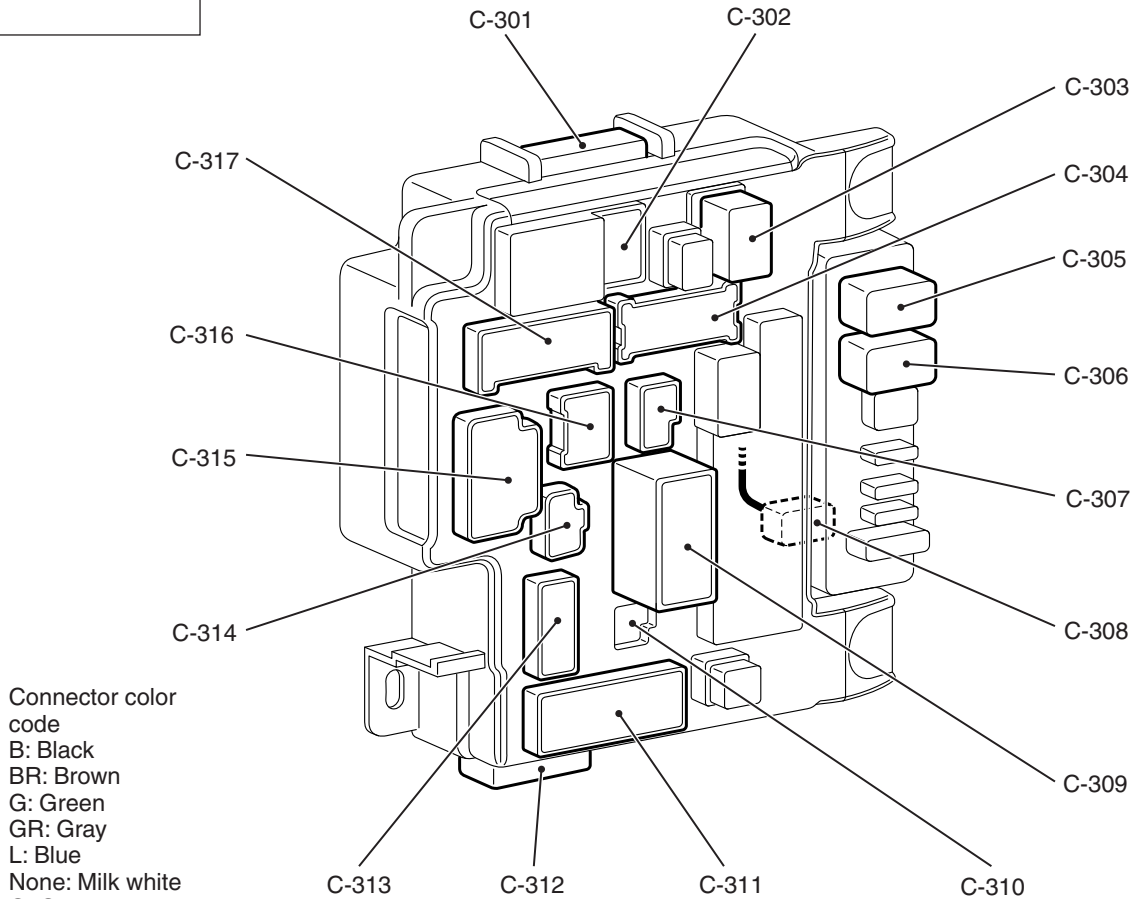

- Connector color code
- B: Black
  - BR: Brown
  - G: Green
  - GR: Gray
  - L: Blue
  - None: Milk white
  - O: Orange
  - R: Red
  - V: Violet
  - Y: Yellow

AC607744AE

C-301 (24)	Instrument panel wiring harness and ETACS-ECU combination	C-311 (20)	Floor wiring harness and ETACS-ECU combination
C-302 (4)	No connection	C-312 (16)	Front wiring harness and ETACS-ECU combination
C-303 (4)	Blower relay	C-313 (16-BR)	Floor wiring harness and ETACS-ECU combination
C-304 (16)	Front wiring harness and ETACS-ECU combination	C-314 (2)	Floor wiring harness and ETACS-ECU combination
C-305 (4)	Heated seat relay	C-315 (19)	Instrument panel wiring harness and ETACS-ECU combination
C-306 (4)	Rear window defogger relay	C-316 (6)	Roof wiring harness and ETACS-ECU combination
C-307 (2-B)	Front wiring harness and ETACS-ECU combination	C-317 (15)	Instrument panel wiring harness and ETACS-ECU combination
C-308 (1-GR)	Instrument panel wiring harness and relay box combination		
C-309 (2-B)	Front wiring harness and ETACS-ECU combination		
C-310 (4)	No connection		



# FLOOR AND ROOF

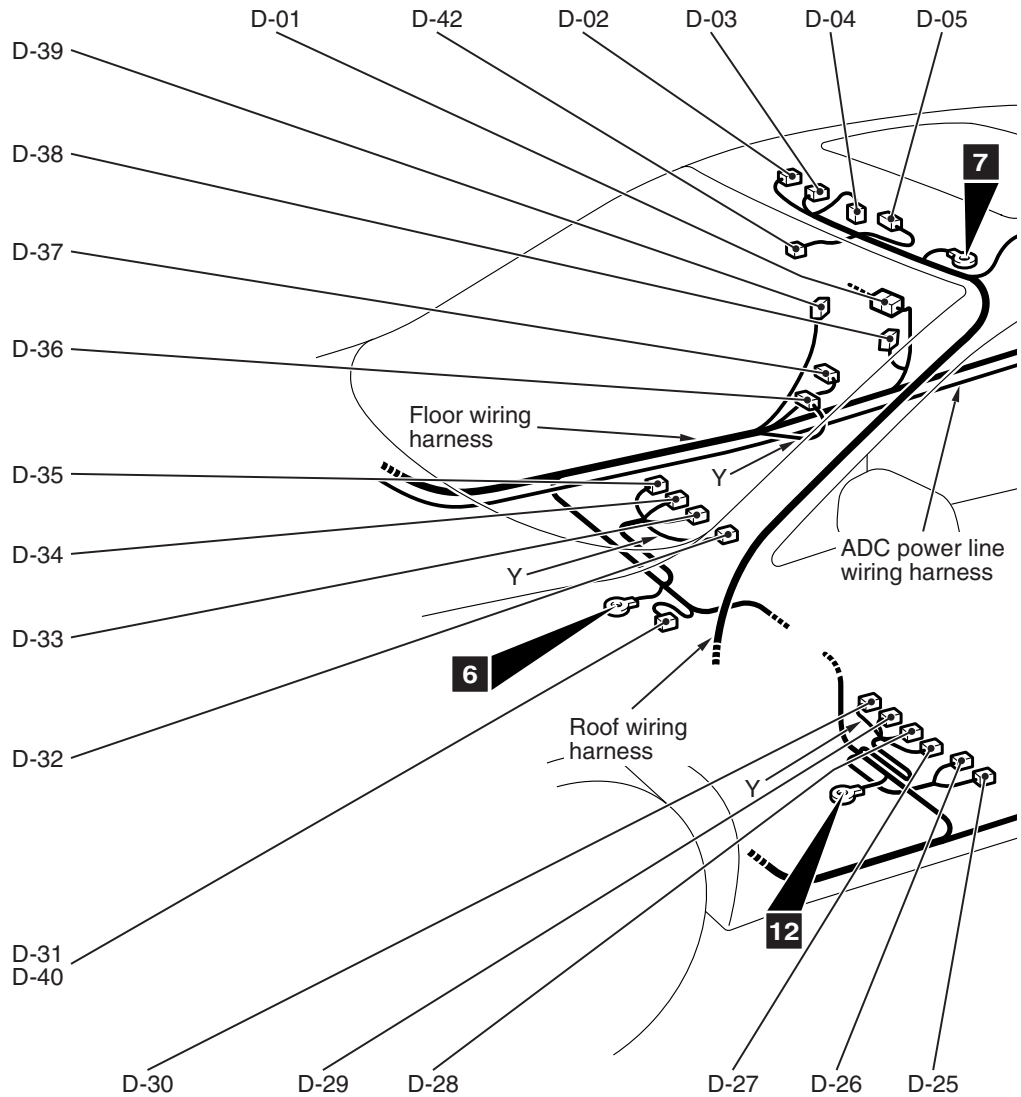
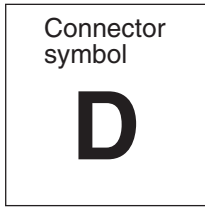

- Connector color code
- B : Black
  - BR : Brown
  - G : Green
  - GR : Gray
  - L : Blue
  - None : Milk white
  - O : Orange
  - R : Red
  - V : Violet
  - Y : Yellow

D-01	(10)	Floor wiring harness and rear door wiring harness (RH) combination
D-02	(3)	Front dome light
D-03	(3)	Microphone unit
D-04	(6-B)	Sunroof switch
D-05	(10-GR)	Sunroof motor assembly
D-06	(2-GR)	Rear dome light <Vehicles without sunroof>
D-07	(3)	Rear door switch (RH)
D-08	(2)	Floor wiring harness and fuel wiring harness combination
D-10	(2-Y)	Floor wiring harness and rear floor wiring harness (RH) combination
D-11	(22)	Floor wiring harness and rear floor wiring harness (RH) combination

D-12	(2-Y)	Floor wiring harness and rear floor wiring harness (LH) combination
D-14	(24-BR)	Floor wiring harness and rear floor wiring harness (LH) combination
D-15	(18)	Floor wiring harness and rear floor wiring harness (LH) combination
D-16	(3)	Rear door switch (LH)
D-17	(3-B)	Fuel tank differential pressure sensor
D-18	(5-GR)	Fuel pump module
D-19	(3)	Outside transmission antenna assembly (Driver's side)
D-20	(10)	Floor wiring harness and rear door wiring harness (LH) combination
D-21	(2-B)	Seat belt pre-tensioner (LH)
D-22	(2-Y)	Side impact sensor (LH)

AC807025AB



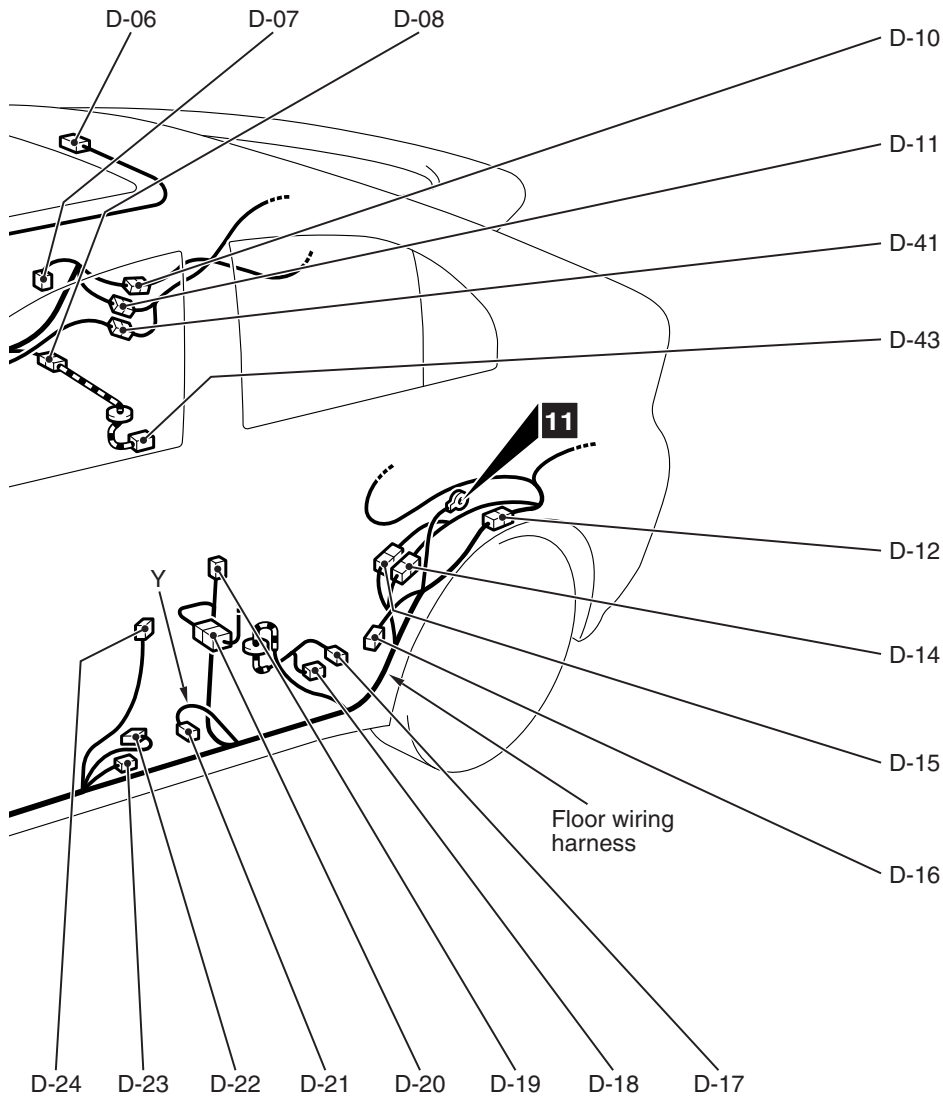

AC807026AB

D-23	(12)	Joint connector (5)	D-37	(2-Y)	Side impact sensor (RH)
D-24	(3)	Front door switch (LH)	D-38	(3)	Outside transmission antenna assembly (Passenger's side)
D-25	(18)	Audio amplifier	D-39	(3)	Front door switch (RH)
D-26	(14)	Audio amplifier	D-40	(4-B)	Heated oxygen sensor (rear) <Non-turbo (Except vehicles for California emission regulation) and turbo>
D-27	(4-B)	Heated seat assembly (LH)	D-41	(1-GR)	ACD power line wiring harness and rear floor wiring harness (RH) combination <Turbo>
D-28	(2-GR)	Seat slide sensor (LH)	D-42	(3)	Lighting control sensor <Vehicles with automatic light>
D-29	(4)	Seat belt switch (Driver's side)	D-43	(2)	Fuel level sensor (sub) <AWD>
D-30	(2-Y)	Side-airbag module (squib) (LH)			
D-31	(4-B)	Heated oxygen sensor (3rd) <Vehicles for California emission regulation>			
D-32	(2-Y)	Side-airbag module (squib) (RH)			
D-33	(2)	Seat belt switch (Passenger's side)			
D-34	(4-B)	Heated seat assembly (RH)			
D-35	(6)	Front seat assembly (RH)			
D-36	(2-B)	Seat belt pre-tensioner (RH)			

DOOR

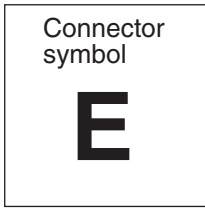

FRONT DOOR

(Driver's side)

(Passenger's side)

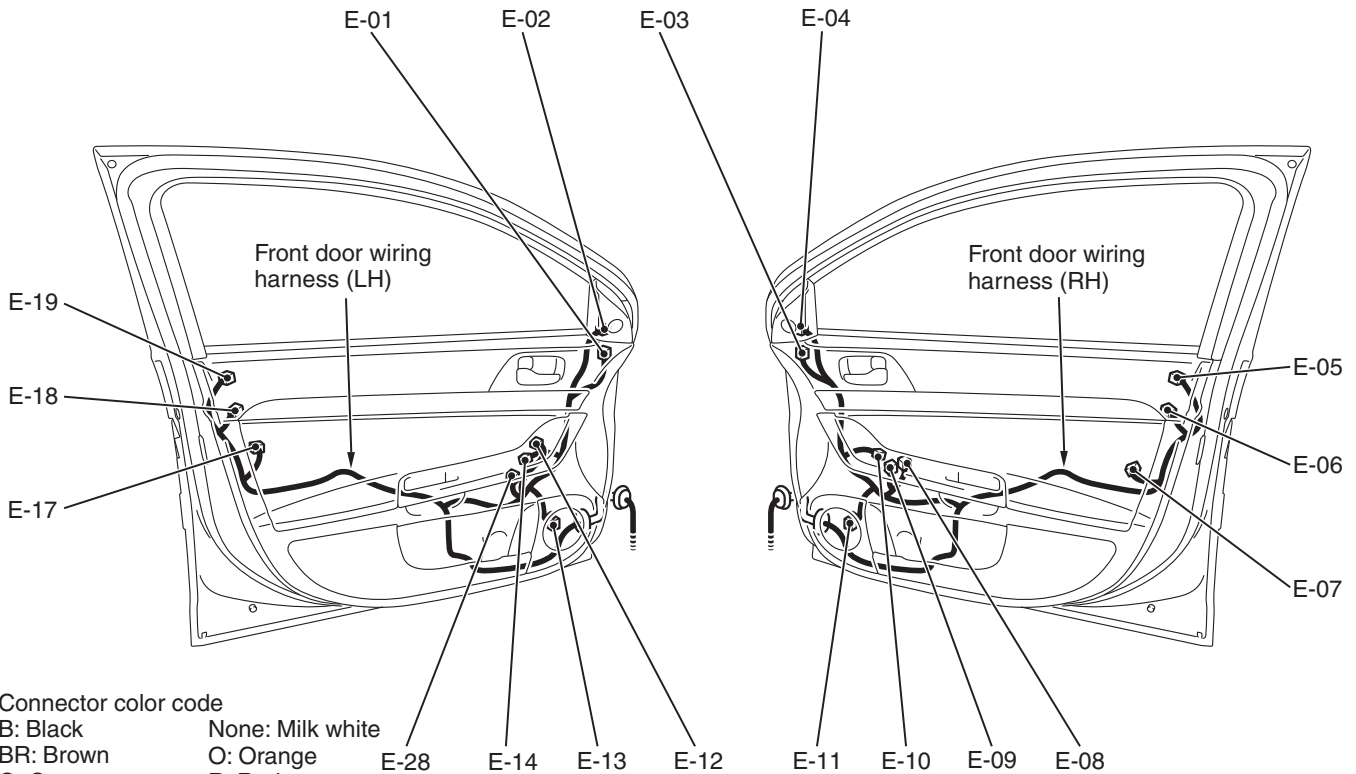

Connector color code

- B: Black
- BR: Brown
- G: Green
- GR: Gray
- L: Blue
- None: Milk white
- O: Orange
- R: Red
- V: Violet
- Y: Yellow

AC605712AE

- |      |        |   |      |        |                                 |
|------|--------|---|------|--------|---------------------------------|
| E-01 | (10)   | Door mirror assembly (LH)                                     | E-08 | (4)    | Front power window sub switch   |
| E-02 | (2-B)  | Tweeter (LH)  | E-09 | (8)    | Front power window sub switch   |
| E-03 | (10)   | Door mirror assembly (RH)                                     | E-10 | (6-GR) | Front power window motor (RH)   |
| E-04 | (2-B)  | Tweeter (RH)  | E-11 | (2)    | Front door speaker (RH)         |
| E-05 | (6)    | Unlock sensor (front passenger's side)<br><Vehicles with KOS> | E-12 | (11-L) | Remote controlled mirror switch |
| E-06 | (2-GR) | Lock switch (front passenger's side)<br><Vehicles with KOS>   | E-13 | (2)    | Front door speaker (LH)         |
| E-07 | (6-B)  | Front door lock actuator (RH)                                 | E-14 | (6-GR) | Front power window motor (LH)   |

REAR DOOR

(LH)

(RH)

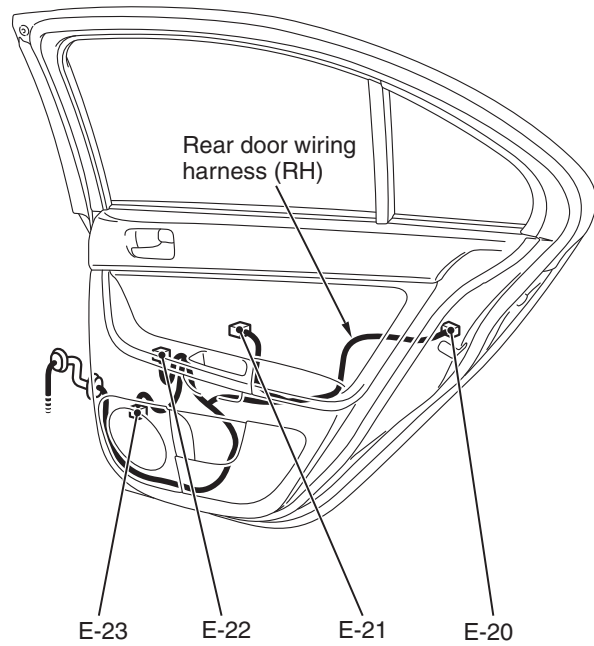
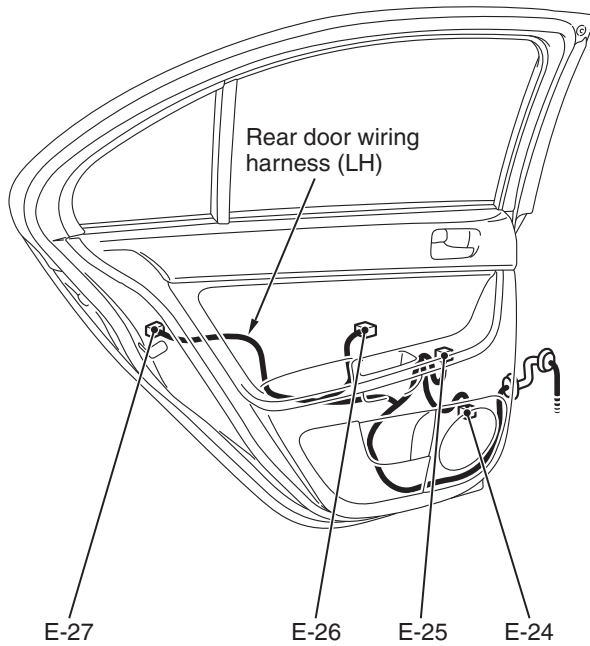

AC605713AH

- E-17 (6-B) Front door lock actuator (LH)
- E-18 (2-GR) Lock switch (driver's side) <Vehicles with KOS>
- E-19 (6) Unlock sensor (driver's side) <Vehicles with KOS>
- E-20 (6-B) Rear door lock actuator (RH)
- E-21 (6-GR) Rear power window motor (RH)

- E-22 (8) Rear power window sub switch (RH)
- E-23 (2) Rear door speaker (RH)
- E-24 (2) Rear door speaker (LH)
- E-25 (8) Rear power window sub switch (LH)
- E-26 (6-GR) Rear power window motor (LH)
- E-27 (6-B) Rear door lock actuator (LH)
- E-28 (19) Power window main switch

LIFTGATE

M1801001901259

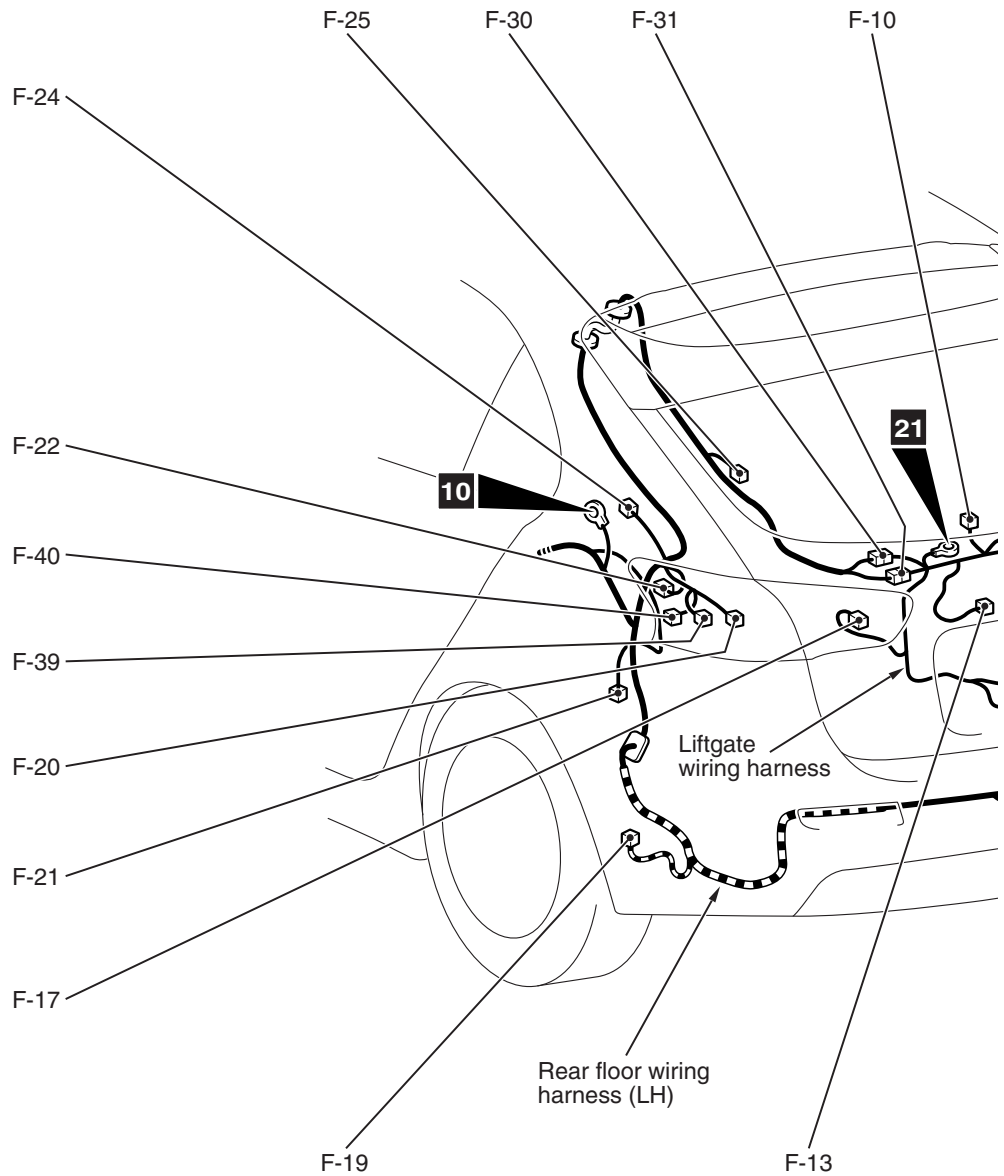
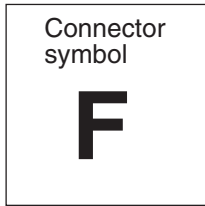

- Connector color code
- B: Black
  - BR: Brown
  - G: Green
  - GR: Gray
  - L: Blue
  - None: Milk white
  - O: Orange
  - R: Red
  - V: Violet
  - Y: Yellow

AC807028AB

F-01	(3)	Luggage compartment light	F-14	(2-GR)	Outer tone alarm <Vehicles with KOS>
F-02	(2-B)	Rear wheel speed sensor (RH)	F-16	(3-GR)	Outside transmission antenna assembly (liftgate) <Vehicles with KOS>
F-03	(3)	Inside transmission antenna assembly (Rear: passenger's side)	F-17	(2-GR)	Backup light (LH)
F-04	(1-B)	Rear window defogger (-)	F-19	(2-GR)	Evaporative emission ventilation solenoid
F-05	(2-B)	Curtain air bag module (squib) (RH)	F-20	(3)	Rear combination light (LH)
F-06	(3)	Rear combination light (RH)	F-21	(2-B)	Rear wheel speed sensor (LH)
F-08	(2-GR)	Backup light (RH)	F-22	(4-B)	Sub woofer
F-10	(2)	High-mounted stoplight	F-24	(2-B)	Curtain air bag module (squib) (LH)
F-11	(2)	License plate light (RH)			
F-13	(2)	License plate light (LH)			

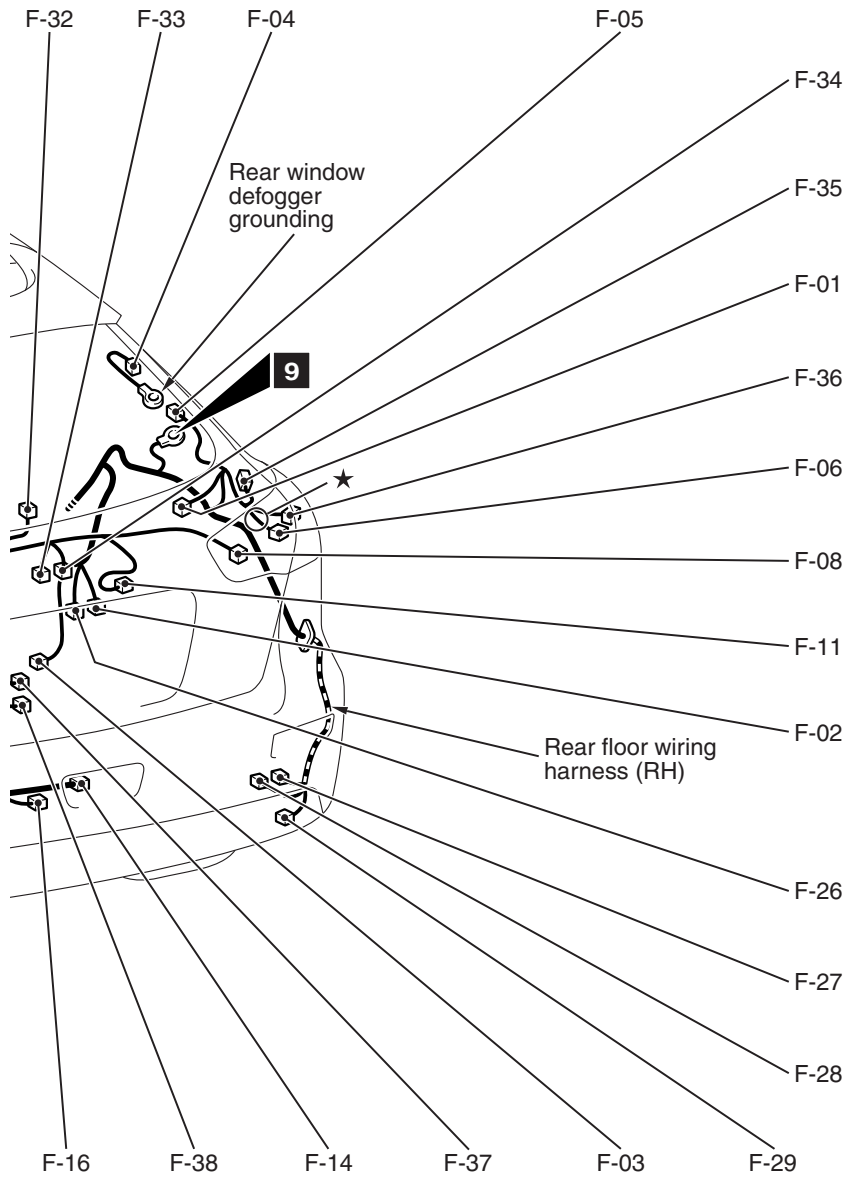

AC807029AB

F-25	(1-B)	Rear window defogger (+)	F-33	(2)	Liftgate lock release handle
F-26	(3)	No connection	F-34	(2)	Lock switch (liftgate) <Vehicles with KOS>
F-27	(3-B)	Pressure sensor <Turbo>	F-35	(2-B)	Rear side marker light (RH)
F-28	(3-B)	Proportioning valve (for ACD control) <Turbo>	F-36	(2)	Rear turn-signal light (RH)
F-29	(2-GR)	Electric pump <Turbo>	F-37	(2)	Liftgate switch
F-30	(16)	Rear floor wiring harness (LH) and liftgate wiring harness combination	F-38	(2-B)	Liftgate lock actuator
F-31	(8)	Rear floor wiring harness (LH) and liftgate wiring harness combination	F-39	(2)	Rear turn-signal light (LH)
F-32	(4)	Rear wiper motor	F-40	(2-B)	Rear side marker light (LH)

---

## NOTES