GROUP 34

REAR SUSPENSION

CONTENTS

GENERAL INFORMATION 34-2

GENERAL INFORMATION

M2340000101345

The rear suspension has the following features:

- The trailing arm type multi-link suspension is adopted.
- The wheel tread is increased to improve cornering ability.
- The roll center height is modified to improve the steering ability.
- A double crossmember is adopted and the upper arm, lower arm, control link are joined to the crossmember to improve suspension alignment accuracy and maintenance performance.
- Improvement of arms installation accuracy eliminates the camber adjustment to improve maintenance performance.
- The trailing arm bushings are installed in the upper position to improve the movement of the suspension when the vehicle negotiates bumps and increase riding comfort.
- Twin tube type shock absorber is adopted to secure optimum rolling rigidity and improve the steering ability.
- Stabilizer bar is adopted to improve steering ability.
- The control link is installed in the lower position to increase toe and camber rigidity and improve steering ability.

CONSTRUCTION DIAGRAM

<FWD>

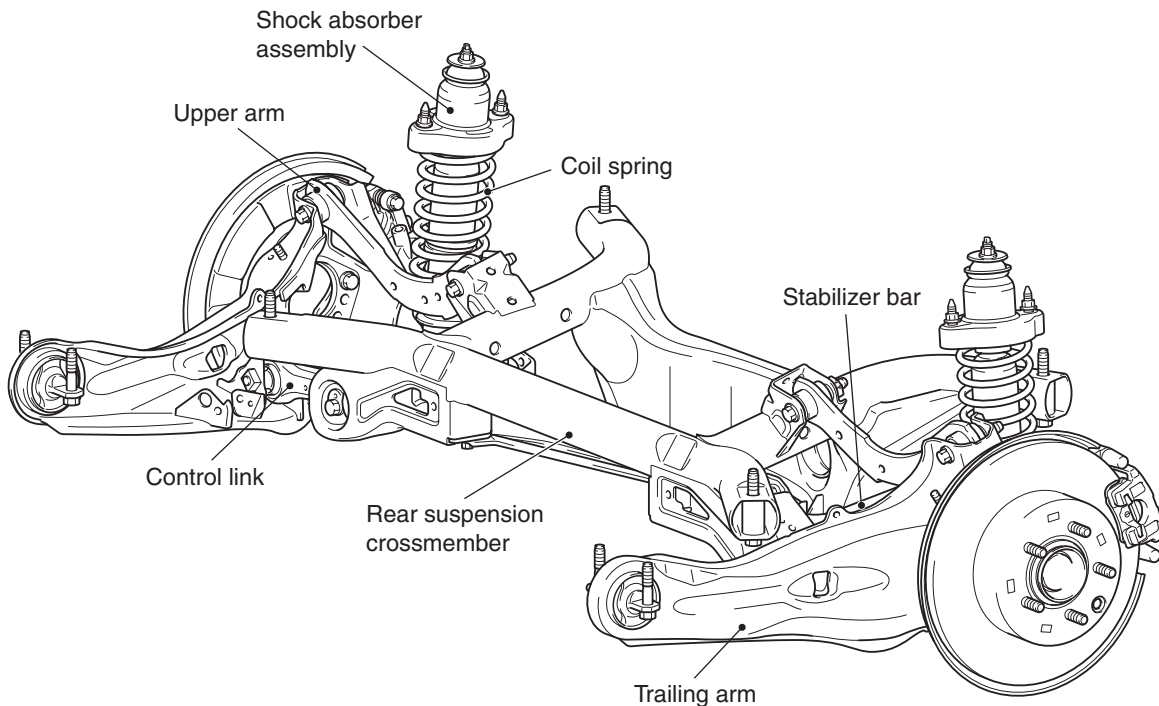

AC612938 AD

<AWD>

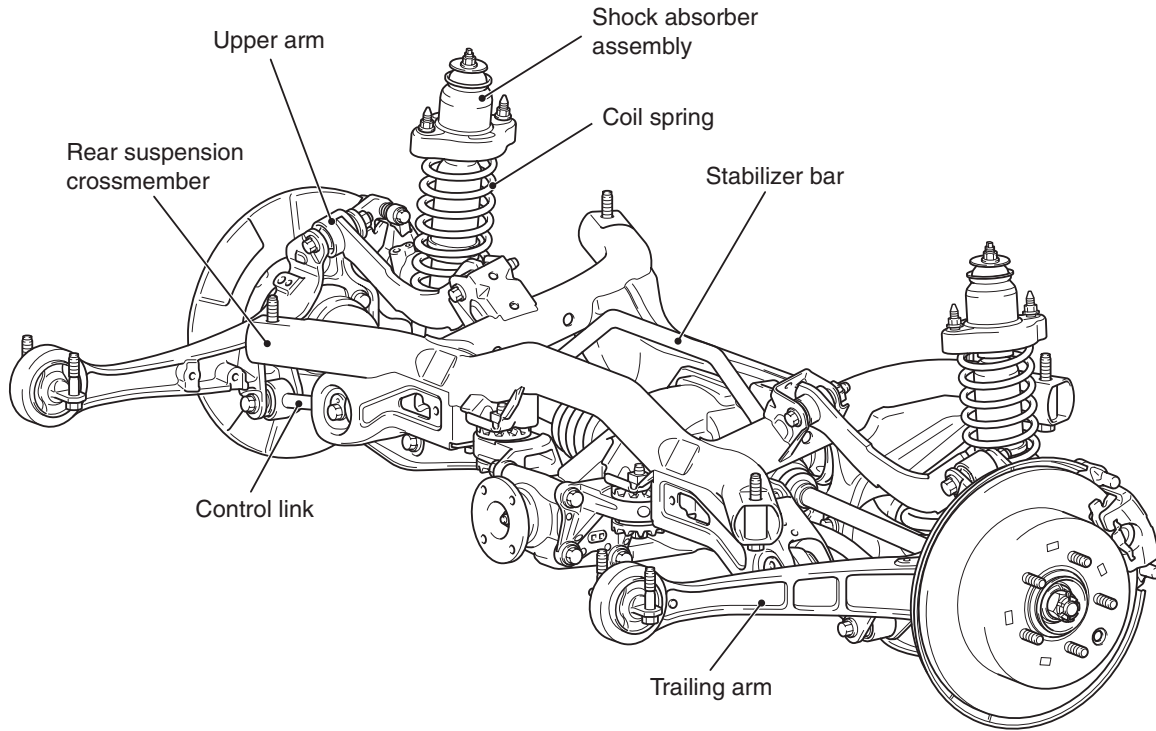

AC712227AE

SPECIFICATIONS

SUSPENSION SYSTEM

Item	Specification
Suspension type	Trailing arm type multi-link

WHEEL ALIGNMENT

Item	Specification
Camber	-0° 55'
Toe in mm (in)	3 ± 2 (0.12 ± 0.08)

COIL SPRING

Item	FWD	AWD
Wire diameter mm (in)	10 (0.4)	11 (0.4)
Mean diameter of coil mm (in)	90 (3.5)	91 (3.6)
Free length mm (in)	368 (14.5)	349 (13.7)

NOTES