GROUP 32

**POWER PLANT
MOUNT**

CONTENTS

GENERAL INFORMATION 32-2

GENERAL INFORMATION

M2320000101398

To support the power plant, the inertial axis four-point mount system has been adopted. The system has the following features:

- Environmental-load substances are totally abolished for hexavalent chromium-free and lead-free components.
- For the engine and transaxle mounting insulator, the cylindrical liquid seal mountings are adopted. This reduces idling vibration and acceleration noise, and improves riding comfort.
- For the engine mounting bracket, lightweight and high rigidity aluminum has been adopted to reduce acceleration noise.
- For the transaxle mounting bracket, lightweight and high rigidity aluminum has been adopted to reduce acceleration noise. <2.0L ENGINE>
- For the transaxle mounting bracket, lightweight and high rigidity sheet metal has been adopted to reduce the gear noise. <2.4L ENGINE>
- The mass damper is added into the centermember to reduce muffled sound during acceleration. <2.0L ENGINE>
- The front axle crossmember has been fully flattened to improve steering ability.
- The front axle crossmember bar is added to enhance rigidity. aluminum has been adopted to reduce acceleration noise. <2.0L ENGINE>

CONSTRUCTION DIAGRAM

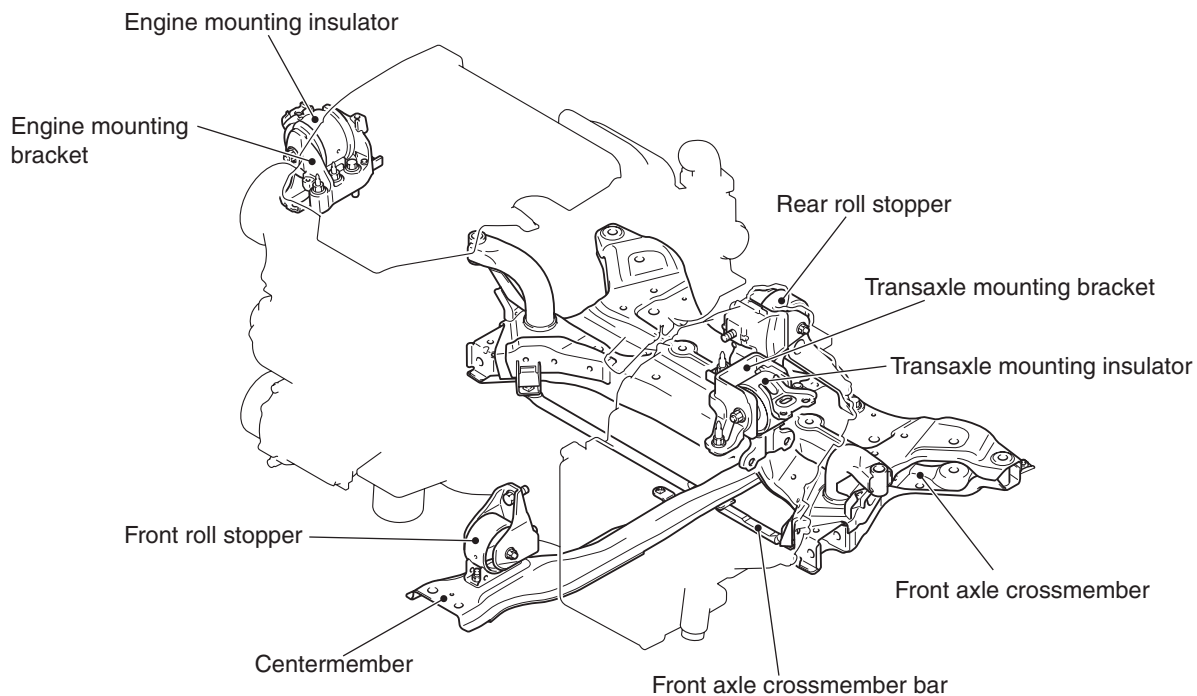

AC800719AD