

GROUP 52A

INTERIOR

CONTENTS

GENERAL INFORMATION	52A-2	SEAT BELT	52A-8
INSTRUMENT PANEL AND FLOOR CONSOLE	52A-3	TRIMS	52A-10
SEAT	52A-5	INTERIOR TRIM	52A-10
FRONT SEAT	52A-5	DOOR TRIM	52A-11
REAR SEAT	52A-7	LUGGAGE ROOM	52A-12
		HEADLINING	52A-13

GENERAL INFORMATION

M2520000101314

Functionality, interior comfort, and safety have been emphasized, giving interior design for elegance and relaxation space. Various measures have been taken actively to protect the environment and recycle resources.

FEATURES**Quality improvement**

1. Two-tone interior
2. Full interior trim

Usability improvement

1. Armrest (floor console, rear seat, front door trim, rear door trim)
2. Cup holder (floor console, rear seat armrest)
3. Bottle holder (front door trim)

Convenient boxes

1. Glove box
2. Seatback pocket (passenger's seat)
3. Card holder (glove box)
4. Tissue paper holder (floor console)
5. Floor console box
6. Door pocket (front door trim, rear door trim)

Safety improvement

1. Front and rear collision protection seat mechanism (front seat)

2. ISO-FIX lower anchor (rear seat outside)
3. Upper tether anchor (rear seatback [back side])
4. ELR 3-point seat belt (driver's seat)
5. ELR/ALR 3-point seat belt (passenger's seat, rear seat)
6. Seat belt retractor with a driver's side pretensioner and force limiter
7. Seat belt retractor with a passenger's side pretensioner and force limiter
8. Headlining energy absorption box <Vehicles with sun roof>

Consideration for the optimum driving position

1. Seat height adjustment (driver's seat)
2. Headrest with height adjustment (front seat, rear seat)
3. Seat slide adjustment (front seat)

Measures for resource recycling

1. Aggressively use PP materials that are easy to recycle and easy to stamp material symbols on the plastic (resin) parts.
2. Reduction of chemical material (formaldehyde*, organic solvent)

*NOTE: *: Clear and colorless, toxic, irritating odor*

INSTRUMENT PANEL AND FLOOR CONSOLE

M2520001001387

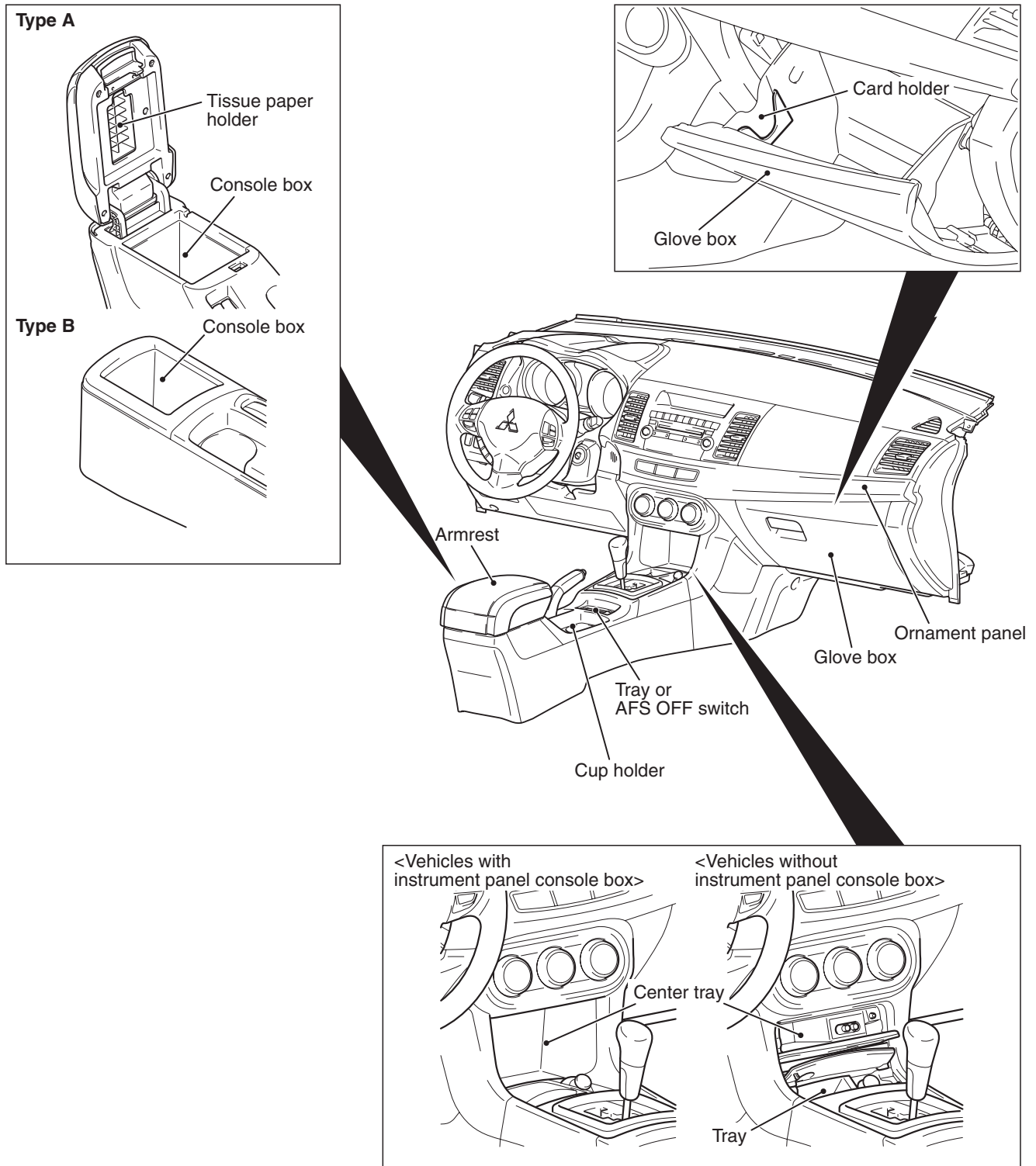

AC901821AB

The instrument panel offers the following features:

- The instrument panel is two-toned.
- The division unit of each part has been enlarged, also the gap and level difference between the instrument panel has been minimized to achieve the delicate quality.
- The decorated panel creating uniformity from the instrument panel to the door trim has been adopted.
- The holder in which two cards can be stored has been installed in the glove box.

- The glove box with damper function has been installed.
- The center tray for storing small items has been installed in front of the selector or shift lever center panel.
- The cup holder which can hold two bottles has been equipped. The cup holder can store two CDs in the upright position and pen-size long items horizontally.
- A large box that can store 10 CDs has been installed under the armrest. (With ACC: 6 CDs, Type-B: 9 CDs)
- A tray that can store cigarettes and lighters has been equipped.
- The synthetic cloth is used for the arm rest lid to enhance luxury and soft feelings.

SEAT

FRONT SEAT

M2520004001290

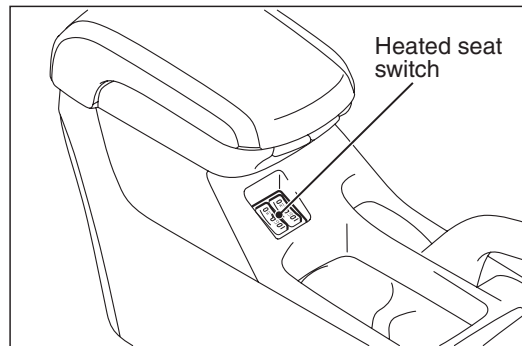
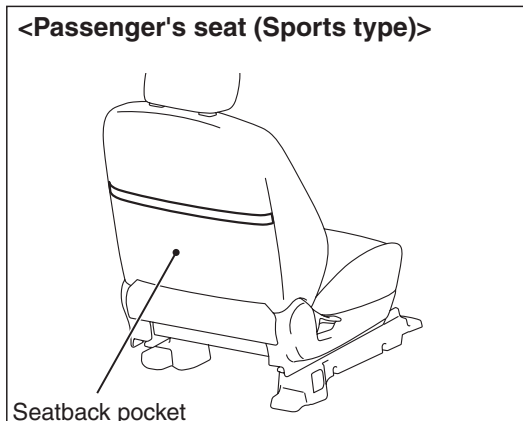
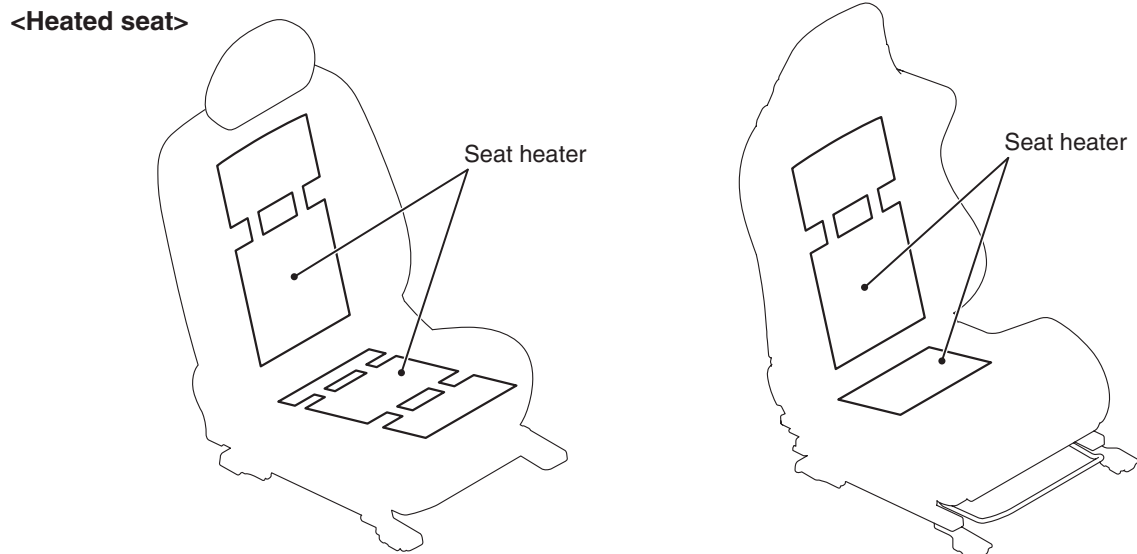
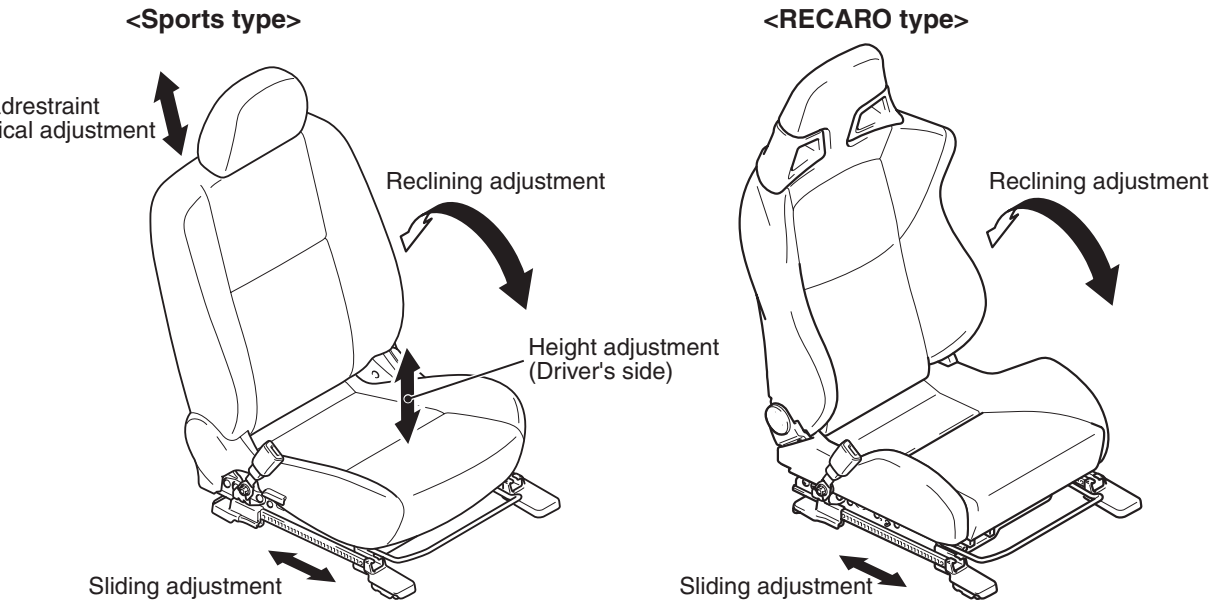

AC801968AB

The front seat offers the following features:

- The seats are designed to be adjustable in the reclining and sliding directions.
- Headrests with a vertical adjustment mechanism have been adopted.

- The seat height adjustment function has been introduced to the driver's seat. This function raises and lowers the seat cushion together with the seatback, thus the driver's waist position in relation to the seatback is always kept constant, resulting in the improved riding comfort. By expanding the height adjustment amount up to 45 mm, the more optimized driving position can be adjusted. The pump type seat height adjustment lever has been adopted for convenient use.
- The passenger's seat have seatback pockets for easier use.
- The frontal and rear-end collision protection seat structure (backward layout of seatback frame and optimization of headrest position) has been adopted to improve safety during a collision at lower vehicle speed. The cross frame has been installed below the seat cushion to reduce the forward travel distance of the passengers during a frontal collision and has improved safety.
- Heated seats are available for the driver's and passenger's seats. <Vehicles with heated seat>
- The genuine leather for the seat has been upgraded to enhance the texture and luxury feeling. <Vehicles with leather type>
- Genuine and synthetic leather seat is available for the RECARO seat as an option. The genuine leather is used to the side sections and the synthetic leather is used to the main section of the genuine and synthetic leather seat, enhancing the texture and luxury with an addition of double stitching. A separate material is added to the shoulder and thigh sections to receive the lateral G during cornering, ensuring the support function and improving the functionality. <option>
- With the RECARO seat, pads of seating surface, side section, and upper back are separated to support the body with the whole seatback, securing an excellent support performance and further enhancing the balance with usefulness.<RECARO type>

SPECIFICATIONS FOR HEATED SEAT

Item		Specification
Energy consumption W	HIGH	61 ± 6.1
	LOW	16 ± 1.6
Thermostat ° C	ON → OFF	40 ± 4
	OFF → ON	30 ± 5

REAR SEAT

M2520007000809

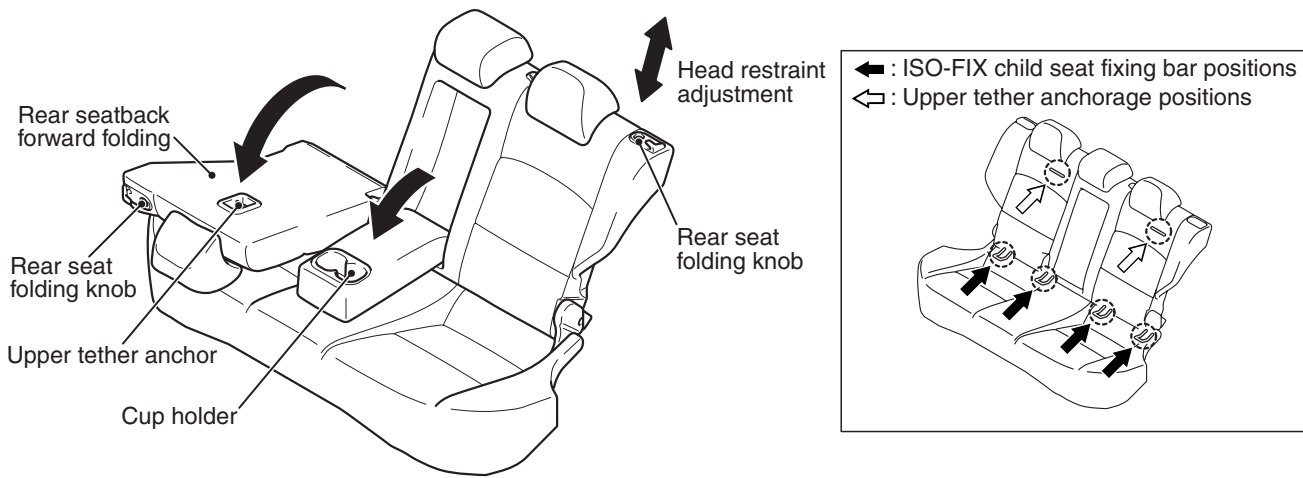

AC801415AB

A low-back bench seat is used for rear seat. The rear seat offer the following advantages:

- The center armrest has a cup holder.
- The ISO-FIX child seat fixing bar is installed on the body side, and the upper tether anchor is installed to the back side of the seatback as standard equipment to all the seats, improving the versatility of child seat installation.
- A 6:4 split rear seat has been adopted. When the rear seat folding knob is pressed, the seatback folds forward and the passenger compartment and the luggage compartment become one. As a result, larger luggage can be stored.

SEAT BELT

M2520010000973

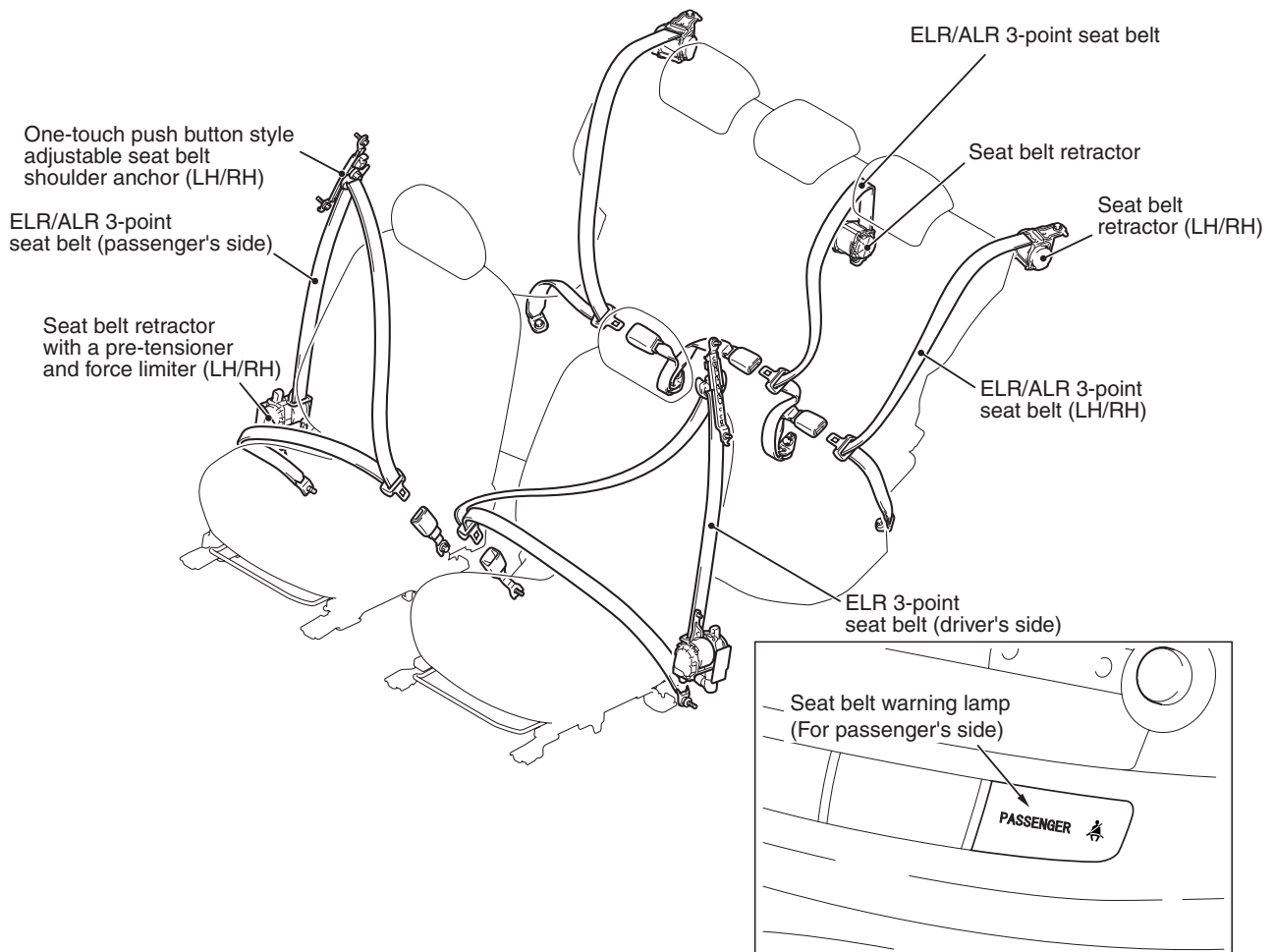
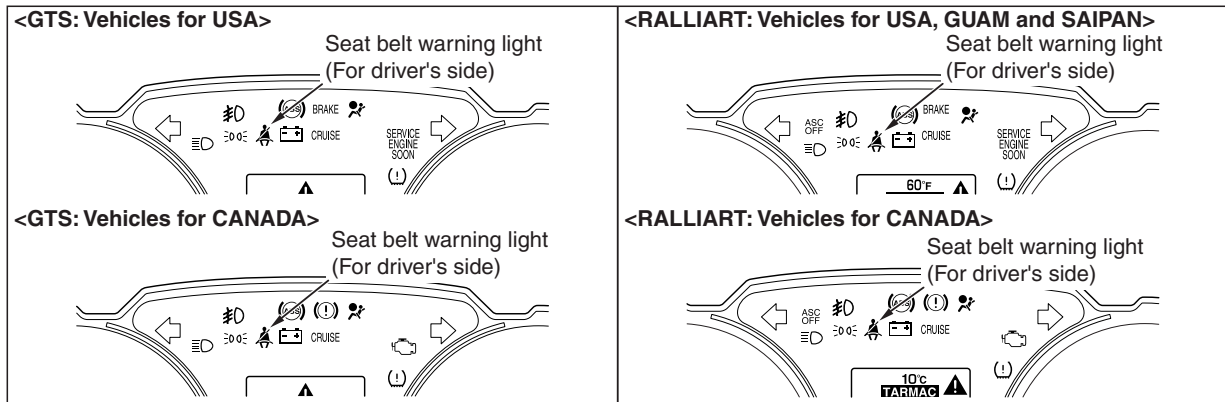

AC807596AC

The seat belts offer the following features:

FRONT SEAT BELT

- An ELR 3-point seat belt (driver's side) is used., passenger's side.
- An ELR/ALR 3-point seat belt (passenger's side) is used.
- One-touch push button style adjustable seat belt shoulder anchor and retractable buckle provide the most suitable belt fitting.

- The seat belt retractor with the force limiter for the driver's seat and the front passenger's seat increase safety.
- A seat belt warning light is installed to the driver's and passenger's seat.

<Rear seat belt>

- ELR/ALR 3-point seat belts (LH/RH/Center) have been installed.

Seat belt with variable force limiter

The driver's/ passenger's seat belt retractor has been equipped with a force limiter. The force limiter is a device which operates when a predetermined force is applied, and limits the force.

OPERATION

1. If a collision energy is transmitted to the seat belt, the ELR mechanism will operate to lock the seat belt.
2. If the energy increases to a predetermined value, the torsion bar will be distorted. As the spindle rotates together with the torsion bar, the seat belt webbing is pulled out, reducing the impact to the occupants.

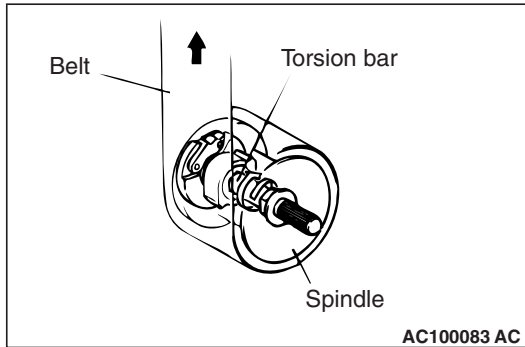

TRIMS

INTERIOR TRIM

M2520012000775

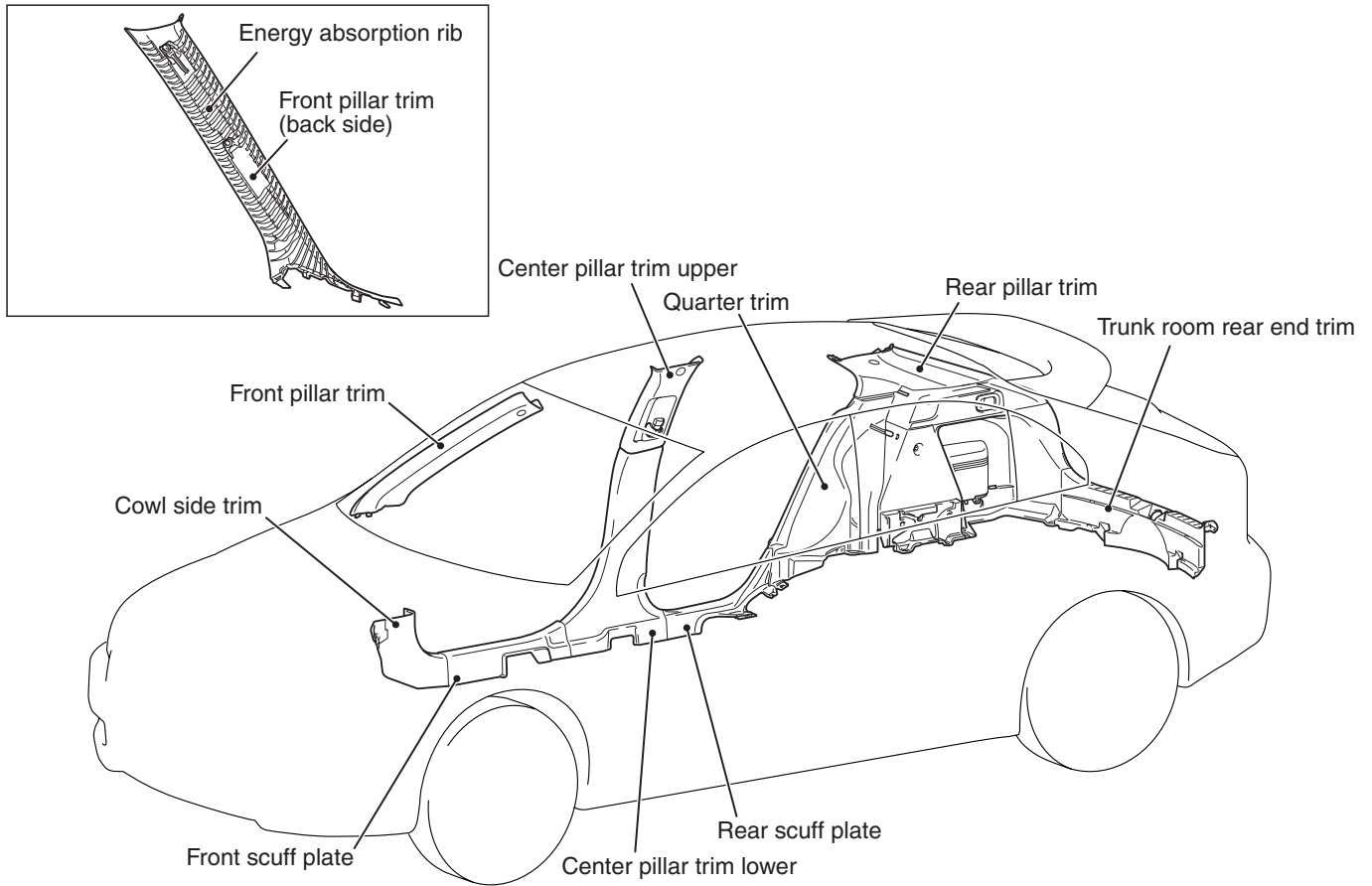

AC802045AB

- The interiors are fully covered by trims.
- The energy absorption rib molding located in the back side of the front pillar trim protect head from side impacts and the resin materials for the trims are unbreakable materials.
- Use of nonflammable materials for the trims has increased safety as outstanding interiors. Also, material codes are indicated to deal with recycling easily.

DOOR TRIM

M2520012300624

<Front door trim>

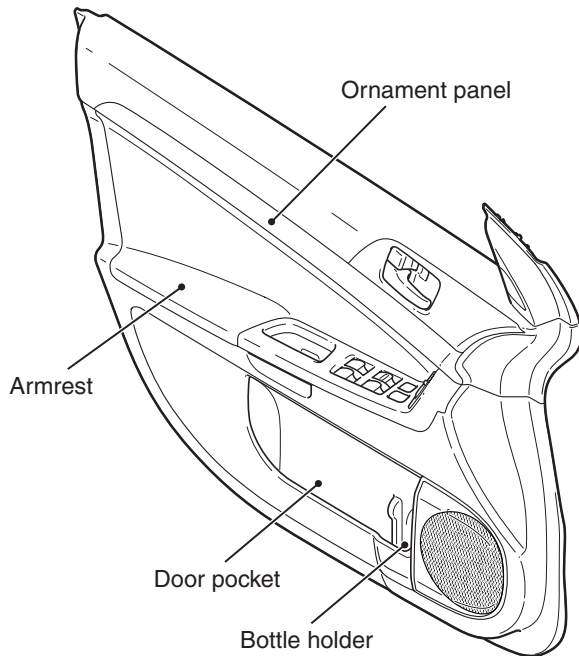

<Rear door trim>

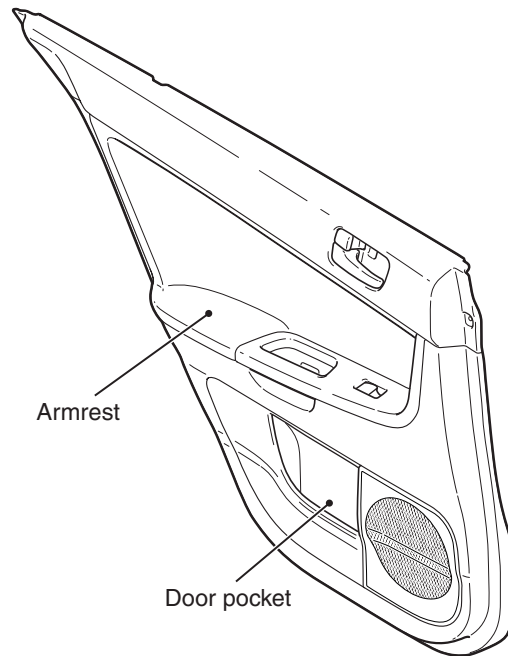

AC613150AB

The door trims offer the following features.

- Break-proof resin material has been used for trim panels, improving safety.
- Bottle holders which can store a 500-ml plastic bottle have been installed to the front door trim and rear door trim to improve convenience. Also, the bottle holding capability has been improved to accommodate bottles with shapes that are difficult to keep upright.
- Door pockets have been installed to the front and rear door trim panels. The front door pockets have a large capacity that can hold A4-size maps. The rear door pockets which are also used as bottle holders can also store the headset for the rear monitor.
- For the armrests, the energy absorbing structure has been adopted which reduces the mid section injuries to passengers by collapsing. Also, with one-piece forming of the cloth with a soft layer added, the quality has been improved.

LUGGAGE ROOM

M2520013000381

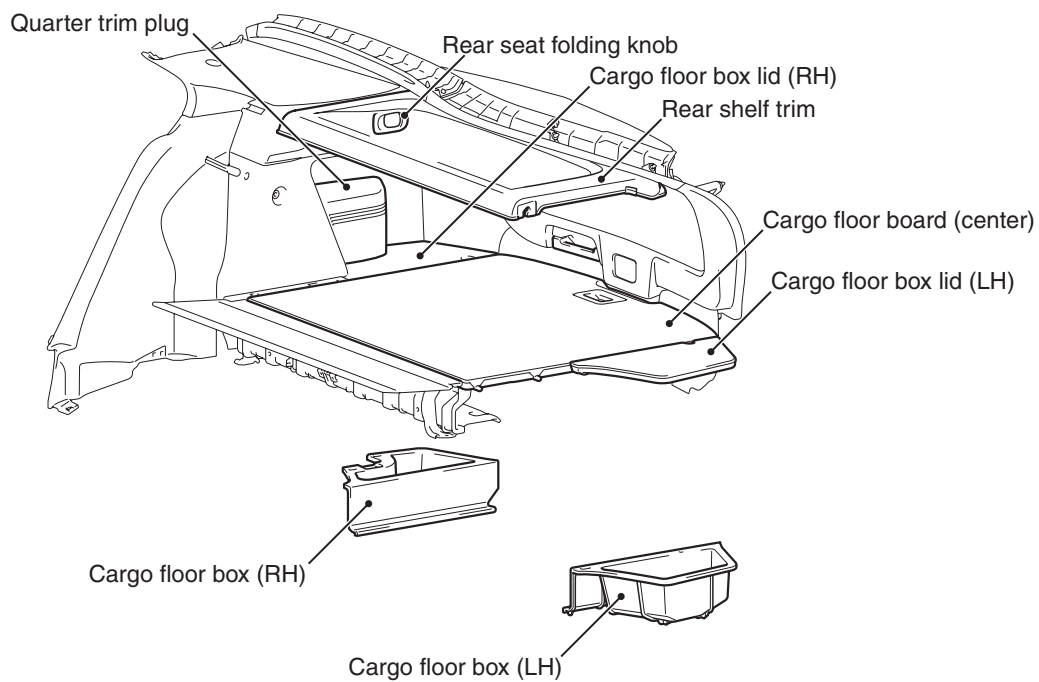

AC808245AB

- The rear seat folding knob has been installed. By pulling the knob, a large luggage room can be created.
- The Cargo floor box has been equipped to improve usability. <LH: Vehicles without rear speaker box assembly>

HEADLINING

M2520014000492

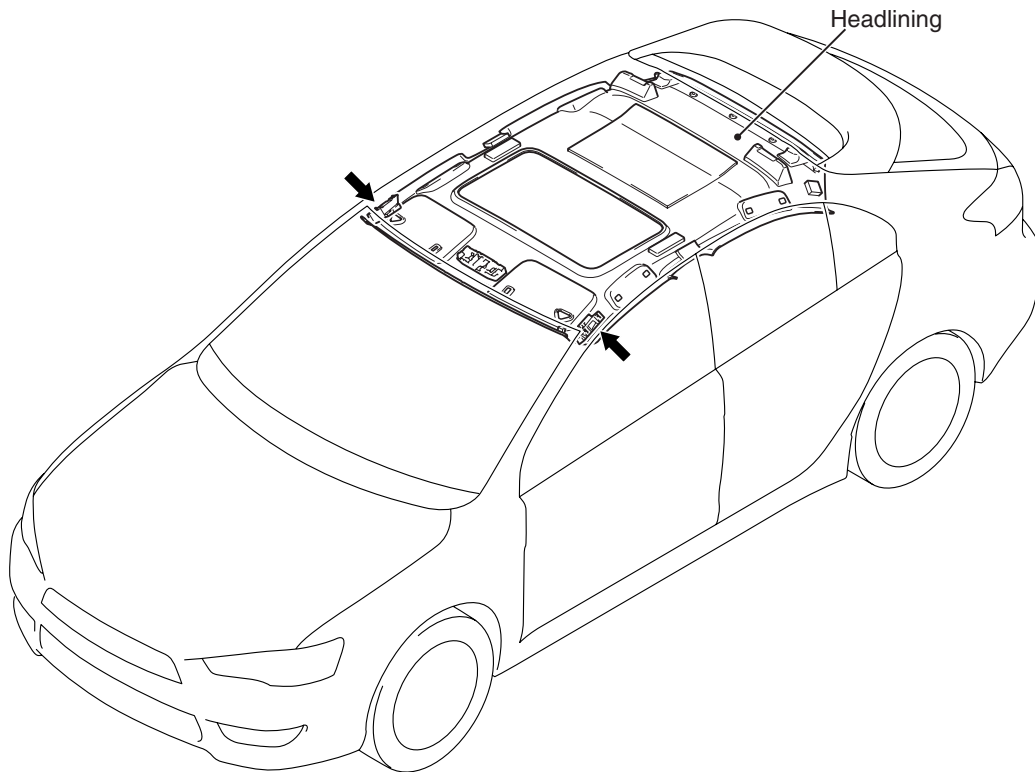

NOTE

← : Energy absorption box positions

Interior design with safe material has been adopted, achieving more safe and comfortable interior.

AC807599AB

- Energy absorption box have been adopted to the inside of headlining. This reduces head injuries upon the secondary impact against the cabin during a collision, and improves safety. <Vehicles with sun roof>

NOTES